

Height	1000.0 mm
Width	1132.0 mm
Depth	220.0 mm
Height (Upper Strip)	0.0 mm
Elevation (Plinth)	50.0 mm

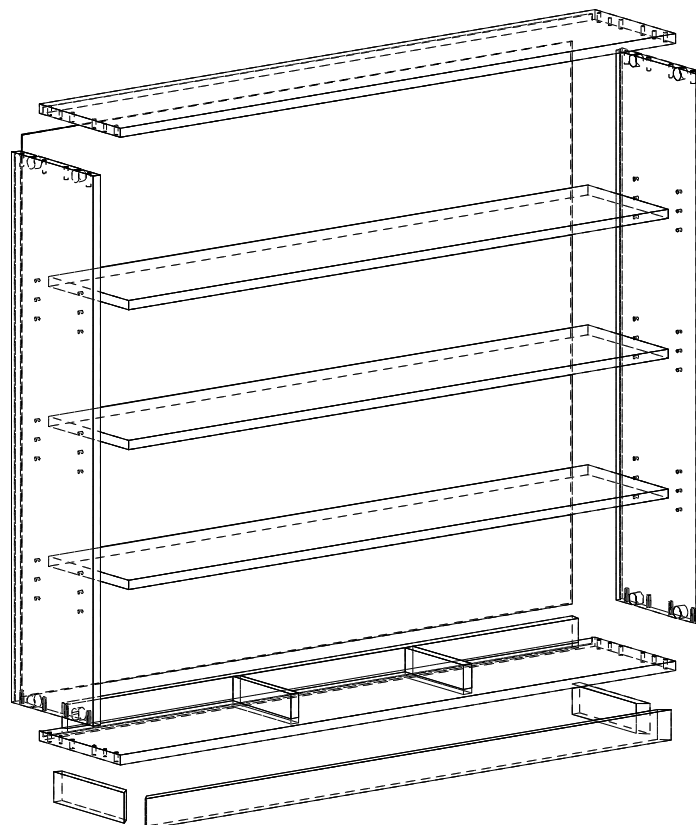
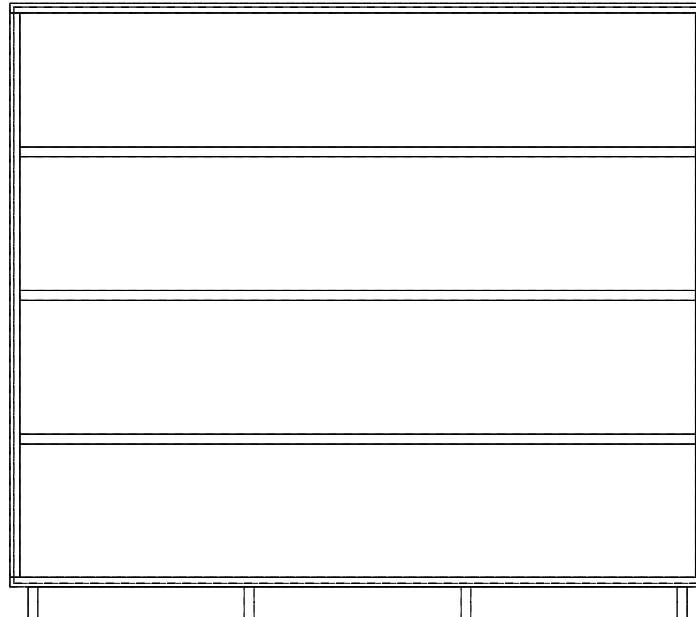

Cutting List (Net Dimensions) Hardboard, 3.2

Reference	Height	Width	Quantity	Grain	Left Edge	Right Edge	Bottom Edge	Top Edge
Back	938.0	1120.0	1	No				

Cutting List (Net Dimensions) Supawood, 16.0

Reference	Height	Width	Quantity	Grain	Left Edge	Right Edge	Bottom Edge	Top Edge
Top	1132.0	220.0	1	No				
Bottom	1132.0	220.0	1	No				
Left Side	918.0	220.0	1	No				
Right Side	918.0	220.0	1	No				
Mobile Shelve [1], Mobile Shel...	1100.0	216.8	3	No				
Vertical Division [1], Vertical Di...	50.0	158.0	2	No				
Double-Back 1 [1]	50.0	1040.0	1	No				
Plinth [1]	50.0	1072.0	1	No				
Plinth [2]	50.0	190.0	1	No				
Plinth [3]	50.0	190.0	1	No				

Recapitulatory

Panel	Surface	Price (€/m²)	Price
Hardboard, 3.2	1.05 m²	10.25	10,77 €
Supawood, 16.0	1.76 m²		0,00 €
Total			10,77 €
Fittings	Quantity	Unit Price	Price
Adjustable_shelf_holesx3	12	0.08	0,96 €
Cam 20+dowels 6x2	8	0.60	4,80 €
Dowel 6mm 24/13	12	0.40	4,80 €
Total			10,56 €
Overall Total			21,33 €

Top 00001847	Supawood	Height: 1132.0	Width: 220.0	Thickness: 16.0	Quantity: 1
Drilling	A (4) B (8)	Diameter: 5.0 Diameter: 6.0	Depth: 12.0 Depth: 15.0		
Groove Vertical	Face 2	X Position: 218.4	Y Position: 6.0	Width: 3.2	Length: 1120.0 Depth: 10.0

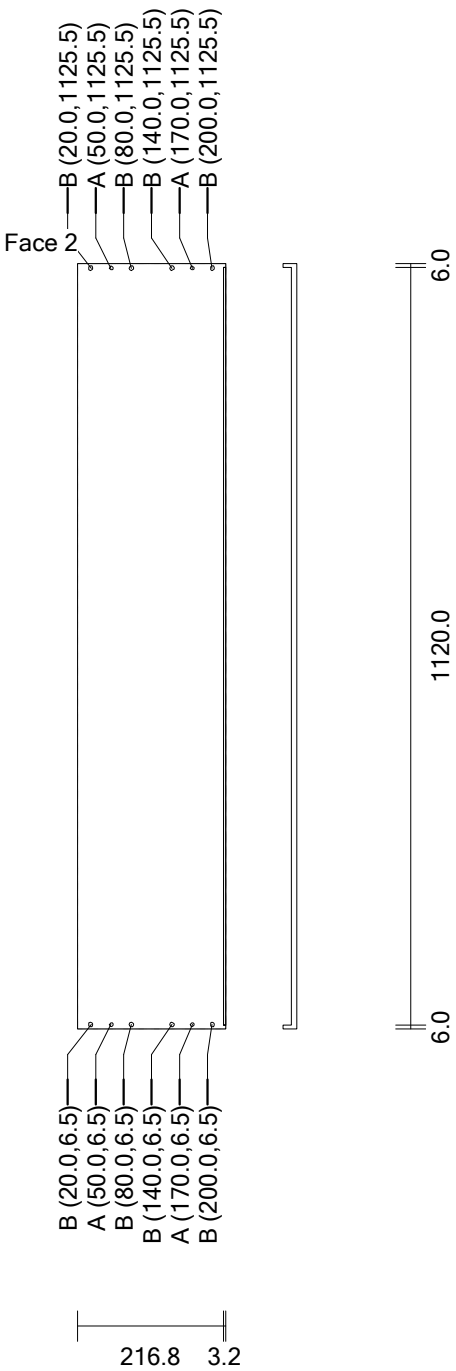

Bottom 00001848	Supawood	Height: 1132.0	Width: 220.0	Thickness: 16.0	Quantity: 1
Drilling	A (4) B (8)	Diameter: 5.0 Diameter: 6.0	Depth: 12.0 Depth: 15.0		
Groove Vertical	Face 1	X Position: 1.6	Y Position: 6.0	Width: 3.2	Length: 1120.0 Depth: 10.0

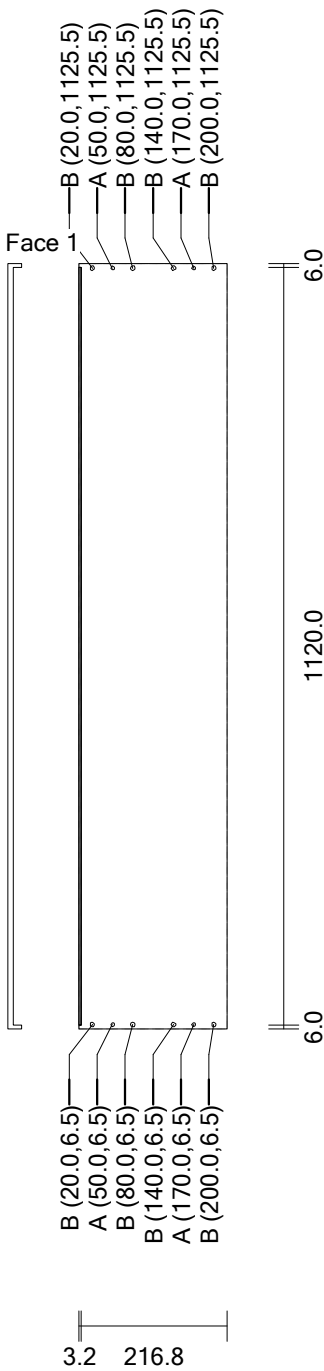

Left Side
00001849

Supawood

Height: 918.0

Width: 220.0

Thickness: 16.0

Quantity: 1

Drilling C (18) Diameter: 5.0 Depth: 7.0
 D (8) Diameter: 6.0 Depth: 21.0
 E (4) Diameter: 20.0 Depth: 14.0

Groove Vertical Face 2 X Position: 218.4 Y Position: 0.0 Width: 3.2 Length: 918.0 Depth: 10.0

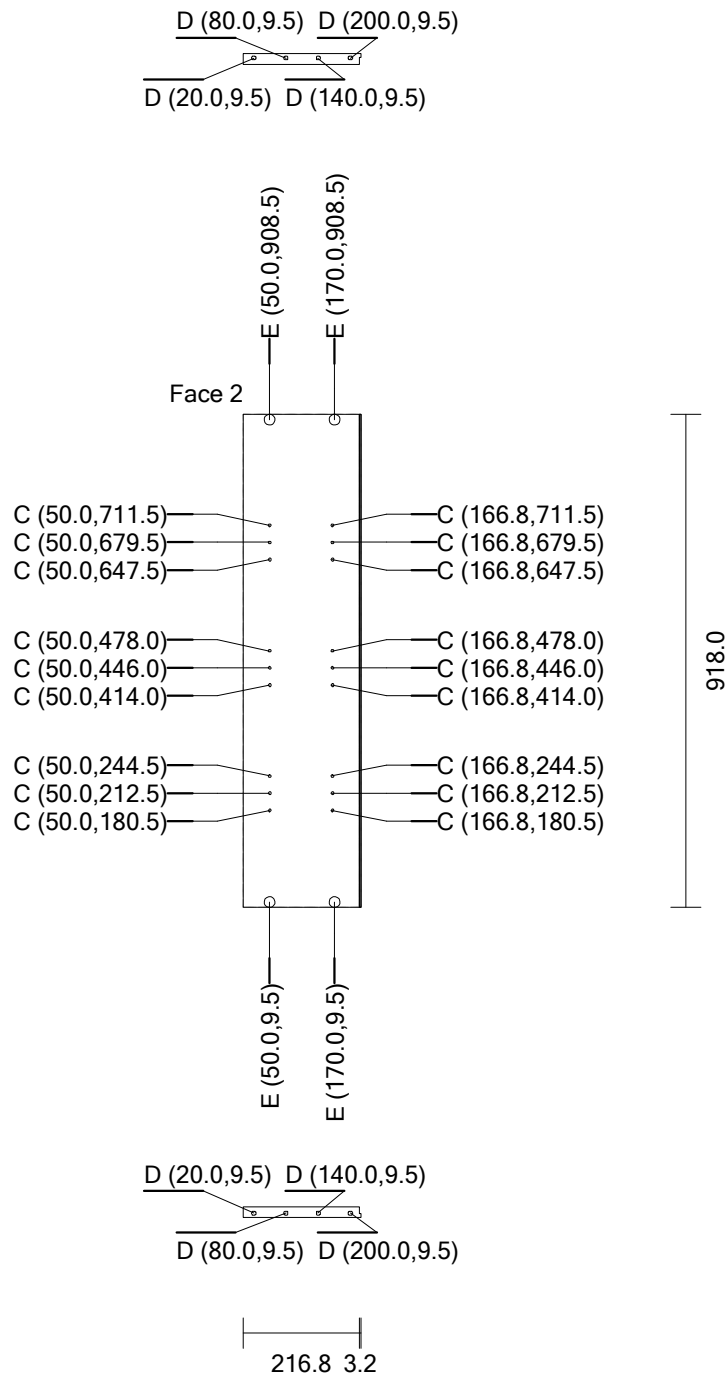

Right Side Supawood Height: 918.0 Width: 220.0 Thickness: 16.0 Quantity: 1
00001850

Drilling C (18) Diameter: 5.0 Depth: 7.0
 D (8) Diameter: 6.0 Depth: 21.0
 E (4) Diameter: 20.0 Depth: 14.0

Groove Vertical Face 1 X Position: 1.6 Y Position: 0.0 Width: 3.2 Length: 918.0 Depth: 10.0

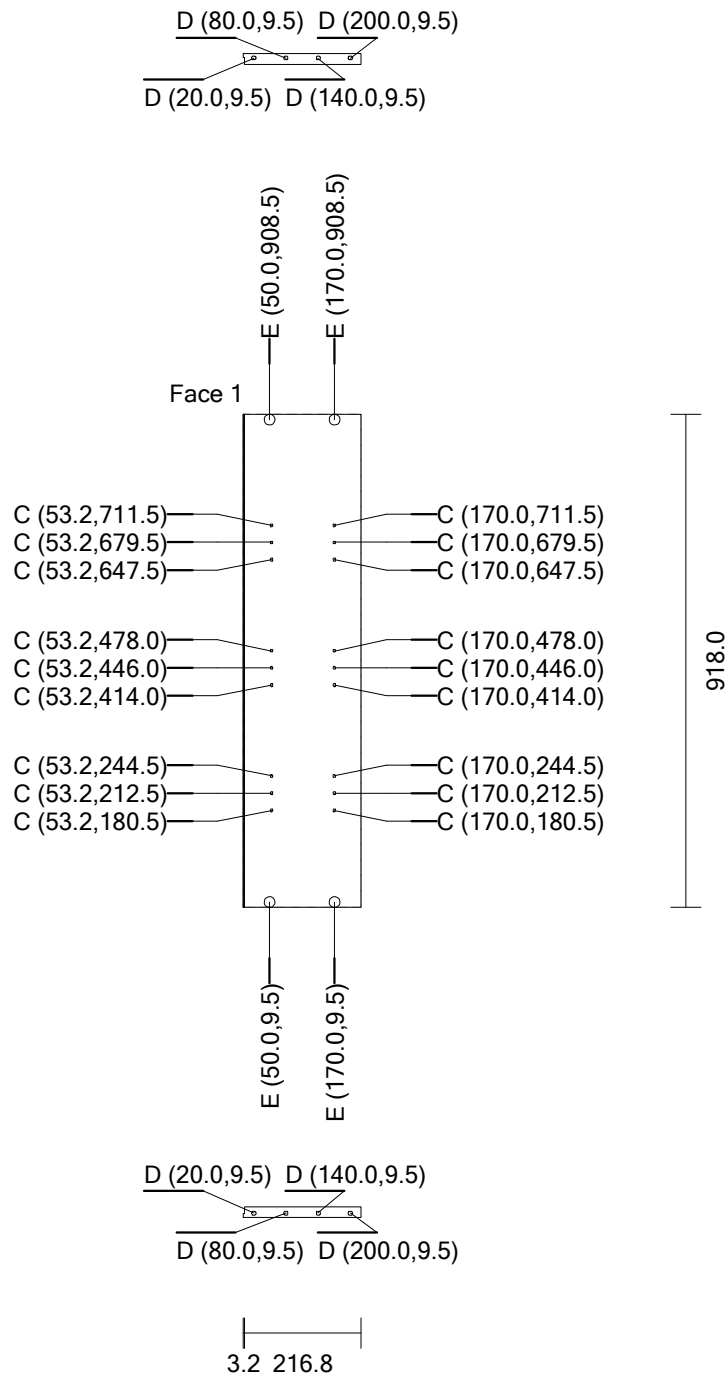

Back Hardboard Height: 938.0 Width: 1120.0 Thickness: 3.2 Quantity: 1

Face 1

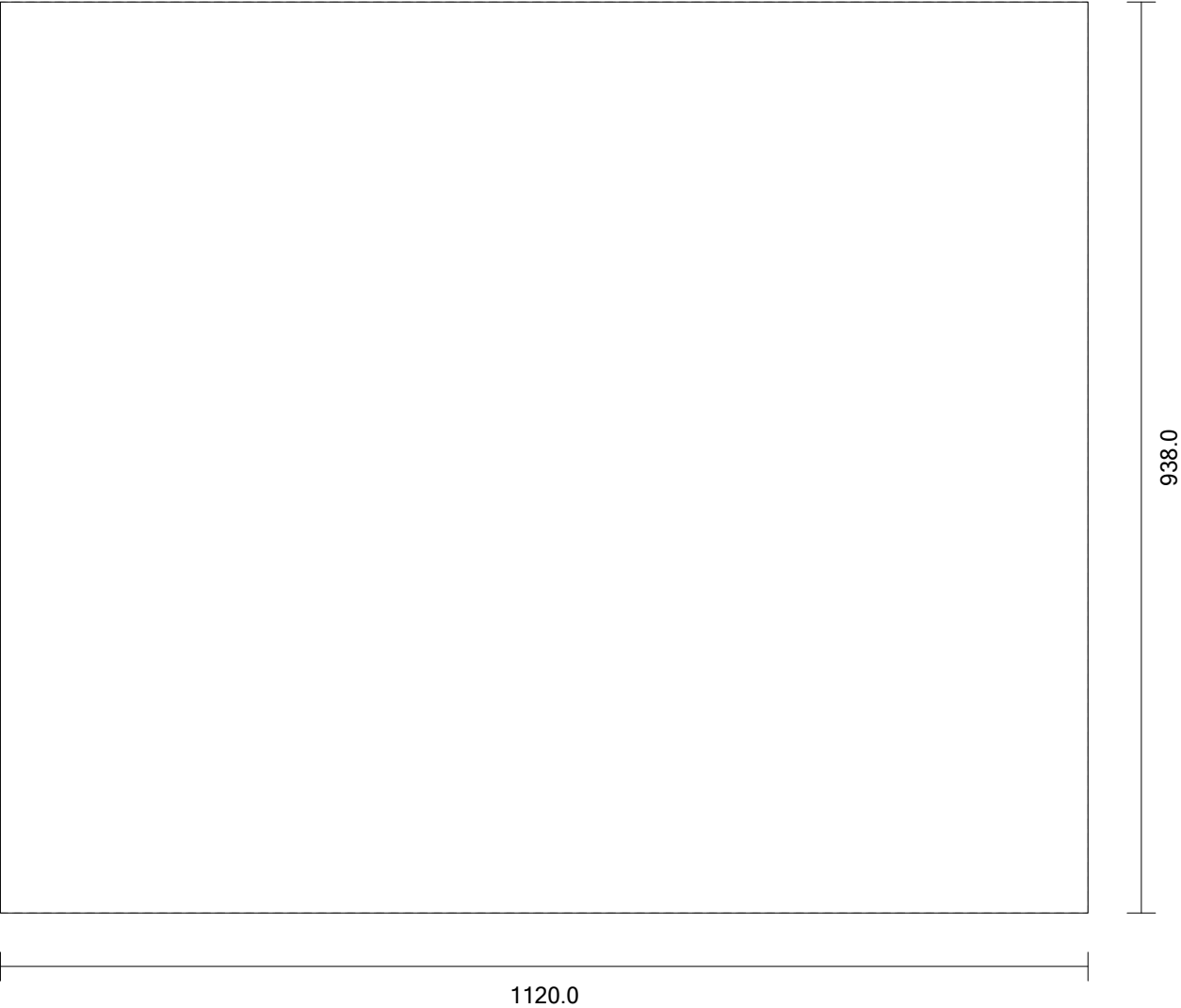

Mobile Shelf [1], Mobile Shelf [2], ... Supawood Height: 1100.0 Width: 216.8 Thickness: 16.0 Quantity: 3

Face 1

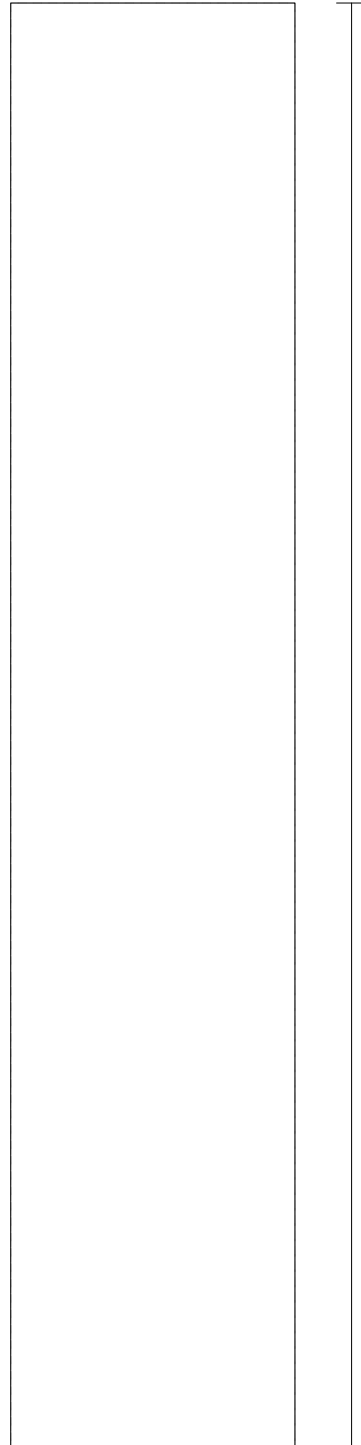

1100.0

216.8

Vertical Division [1], Vertical Division [2] Supawood Height: 50.0 Width: 158.0 Thickness: 16.0 Quantity: 2
00001851

Drilling F (4) Diameter: 6.0 Depth: 24.0

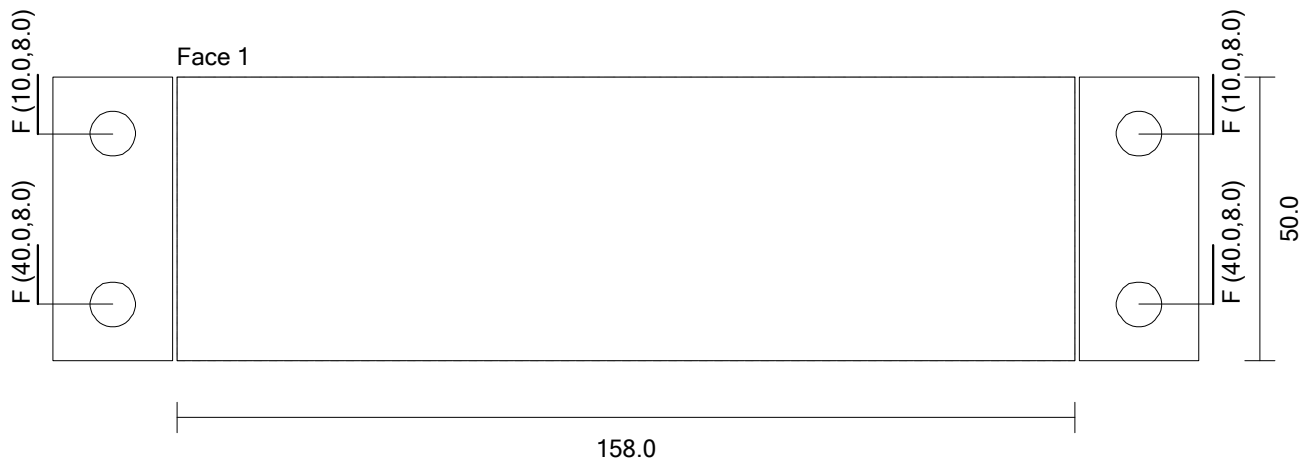

Double-Back 1 [1] 00001852	Supawood	Height: 50.0	Width: 1040.0	Thickness: 16.0	Quantity: 1
Drilling	F (4) G (4)	Diameter: 6.0 Diameter: 6.0	Depth: 24.0 Depth: 13.0		

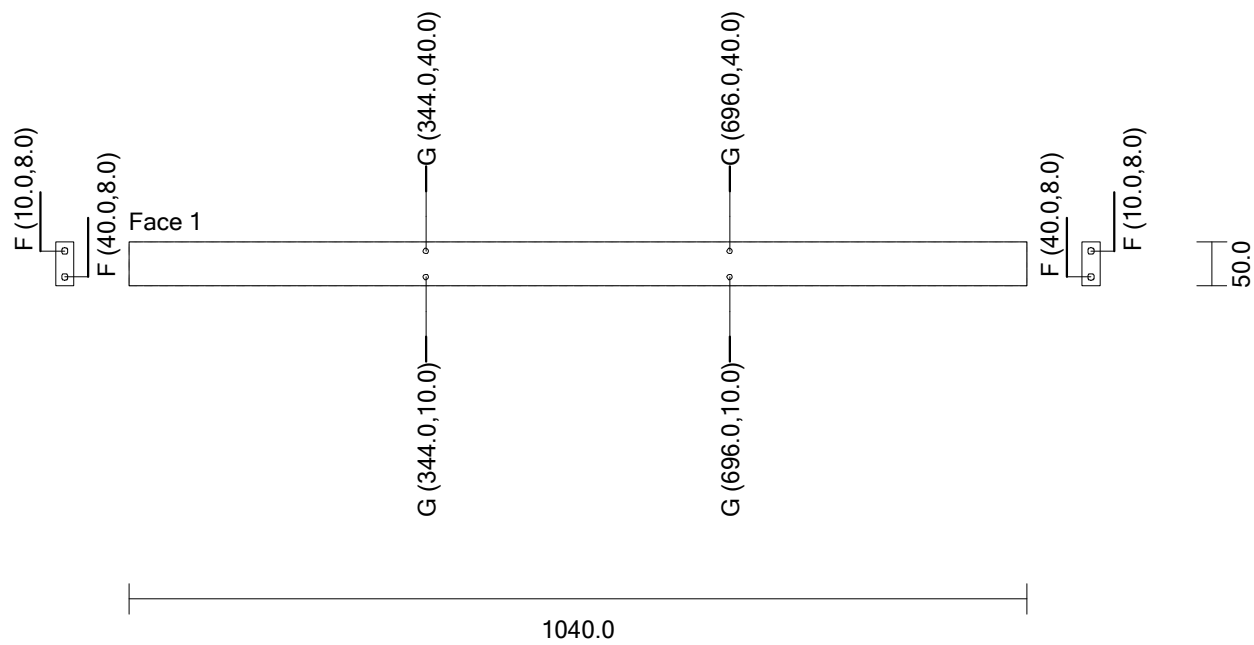

Plinth [1] Supawood Height: 50.0 Width: 1072.0 Thickness: 16.0 Quantity: 1
00001853

Drilling G (4) Diameter: 6.0 Depth: 13.0

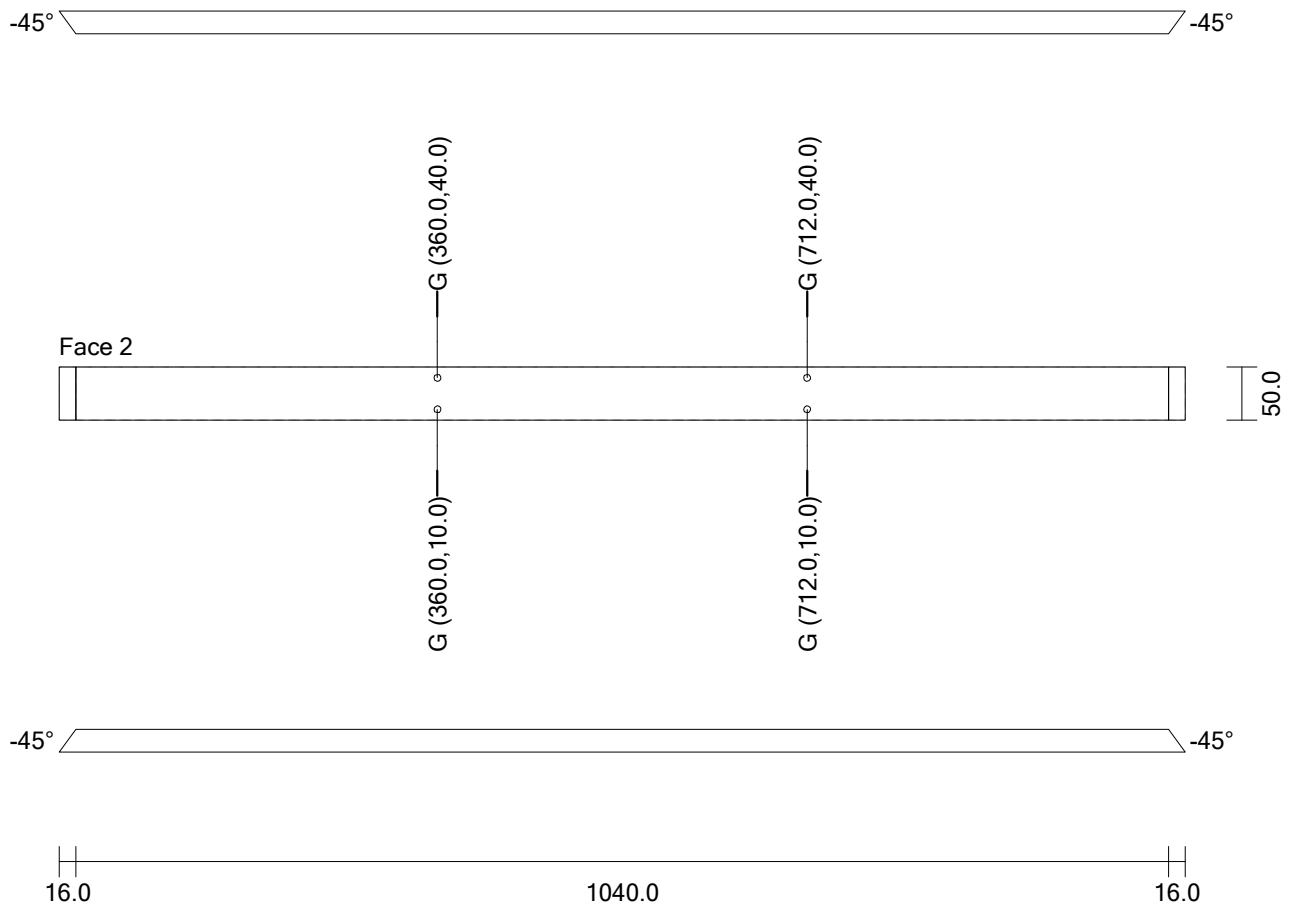

Plinth [2] Supawood Height: 50.0 Width: 190.0 Thickness: 16.0 Quantity: 1
00001854
Drilling G (2) Diameter: 6.0 Depth: 13.0

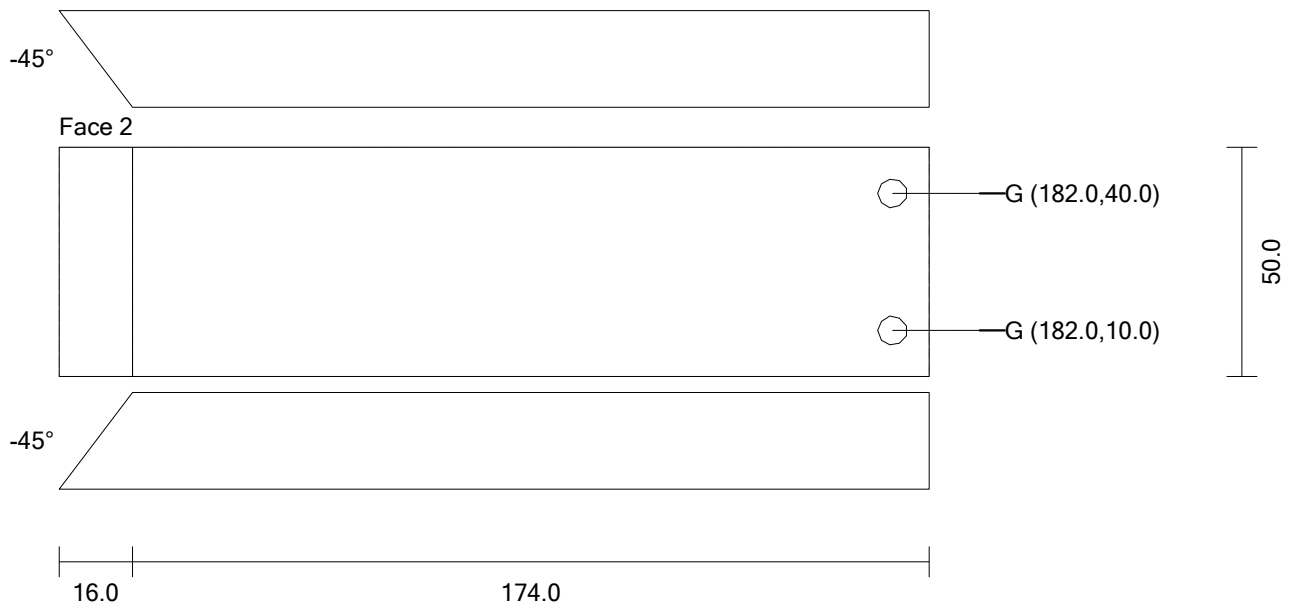

Plinth [3] Supawood Height: 50.0 Width: 190.0 Thickness: 16.0 Quantity: 1
00001855

Drilling G (2) Diameter: 6.0 Depth: 13.0

