

Width 6600.0 mm  
Depth 4391.4 mm

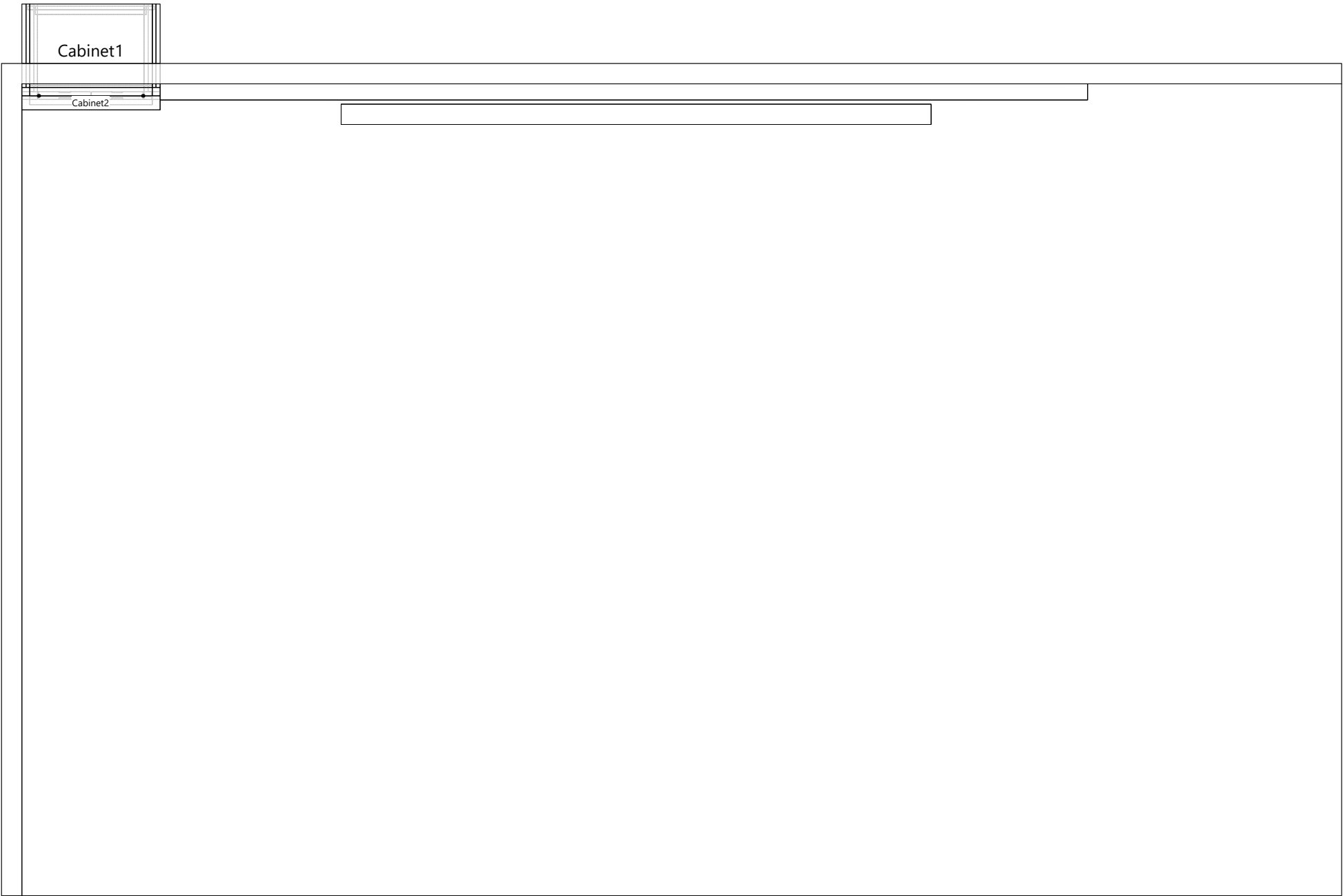

Cabinet List

Name	Height (mm)	Width (mm)	Depth (mm)	Quantity	Unit Price (€)	Price (€)
Cabinet1	1055.0	680.0	450.0	1	112.38	112.38
Cabinet2	800.0	680.0	520.0	1	130.92	130.92
Total						243.30

Cutting List (Overall Dimensions) generic 018 oak noseing, 40.0

Num	Reference	Height	Width	Quantity	Grain	Left Edge	Right Edge	Bottom Edge	Top Edge
— Cabinet1 —									
6	Fixed Shelf	604.0	372.0	2	Yes		edge-010, 1.0 mm		

Cutting List (Overall Dimensions) generic 018 oak noseing, 40.0

Num	Reference	Height	Width	Quantity	Grain	Left Edge	Right Edge	Bottom Edge	Top Edge
— Cabinet2 —									
1	Top	680.0	520.0	1	Yes		edge-010, 1.0 mm	edge-010, 1.0 mm	edge-010, 1.0 mm
6	Back	592.0	544.0	1	Yes				

Cutting List (Overall Dimensions) generic 0180, 18.0

Num	Reference	Height	Width	Quantity	Grain	Left Edge	Right Edge	Bottom Edge	Top Edge
— Cabinet1 —									
2	Top_2	604.0	410.0	1	No				
4	Side_2	1000.0	410.0	2	No			edge-010, 1.0 mm	edge-010, 1.0 mm
5	Back	982.0	624.0	1	No				
— Cabinet2 —									
3	Bottom_2	524.0	430.0	1	No				
5	Side_2	610.0	430.0	2	No			edge-010, 1.0 mm	
8	Fixed Shelf [1]_2	524.0	380.0	1	No				

Cutting List (Overall Dimensions) generic 0380, 38.0

Num	Reference	Height	Width	Quantity	Grain	Left Edge	Right Edge	Bottom Edge	Top Edge
— Cabinet1 —									
1	Top_1		604.0	40.0	1	No			
3	Side_1		1000.0	40.0	2	No			
— Cabinet2 —									
2	Bottom_1		524.0	40.0	1	No			
4	Side_1		610.0	40.0	2	No			
7	Fixed Shelf [1]_1		524.0	40.0	1	No			
9	Door Eku-clipo (Double) [1]		528.0	255.5	2	No			
10	Plinth 1 [1]		604.0	150.0	1	No			
11	Filler 1		760.0	40.0	2	No			

Costing Report

Panel	Surface	Price (€/m²)	Price
generic 018 oak noseing, 40.0	0.68 m²	40.00	27,03 €
generic 018 oak noseing, 40.0	0.45 m²	40.00	17,98 €
generic 0180, 18.0	2.63 m²	40.00	105,18 €
generic 0380, 38.0	0.62 m²	80.00	49,28 €
Total			199,47 €
Edge	Length	Price (€/m)	Price
edge-010, 1.0 mm	5.4 m	1.00	5,43 €
Total			5,43 €
Supply			
Fittings	Quantity	Unit Price	Price
0-screw/040	56	0.00	0,00 €
Total			0,00 €
Single Panel Fittings	Quantity	Unit Price	Price
handle/50x2/ver/3d-020	2	5.00	10,00 €
Total			10,00 €
Tooling (Fittings)			
Fittings	Quantity	Unit Price	Price
0-screw/040	56	0.50	28,00 €
Total			28,00 €
Single Panel Fittings	Quantity	Unit Price	Price
handle/50x2/ver/3d-020	2	0.20	0,40 €
Total			0,40 €
Tooling			
Groove	Length	Price (€/m)	Price
18.5 mm (10.5 mm)	1.6 m	0.00	0,00 €
18.5 mm (9.5 mm)	1.0 m	0.00	0,00 €
40.5 mm (10.5 mm)	0.5 m	0.00	0,00 €
40.5 mm (9.5 mm)	1.7 m	0.00	0,00 €
Total			0,00 €
Shape	Quantity	Unit Price	Price
Depth : 9.0 mm	0.04 m²	0.00	0,00 €
Depth : 3.0 mm	0.04 m²	0.00	0,00 €
Total			0,00 €

Cabinet1

Height	1055.0 mm
Width	680.0 mm
Depth	450.0 mm
Height (Upper Strip)	55.0 mm
Elevation (Plinth)	0.0 mm

FRONT VIEW

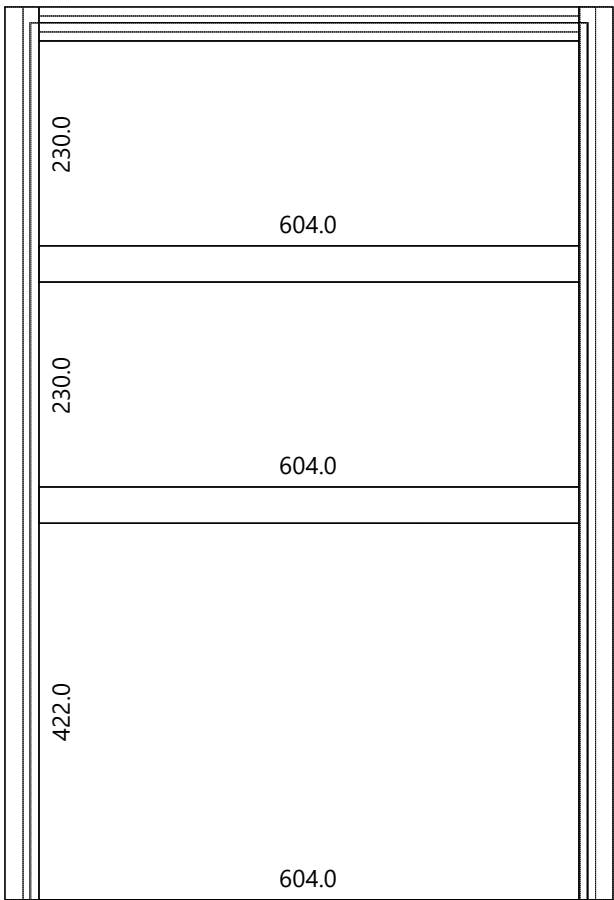

LEFT VIEW

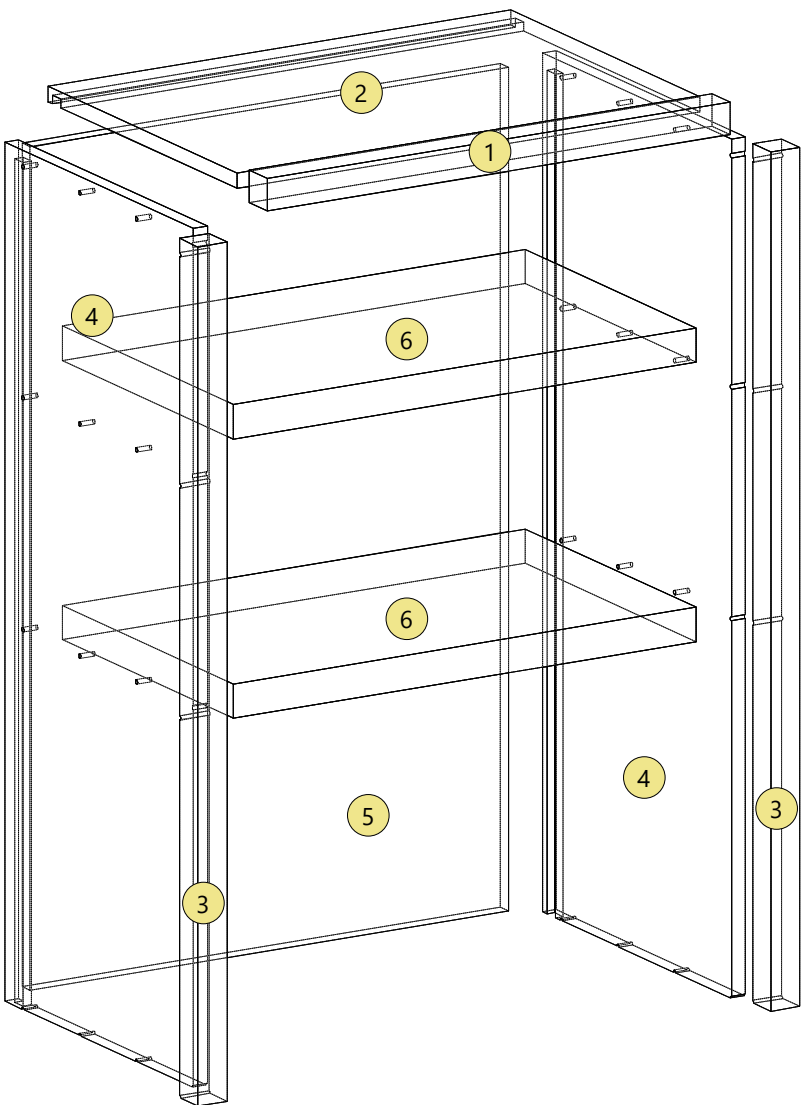
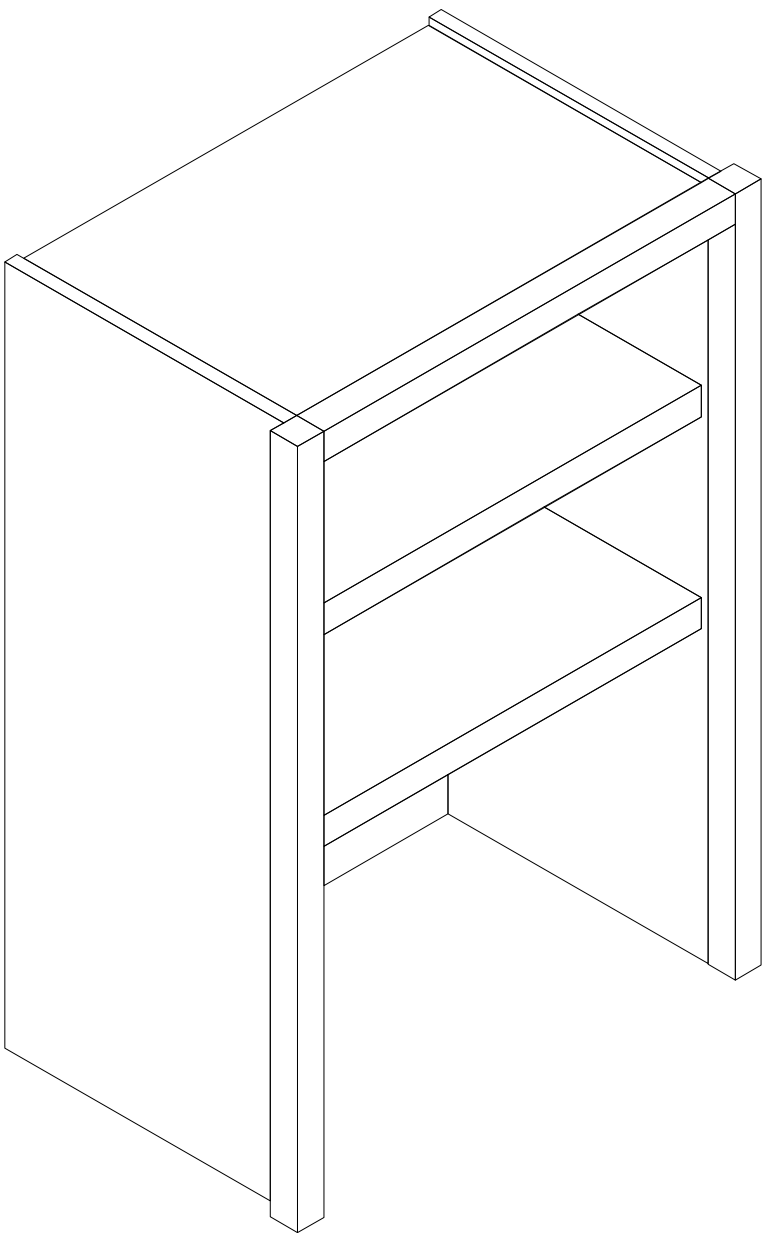
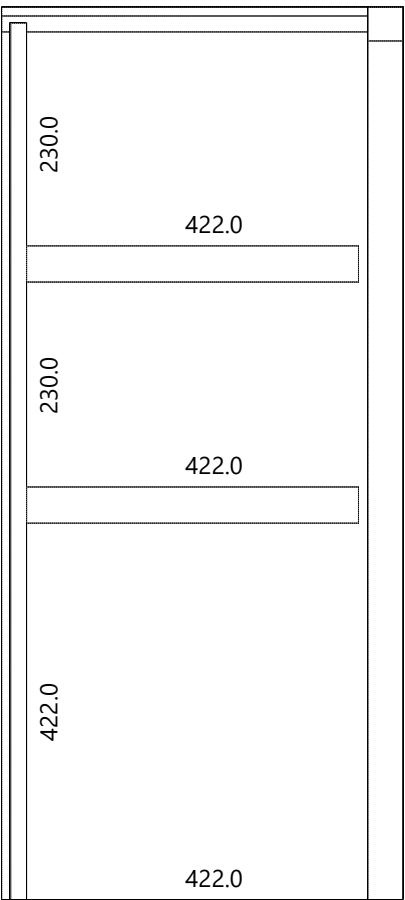

Cabinet1					
Top_1	generic 0380	Height: 604.0	Width: 40.0	Thickness: 38.0	Quantity: 1

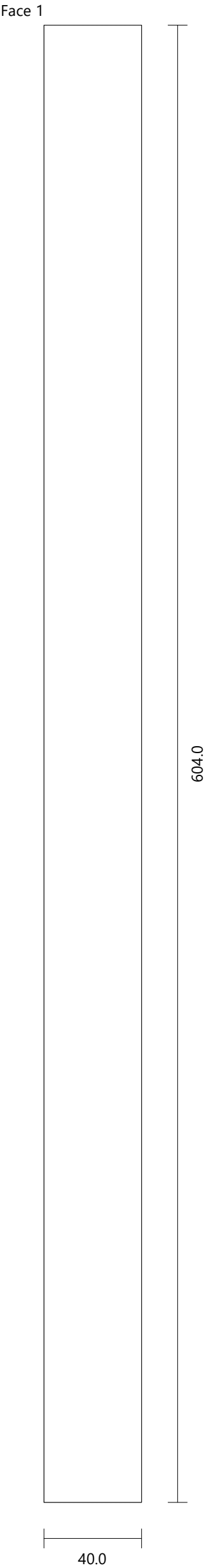

Cabinet1							
Top_2	generic 0180	Height: 604.0	Width: 410.0	Thickness: 18.0		Quantity: 1	
Groove Vertical	Face 2	X-Position: 391.3	Y-Position: 0.0	Width: 18.5	Length: 604.0	Depth: 10.5	

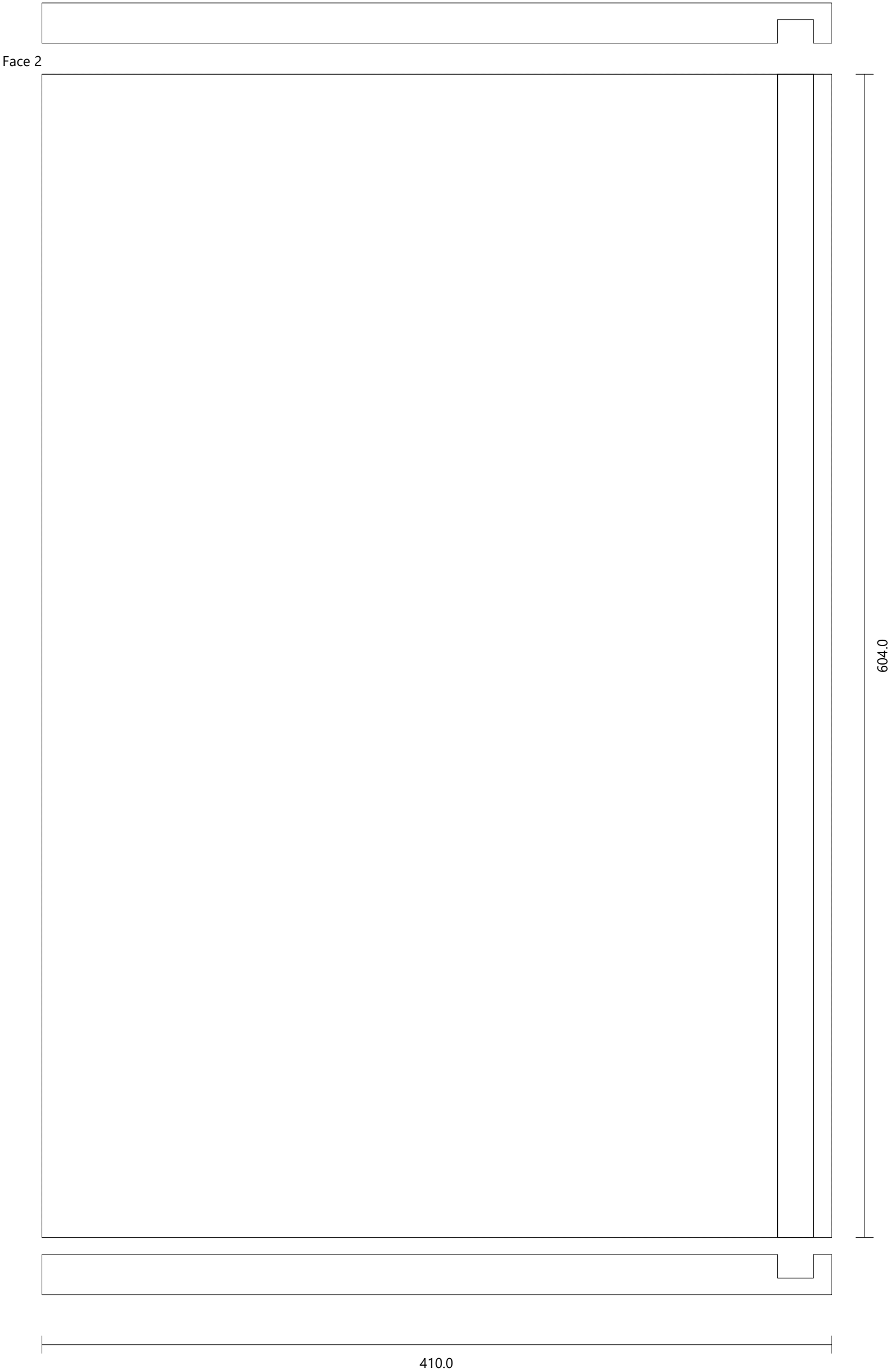

Cabinet1					
Left Side_1		generic 0380	Height: 1000.0	Width: 40.0	Thickness: 38.0
Drilling	A (4)	Diameter: 5.0	Depth: Through (0.0)		Quantity: 1

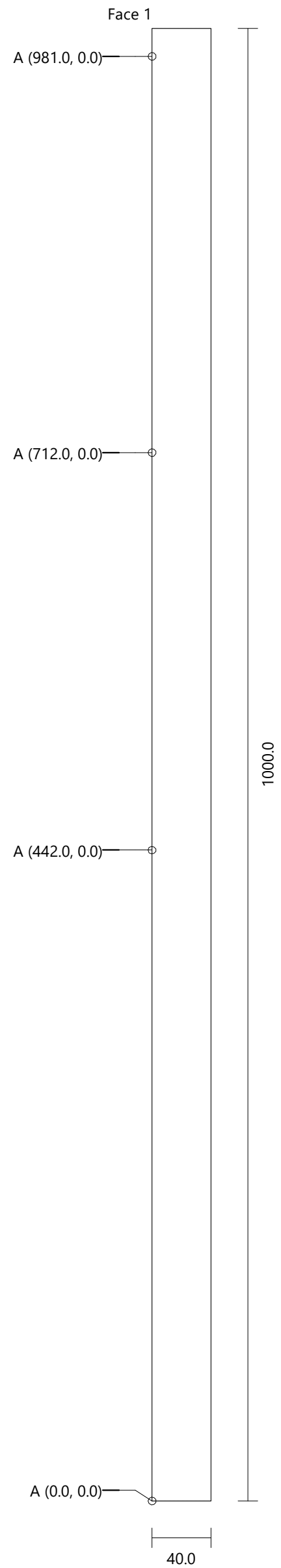

Cabinet1						
Left Side_2	generic 0180	Height: 1000.0	Width: 410.0	Thickness: 18.0	Quantity: 1	
Drilling	A (16)	Diameter: 5.0	Depth: Through (0.0)			
Groove Vertical	Face 2	X-Position: 18.8	Y-Position: 18.0	Width: 18.5	Length: 982.0	Depth: 10.5

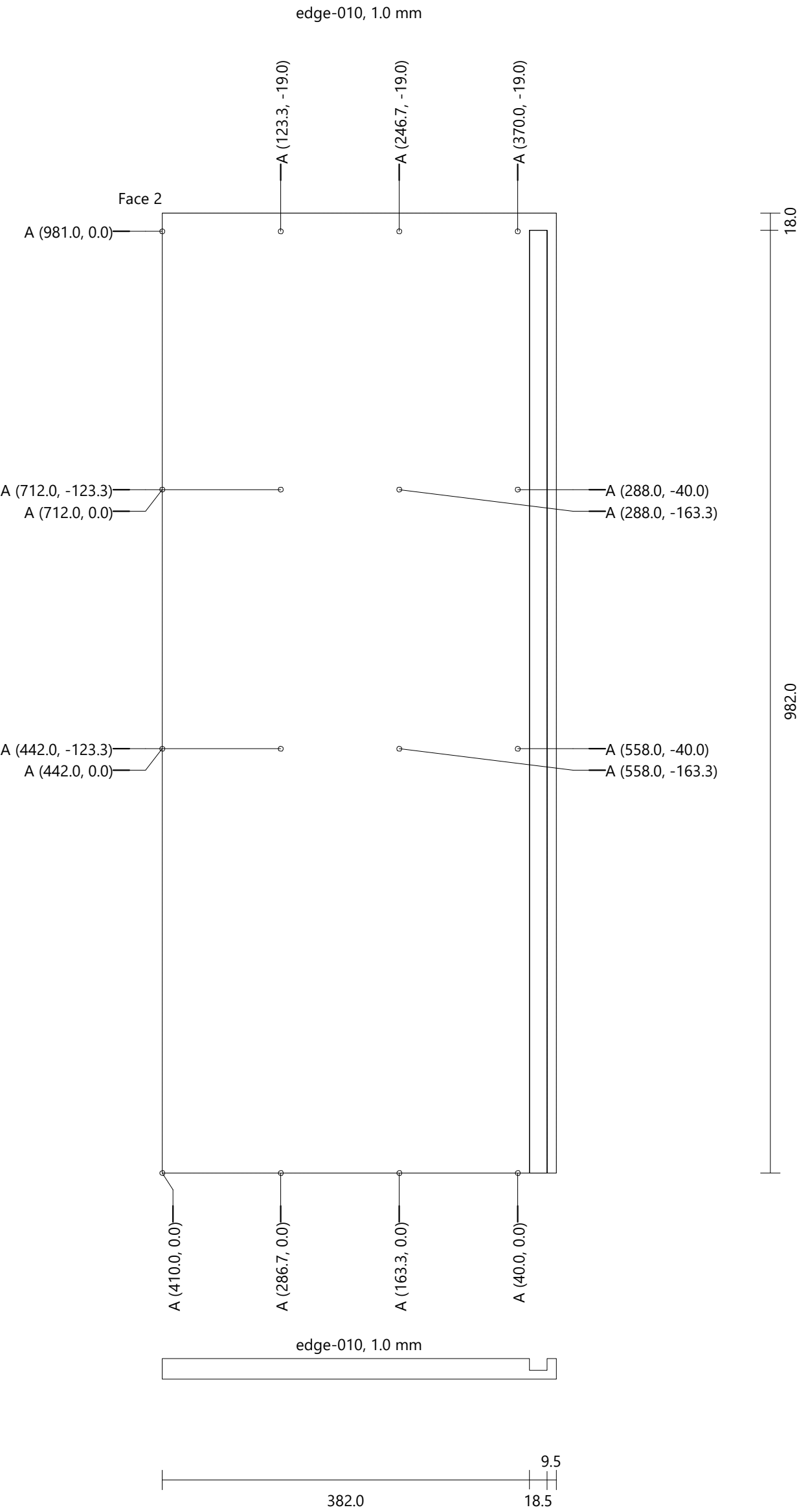



Cabinet1					
Right Side_1		generic 0380	Height: 1000.0	Width: 40.0	Thickness: 38.0
Drilling	A (4)	Diameter: 5.0	Depth: Through (0.0)		Quantity: 1

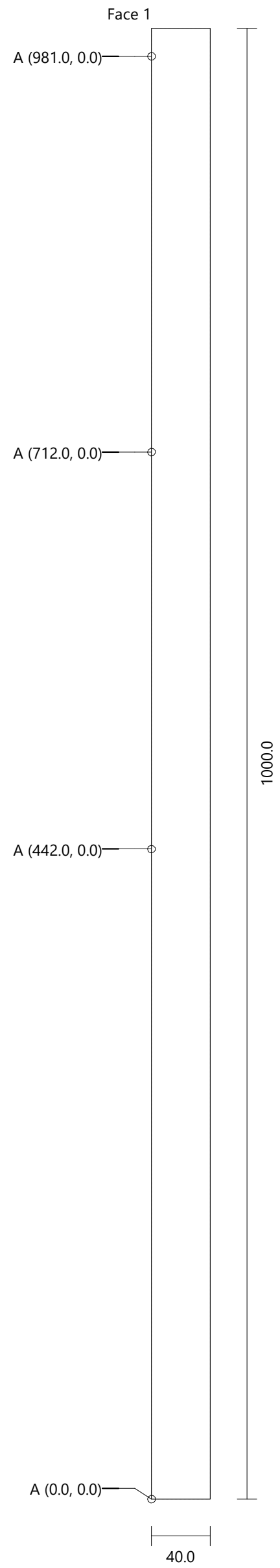

Cabinet1						
Right Side_2	generic 0180	Height: 1000.0	Width: 410.0	Thickness: 18.0	Quantity: 1	
Drilling	A (16)	Diameter: 5.0	Depth: Through (0.0)			
Groove Vertical	Face 1	X-Position: 18.8	Y-Position: 18.0	Width: 18.5	Length: 982.0	Depth: 9.5

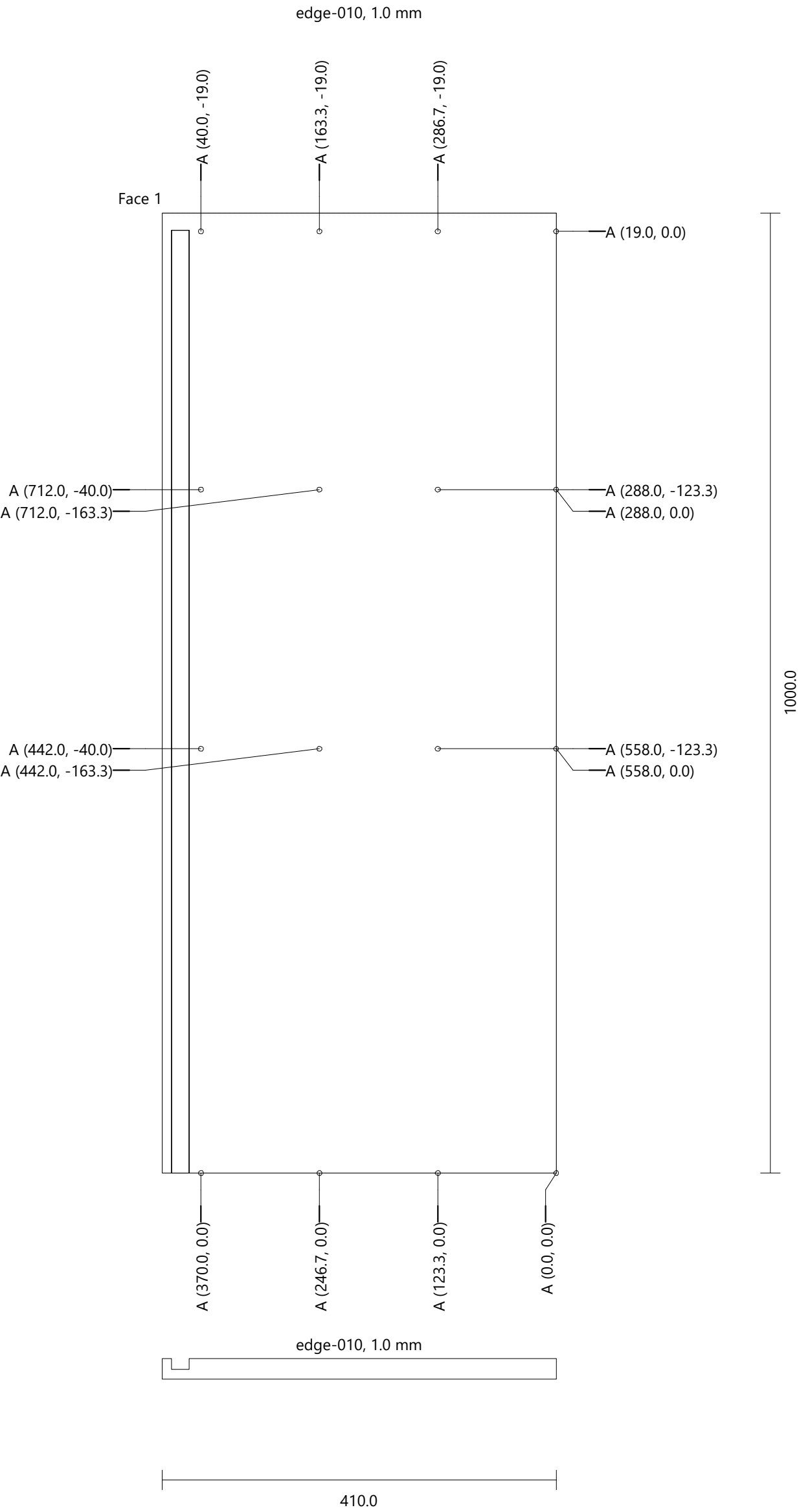

Cabinet1  
Backgeneric 0180Height: 982.0Width: 624.0Thickness: 18.0Quantity: 1

Face 1

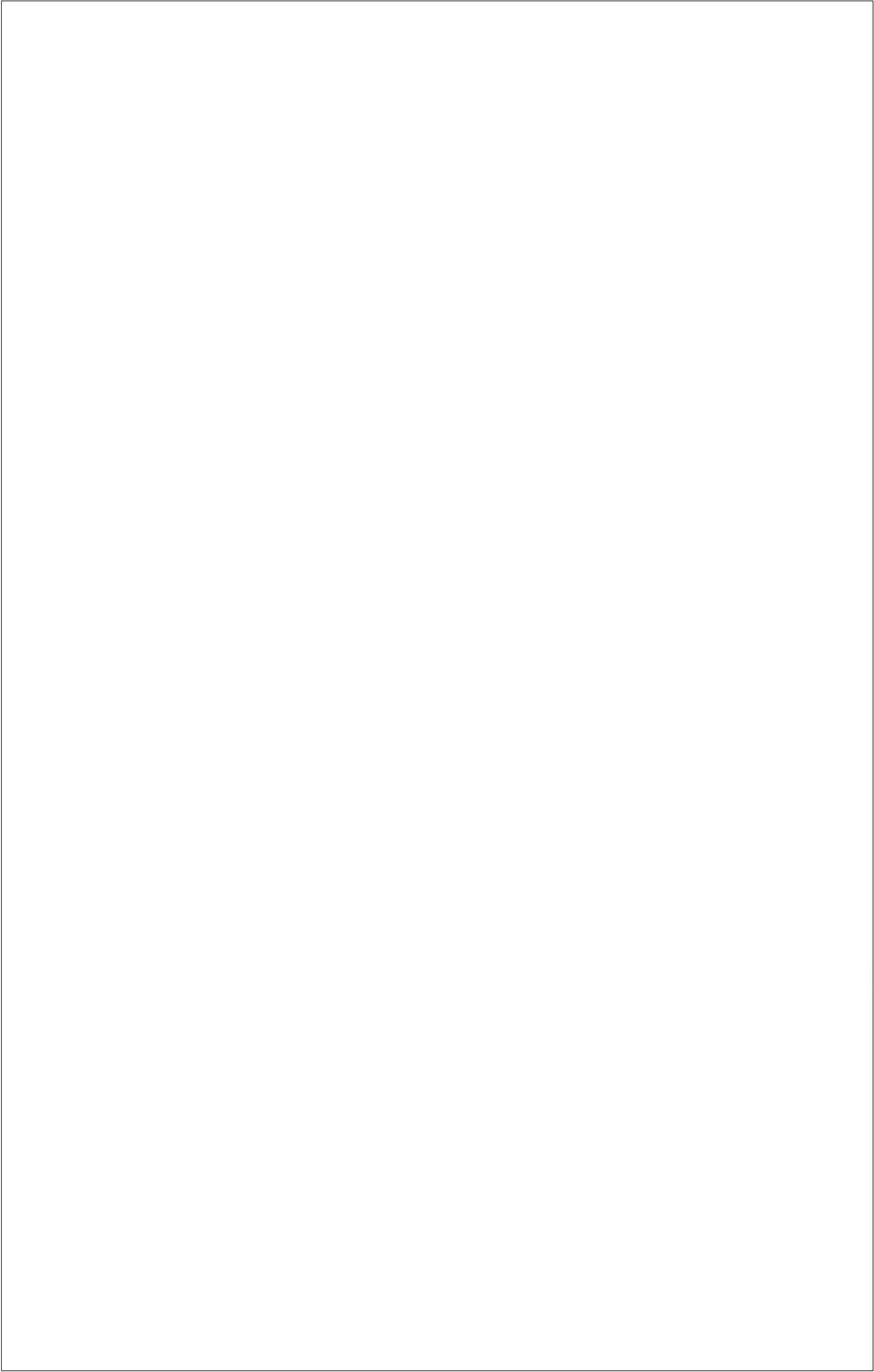

982.0

624.0

Cabinet1

Fixed Shelf

generic 018 oak noseing

Height: 604.0

Width: 372.0

Thickness: 40.0

Quantity: 2

Face 1

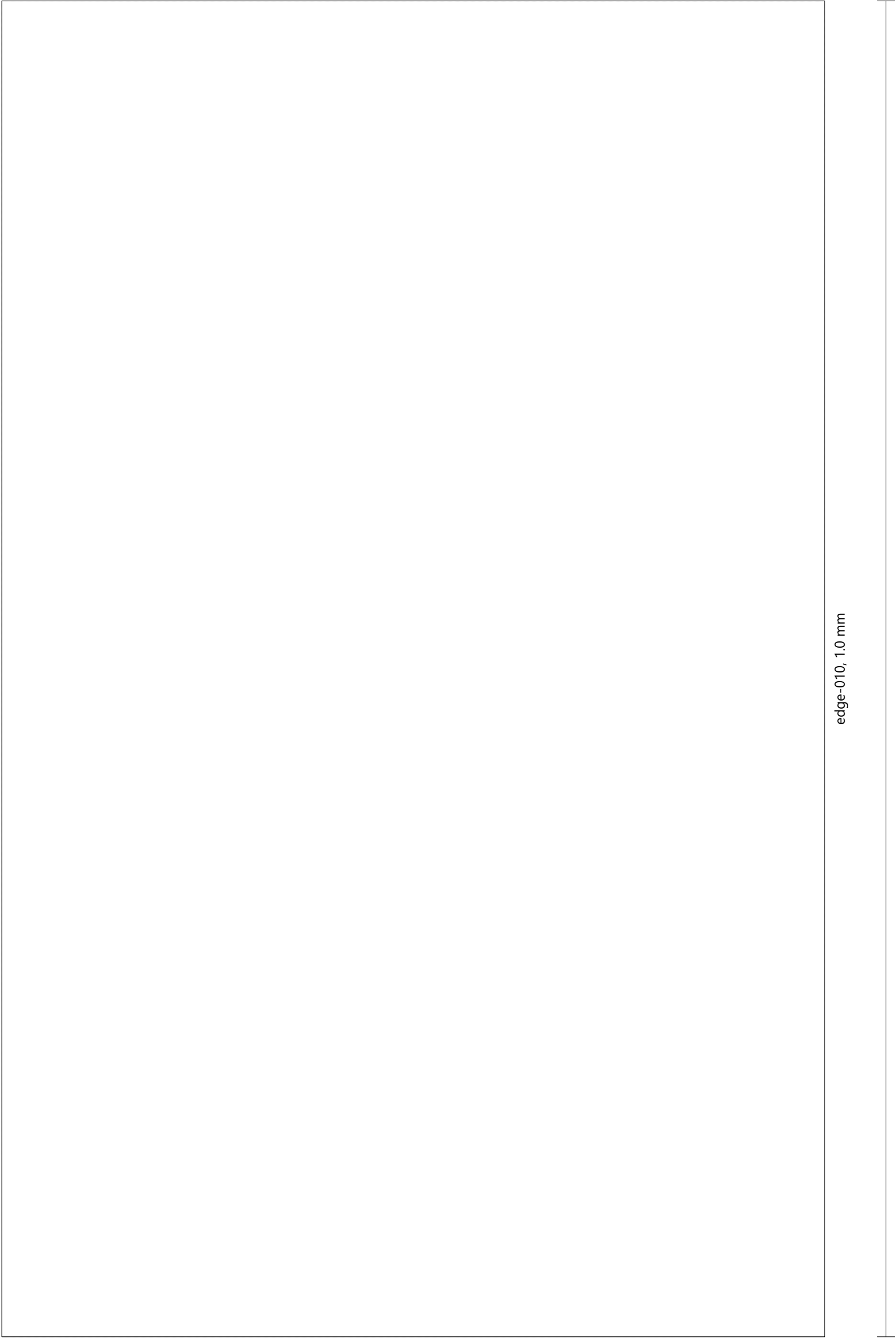

edge-010, 1.0 mm

604.0

372.0

Cabinet2

Height	800.0 mm
Width	680.0 mm
Depth	520.0 mm
Height (Upper Strip)	0.0 mm
Elevation (Plinth)	150.0 mm
Width (Right Side)	40.0 mm
Width (Left Side)	40.0 mm

FRONT VIEW

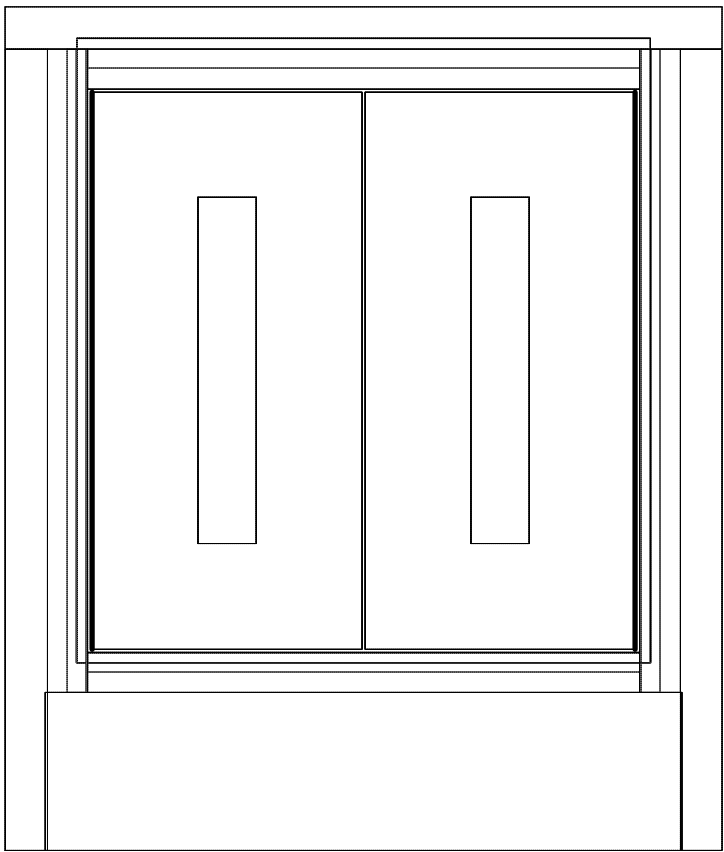

LEFT VIEW

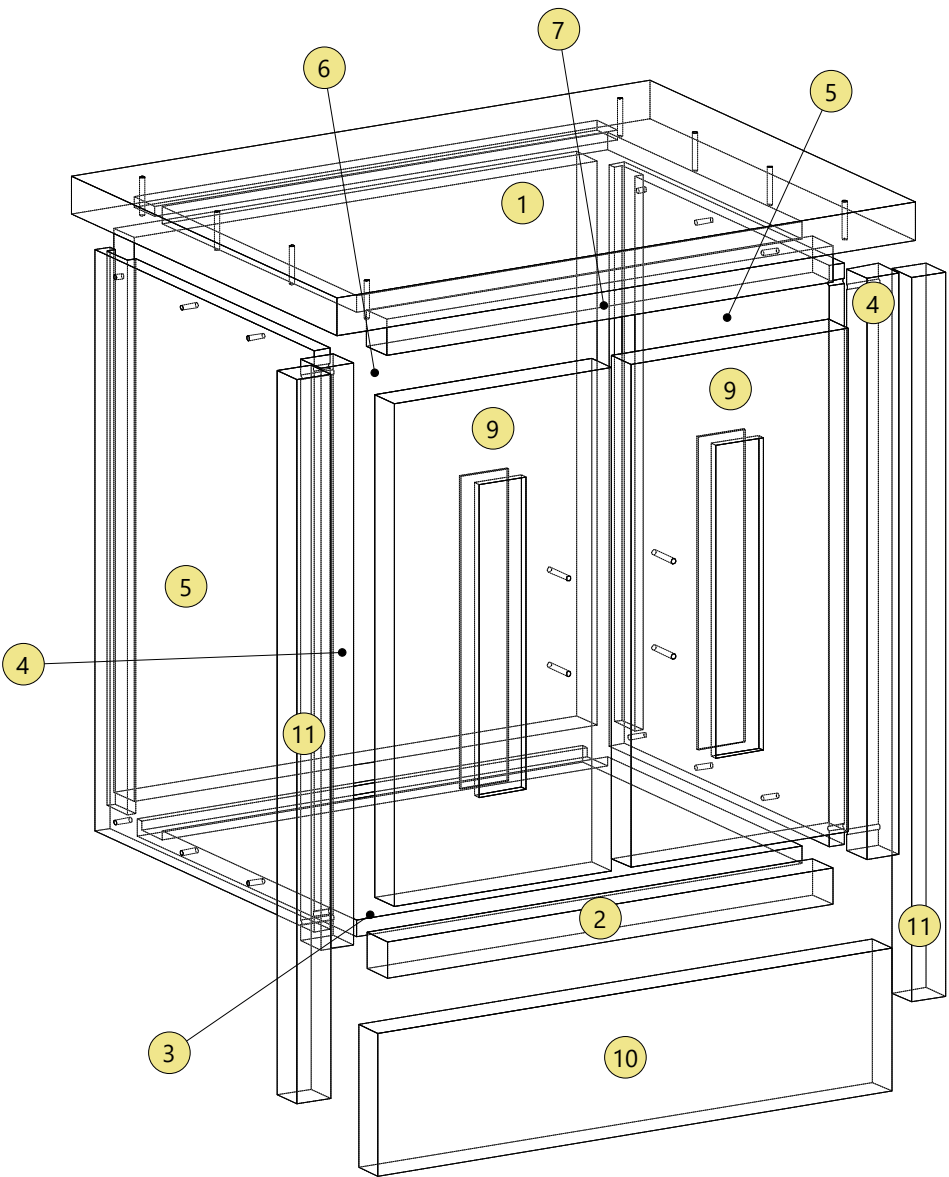
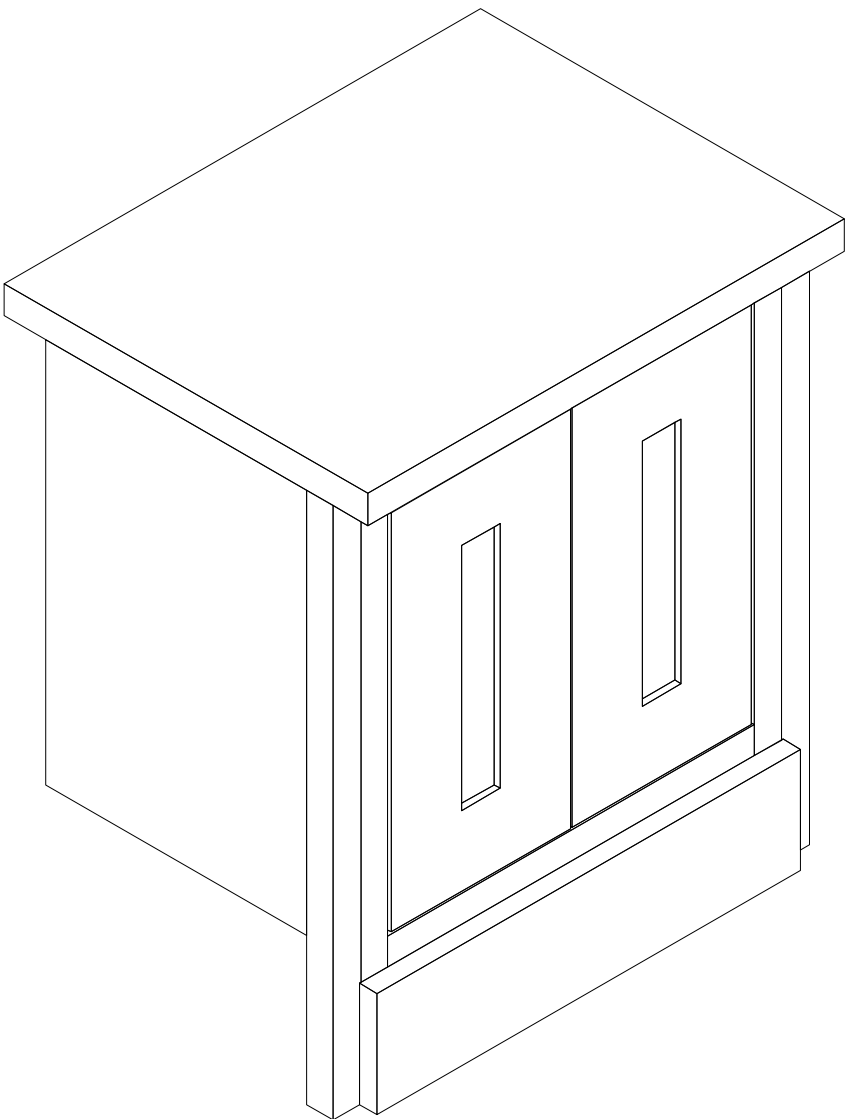
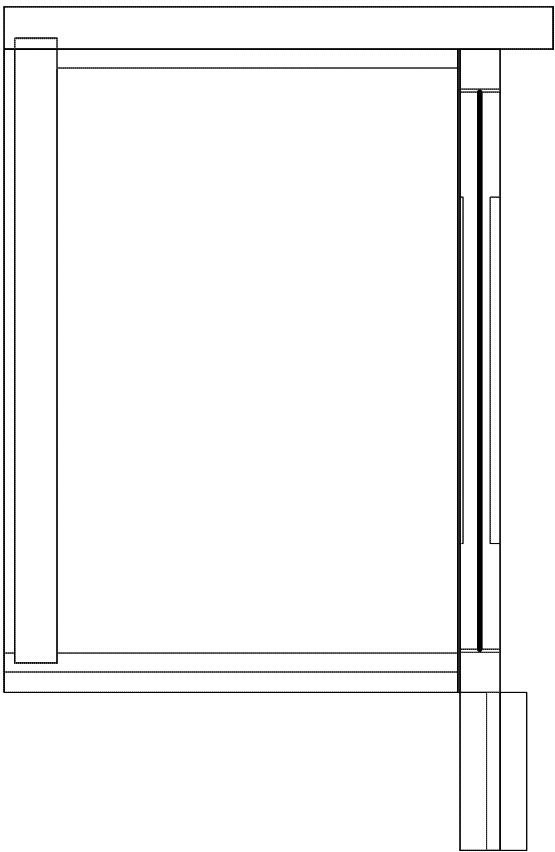

Quantity: 1

Depth: Through (0.0)

Depth: 10.5

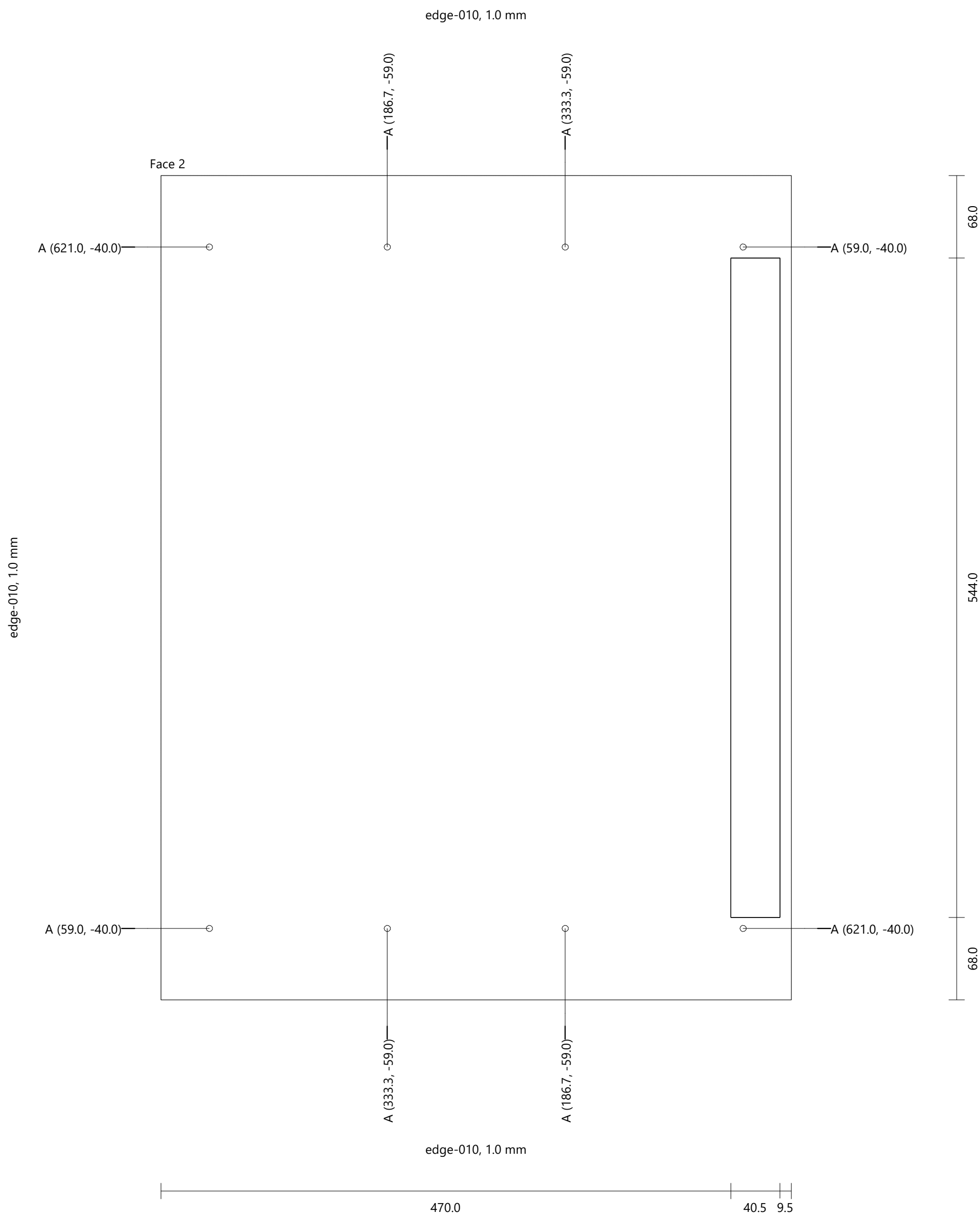

Cabinet2					
Bottom_1	generic 0380	Height: 524.0	Width: 40.0	Thickness: 38.0	Quantity: 1

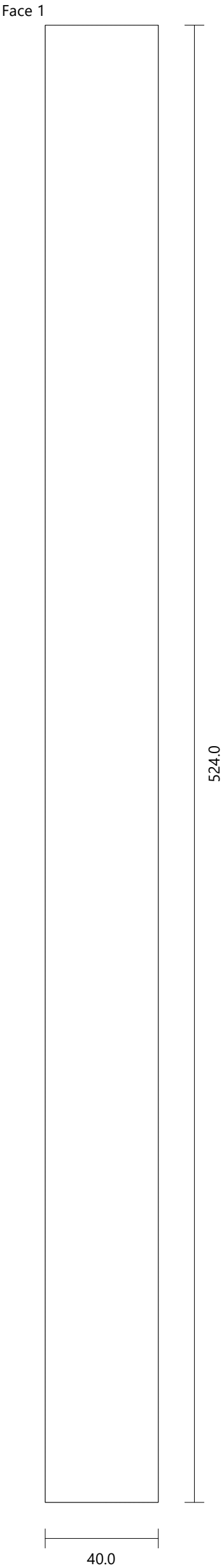

Cabinet2							
Bottom_2	generic 0180	Height: 524.0	Width: 430.0	Thickness: 18.0		Quantity: 1	
Groove Vertical	Face 1	X-Position: 29.8	Y-Position: 0.0	Width: 40.5	Length: 524.0	Depth: 9.5	

Face 1

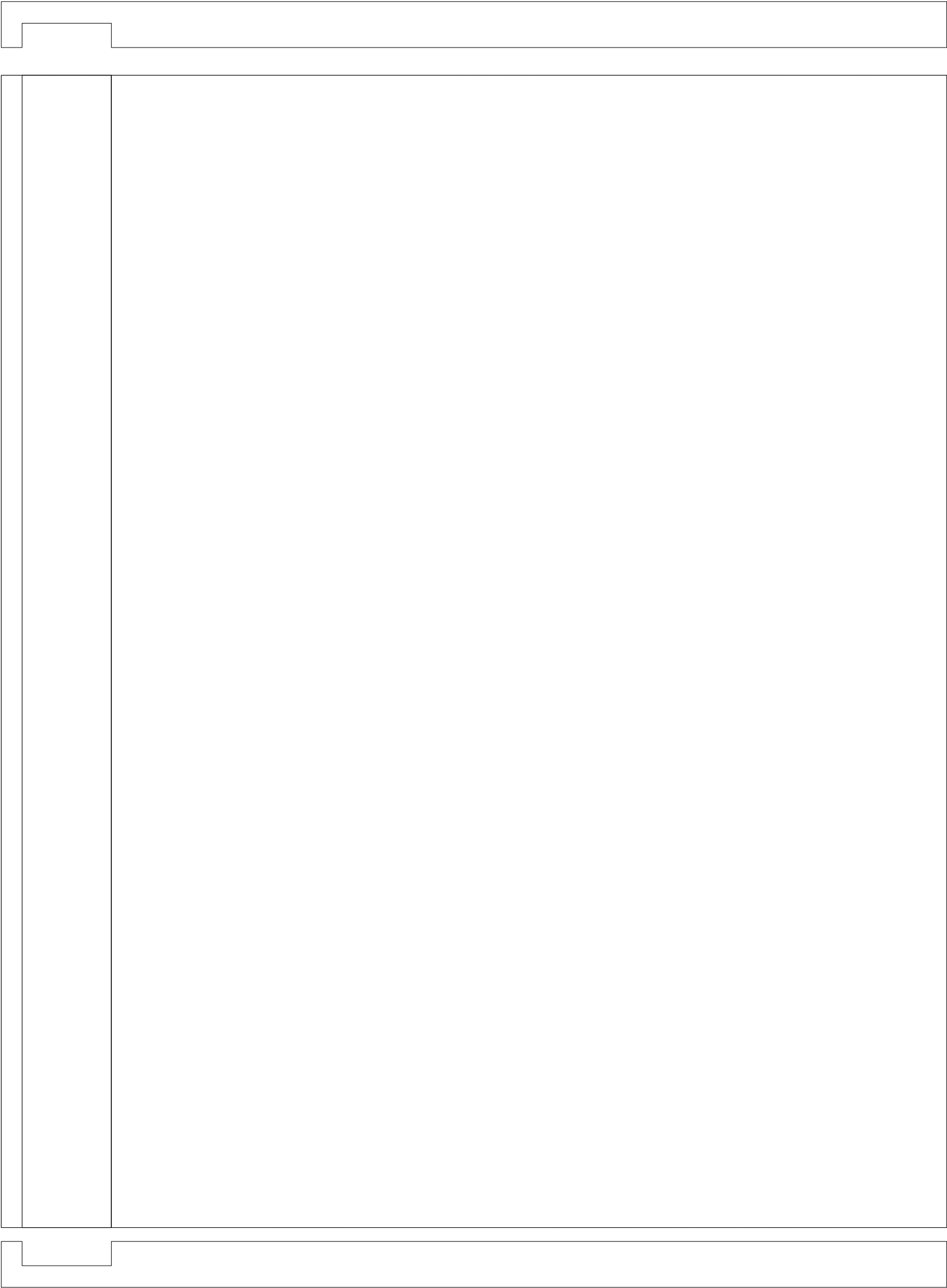



Cabinet2					
Left Side_1		generic 0380	Height: 610.0	Width: 40.0	Thickness: 38.0
Drilling	A (2)	Diameter: 5.0	Depth: Through (0.0)		Quantity: 1

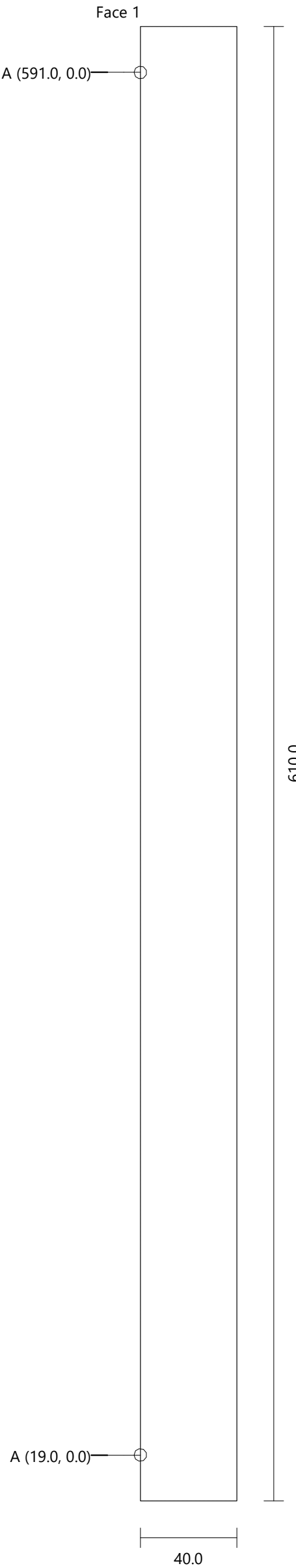

Cabinet2							
Left Side_2	generic 0180	Height: 610.0	Width: 430.0	Thickness: 18.0		Quantity: 1	
Drilling	A (8)	Diameter: 5.0	Depth: Through (0.0)				
Groove Vertical	Face 2	X-Position: 400.3	Y-Position: 28.0	Width: 40.5	Length: 582.0	Depth: 9.5	

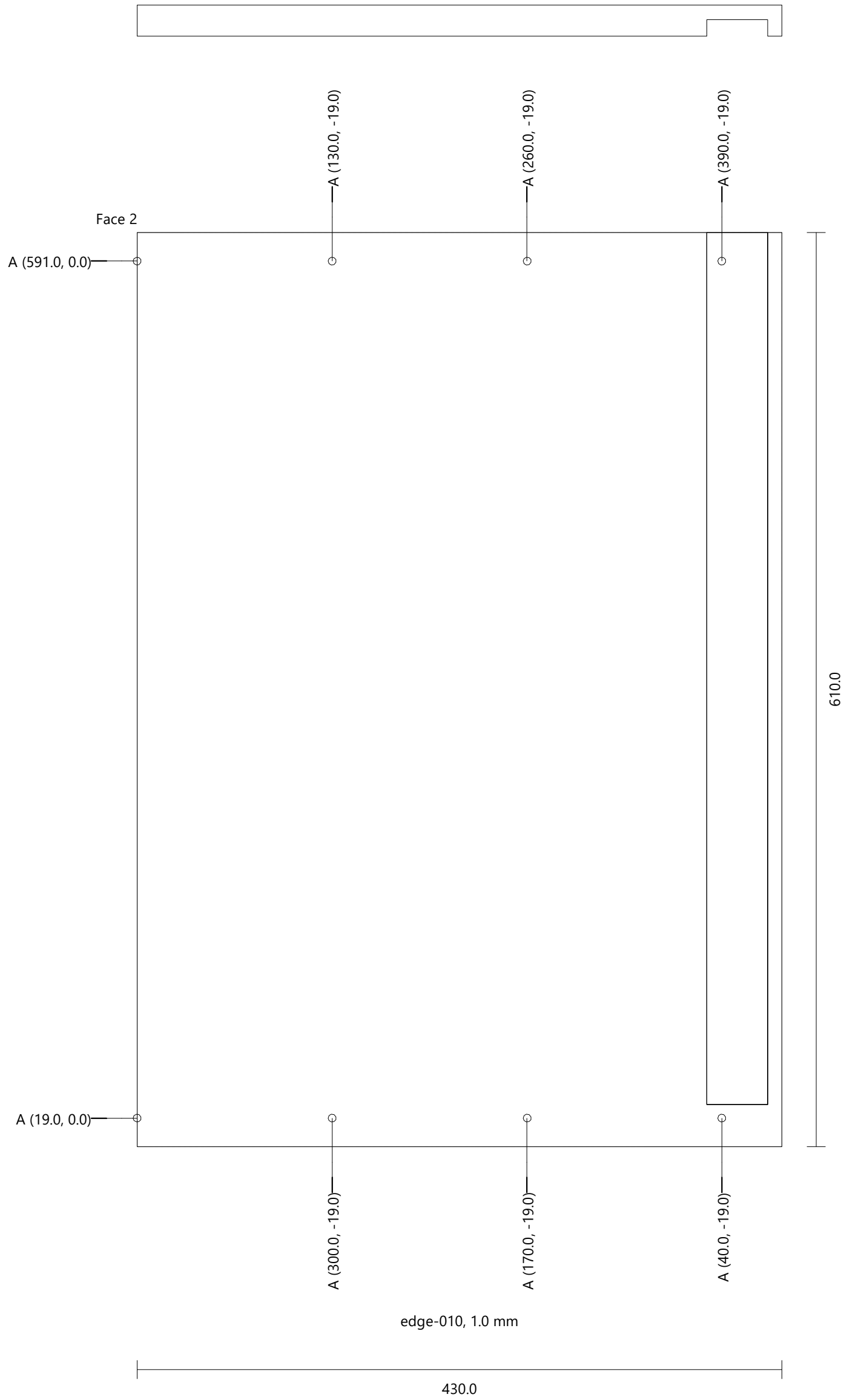

Cabinet2					
Right Side_1		generic 0380	Height: 610.0	Width: 40.0	Thickness: 38.0
Drilling	A (2)	Diameter: 5.0	Depth: Through (0.0)		Quantity: 1

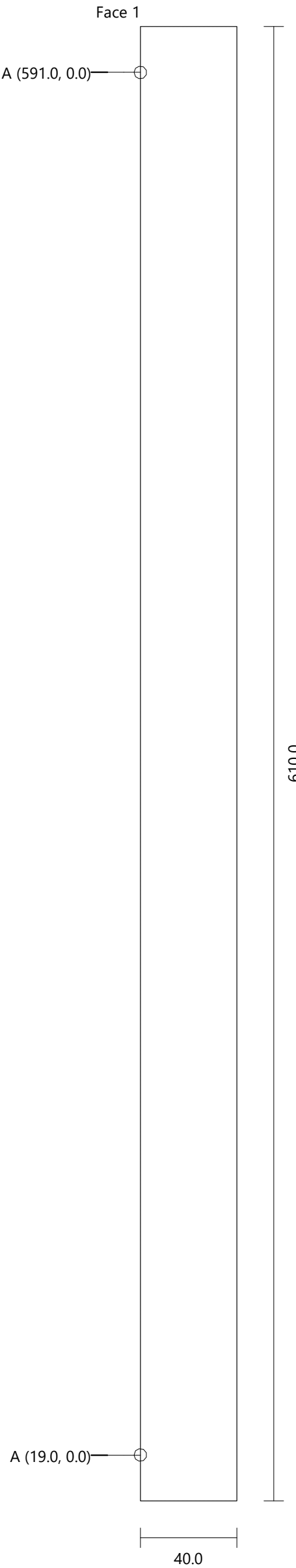

Quantity: 1

Depth: Through (0.0)

Depth: 9.5

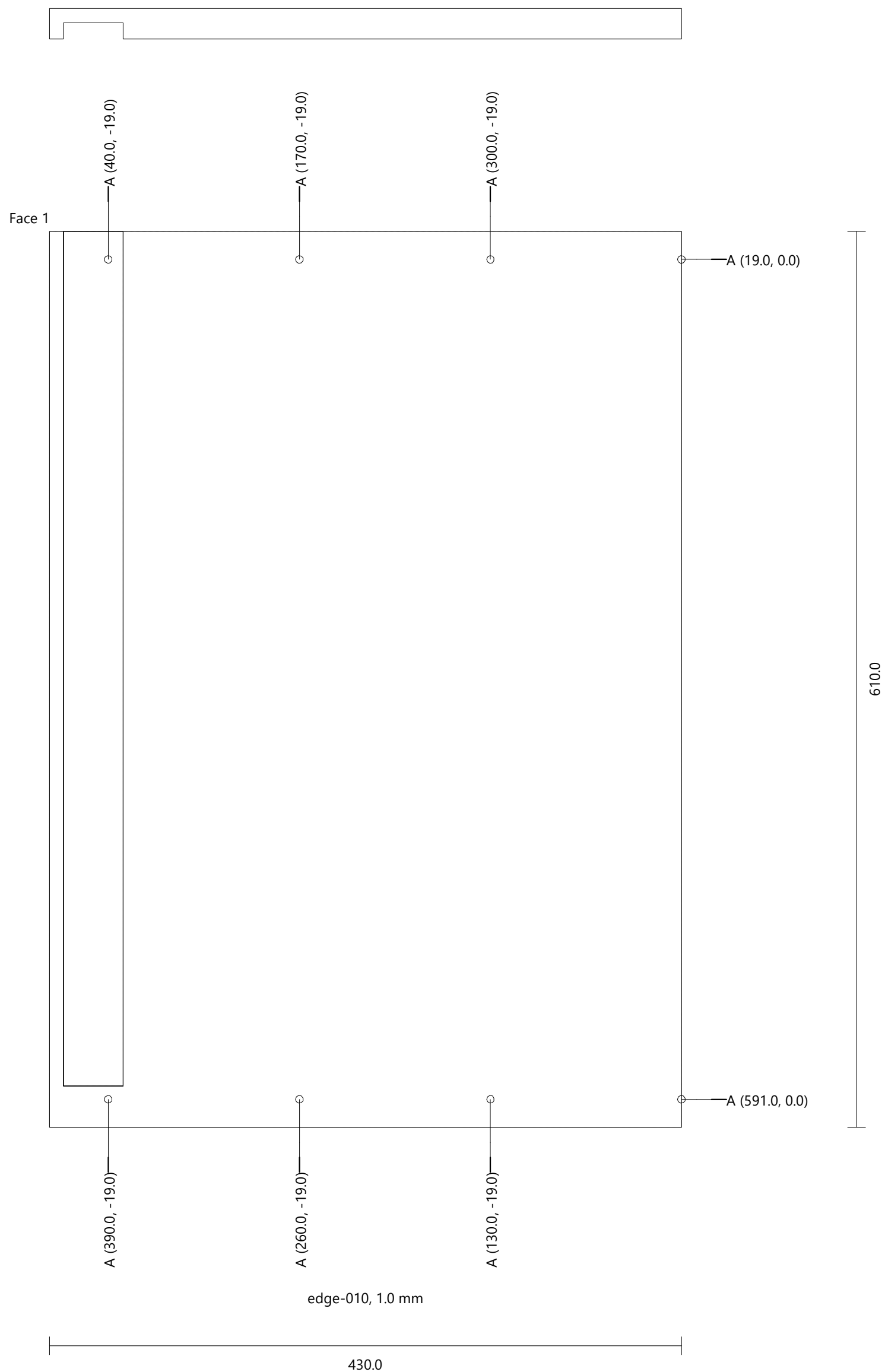

Cabinet2					
Back	generic 018 oak noseing	Height: 592.0	Width: 544.0	Thickness: 40.0	Quantity: 1

Face 1



544.0

Cabinet2					
Fixed Shelf [1]_1	generic 0380	Height: 524.0	Width: 40.0	Thickness: 38.0	Quantity: 1

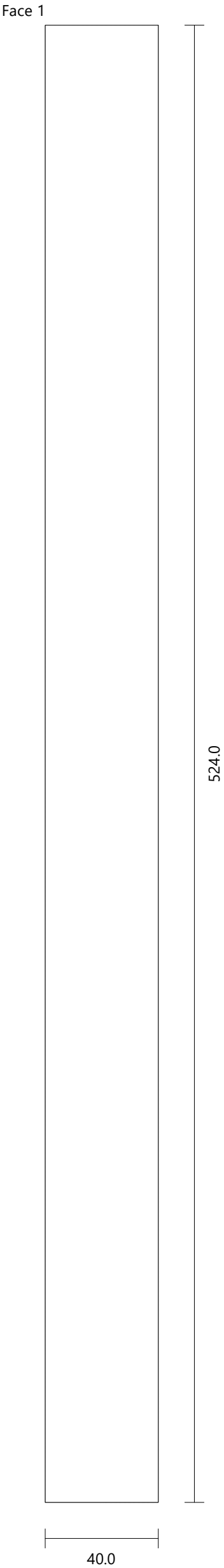

Cabinet2

Fixed Shelf [1]\_2

generic 0180

Height: 524.0

Width: 380.0

Thickness: 18.0

Quantity: 1

Face 1

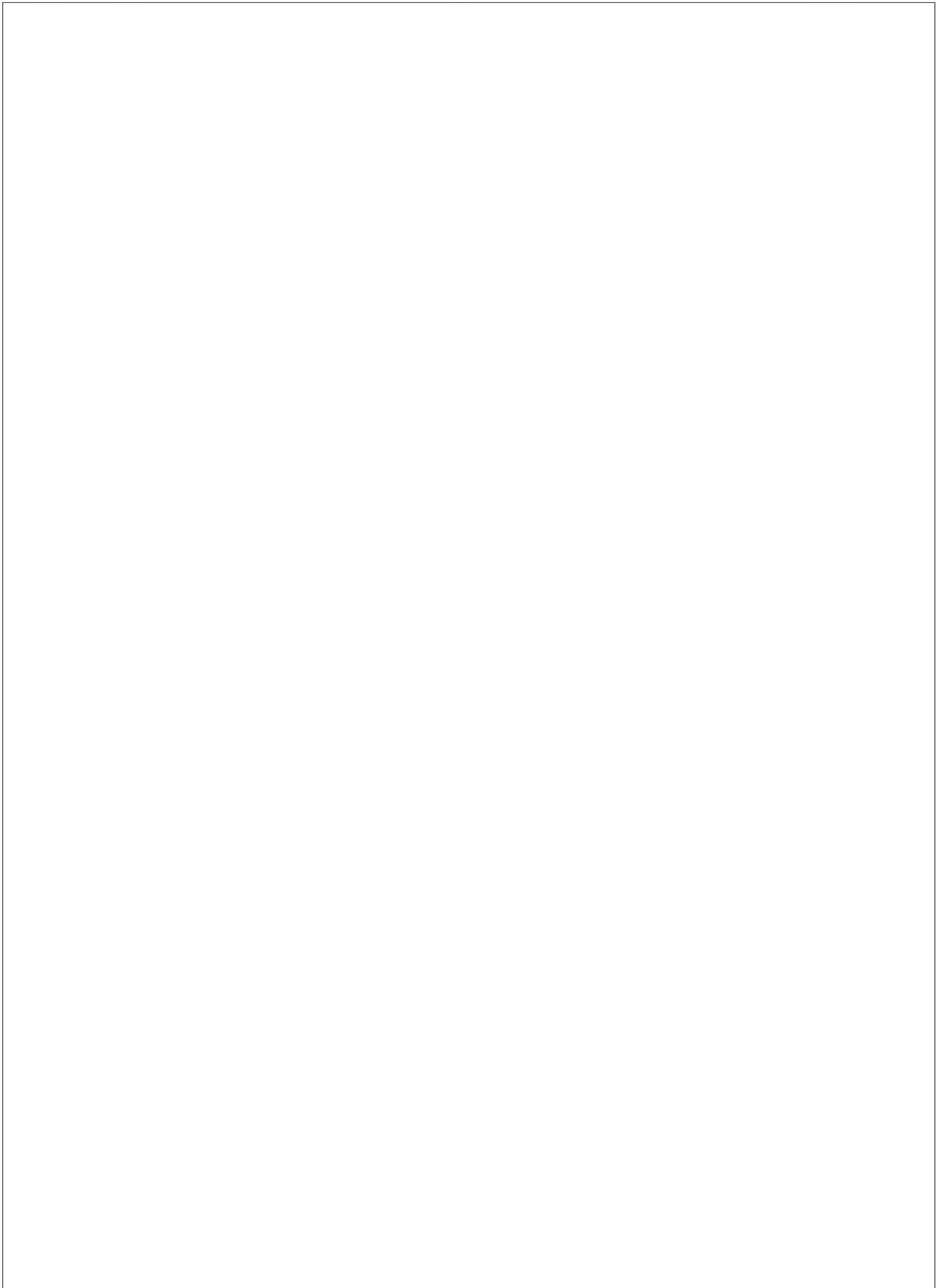

524.0

380.0

Cabinet2						
Door Eku-clipo (Double) [1]_1	generic 0380	Height: 528.0	Width: 255.5	Thickness: 38.0		Quantity: 1
Drilling	A (2)	Diameter: 5.0	Depth: Through (0.0)			

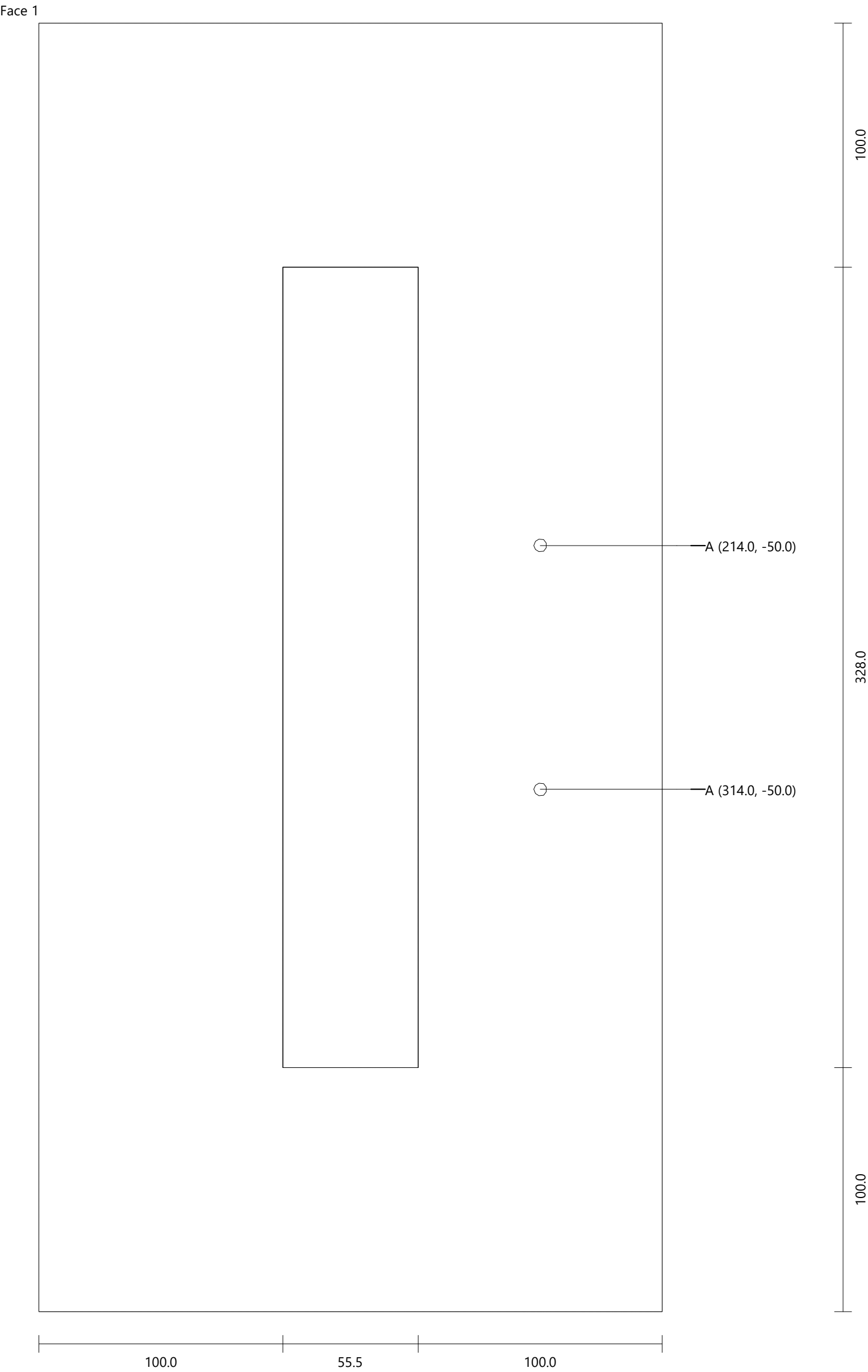



Cabinet2						
Door Eku-clipo (Double) [1]_2	generic 0380	Height: 528.0	Width: 255.5	Thickness: 38.0		Quantity: 1
Drilling	A (2)	Diameter: 5.0	Depth: Through (0.0)			

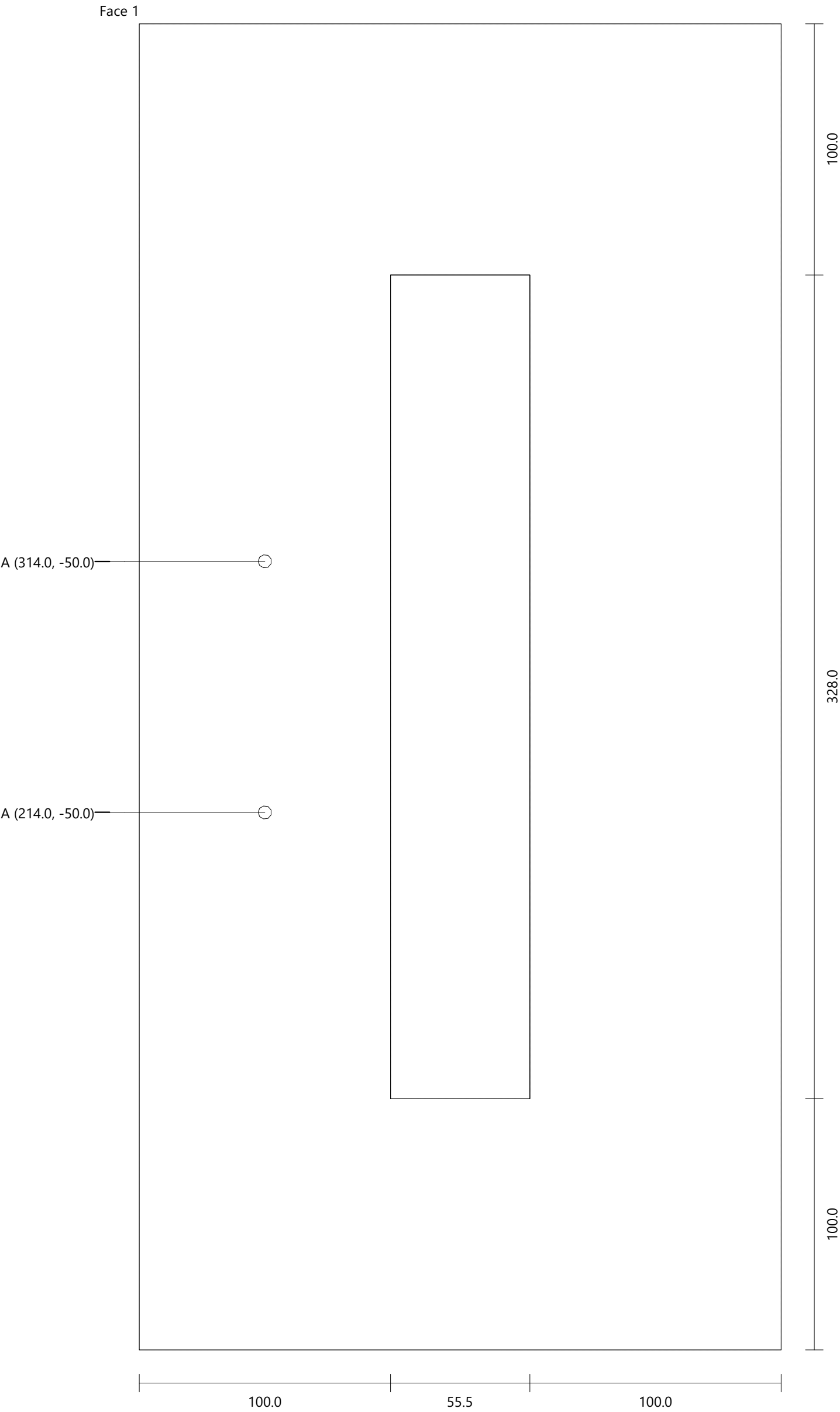

Cabinet2					
Plinth 1 [1]	generic 0380	Height: 604.0	Width: 150.0	Thickness: 38.0	Quantity: 1

Face 1

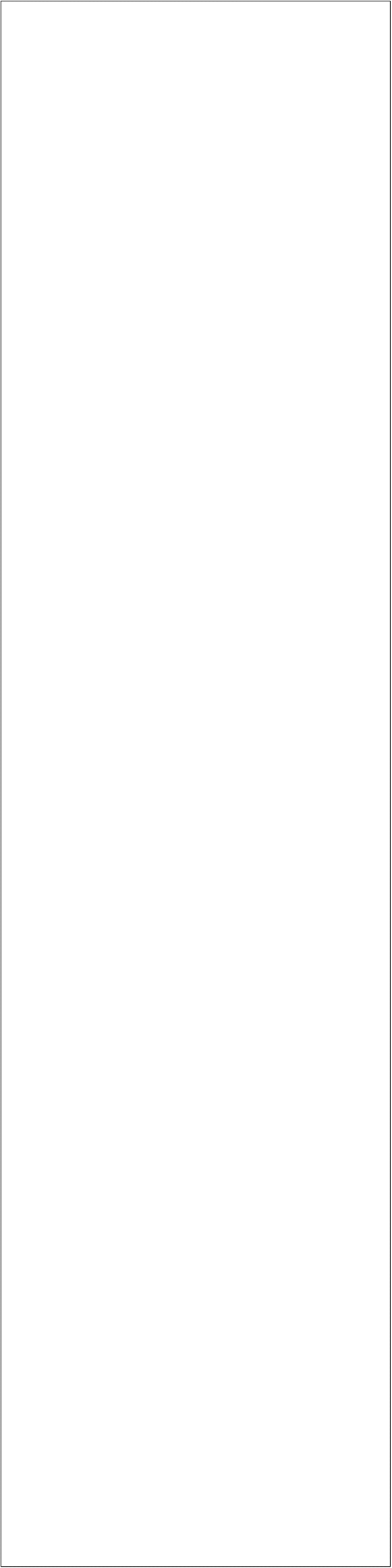

604.0

150.0

Cabinet2					
Filler 1	generic 0380	Height: 760.0	Width: 40.0	Thickness: 38.0	Quantity: 2

