

Multi-Flight Stair		Riser Height	204.3 mm
Risers	14	Tread Width	227.0 mm
Floor Height	2860.0 mm	Stair Rule	635.6 mm

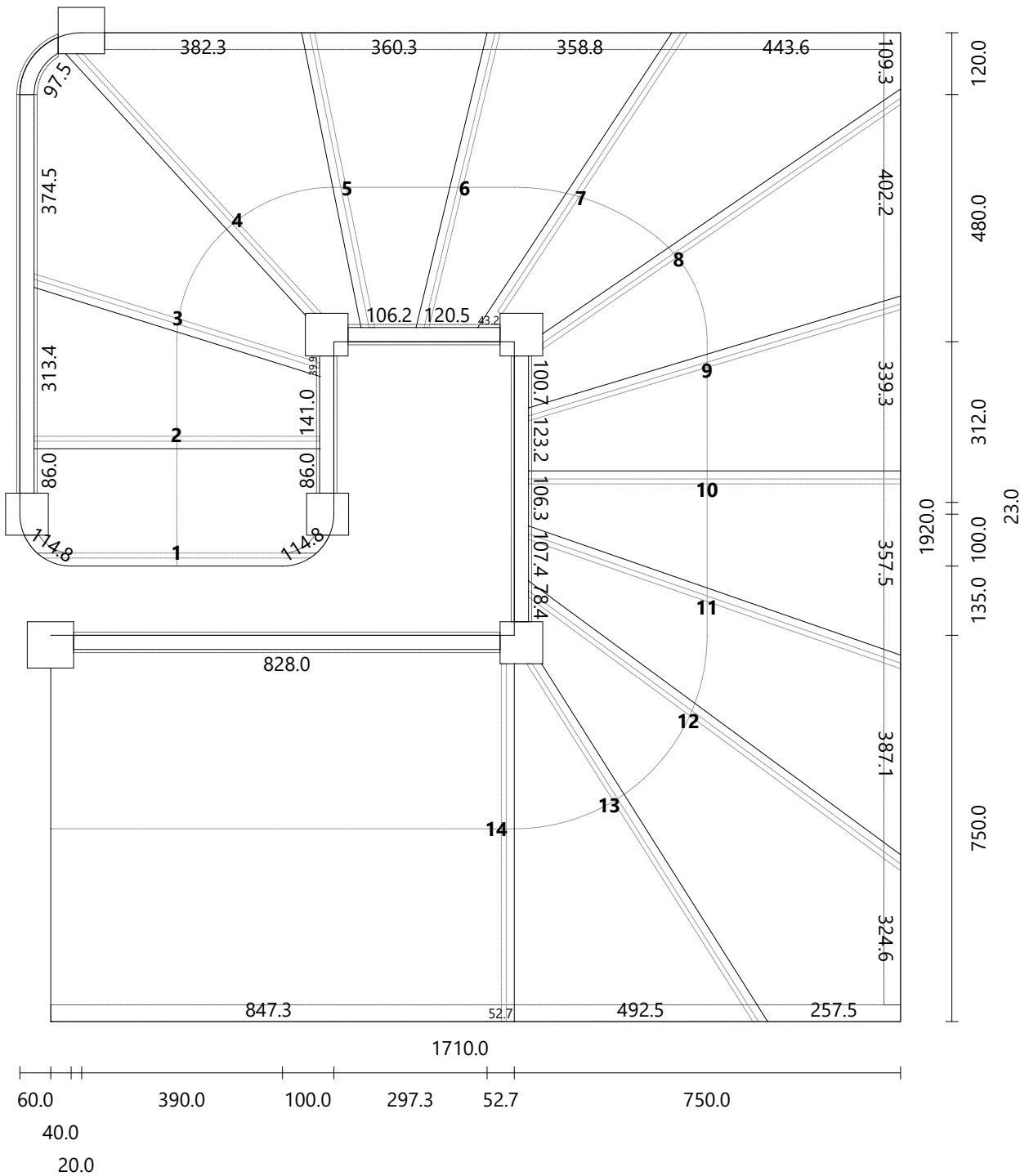

Step

Material Pine
 Dimensions 592.4 × 242.0 mm
 Thickness 22.0 mm

Riser

Material Pine
 Dimensions 542.3 × 187.3 mm
 Thickness 10.0 mm
 Angle Left: 53.4° | Right: -53.4°

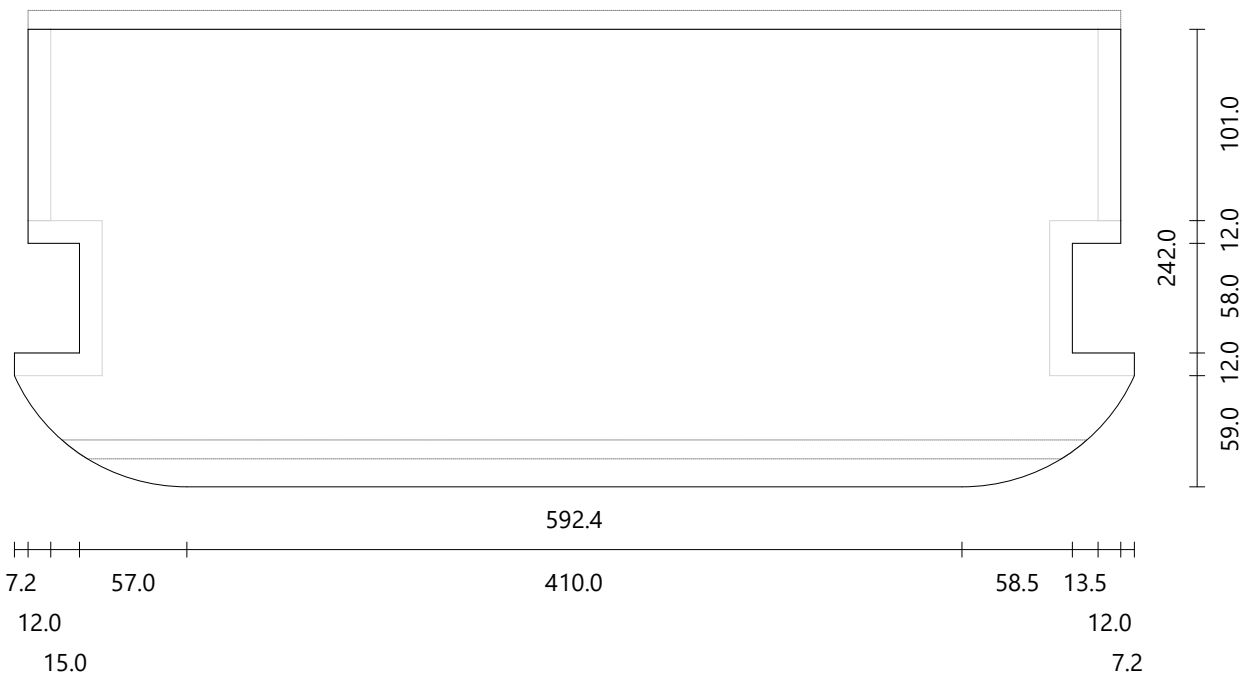

Step

Material Pine
Dimensions 578.0 × 332.9 mm
Thickness 22.0 mm

Riser

Material Pine
Dimensions 578.0 × 209.3 mm
Thickness 10.0 mm
Angle 0°

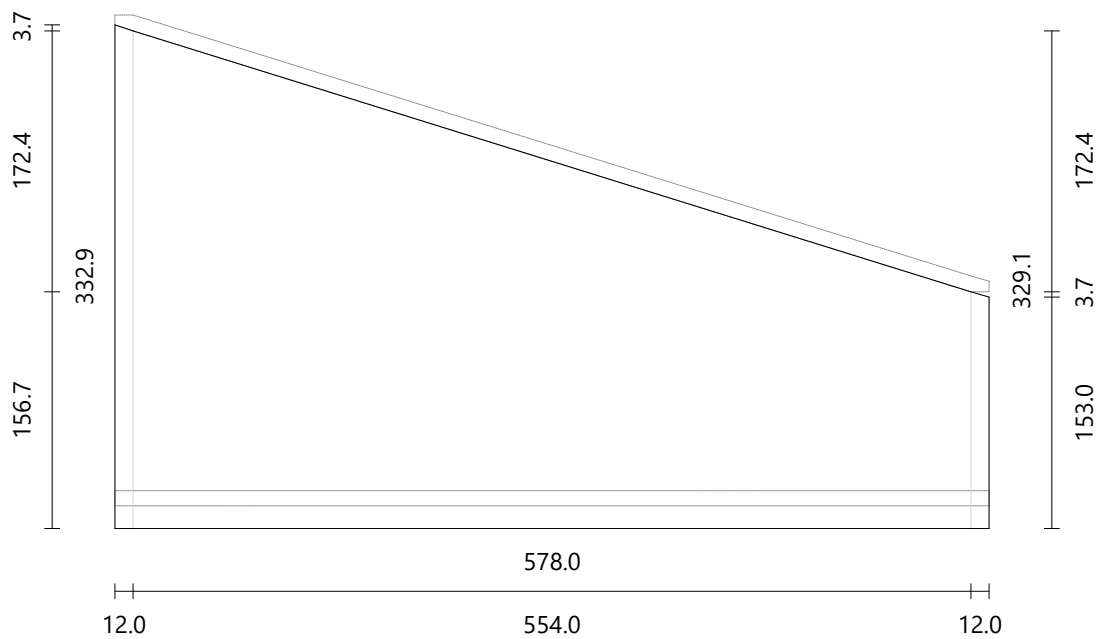

Step

Material Pine
Dimensions 719.1 × 465.8 mm
Thickness 22.0 mm

Riser

Material Pine
Dimensions 606.2 × 209.3 mm
Thickness 10.0 mm

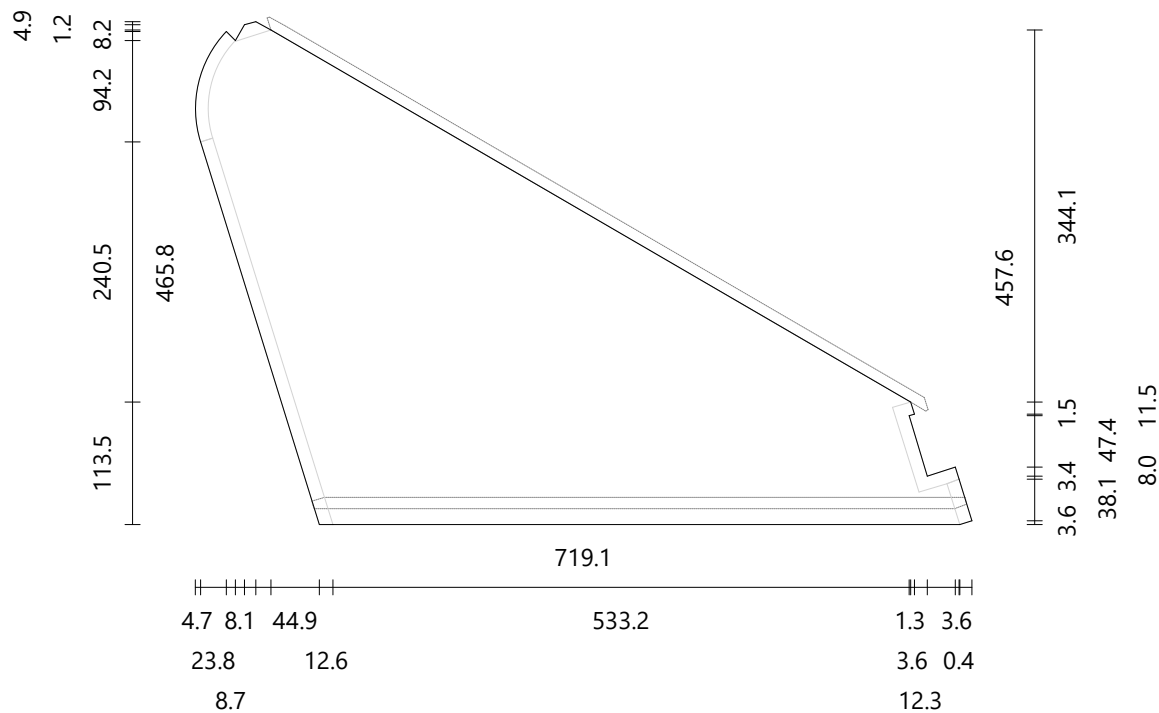

Step

Material Pine
 Dimensions 809.6 × 376.5 mm
 Thickness 22.0 mm

Riser

Material Pine
 Dimensions 711.6 × 209.3 mm
 Thickness 10.0 mm

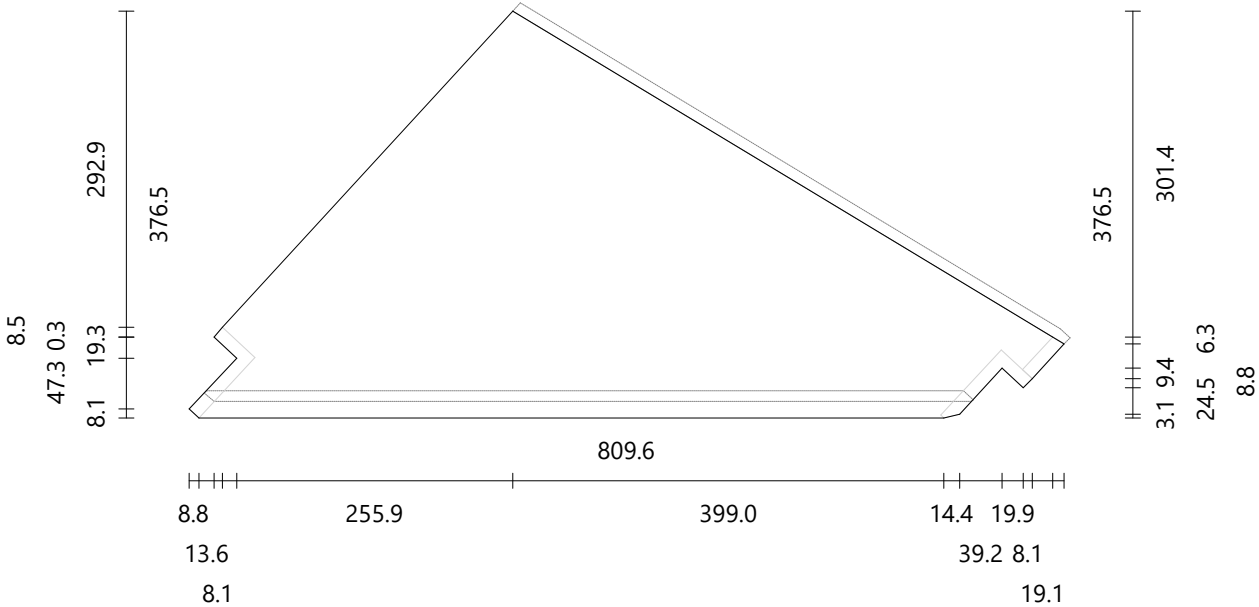

Step

Material Pine
Dimensions 618.9 × 368.2 mm
Thickness 22.0 mm

Riser

Material Pine
Dimensions 597.4 × 209.3 mm
Thickness 10.0 mm
Angle Left: -11.44°

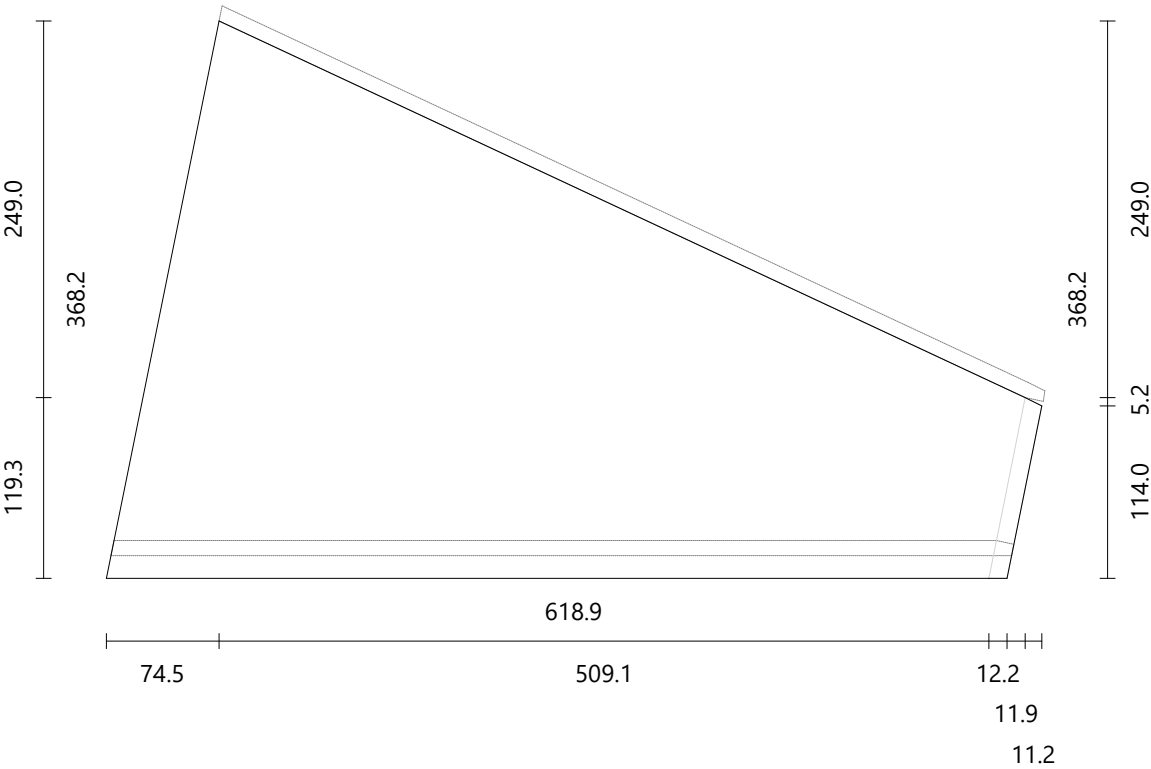

Step

Material Pine
Dimensions 688.6 × 366.3 mm
Thickness 22.0 mm

Riser

Material Pine
Dimensions 602.5 × 209.3 mm
Thickness 10.0 mm
Angle Left: 13.59°

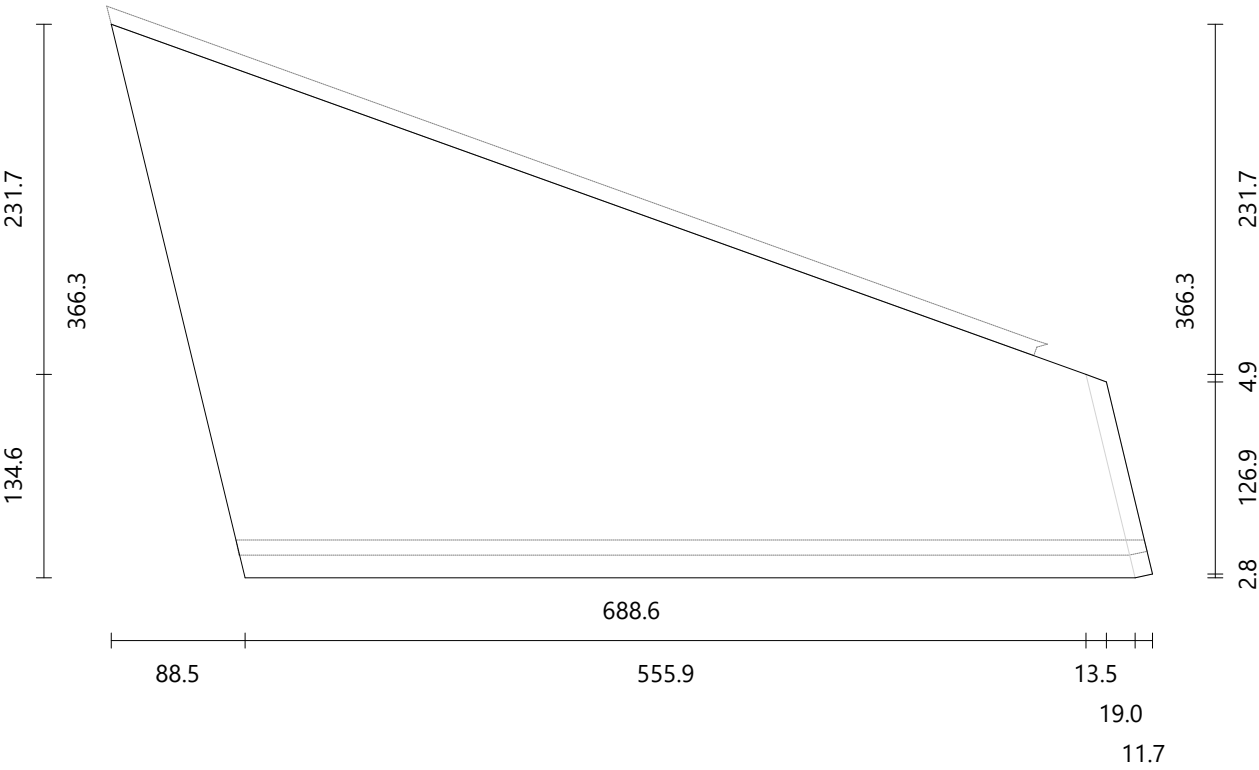

Step

Material Pine
Dimensions 938.8 × 440.6 mm
Thickness 22.0 mm

Riser

Material Pine
Dimensions 660.7 × 209.3 mm
Thickness 10.0 mm
Angle Left: 33.36° | Right: -29.82°

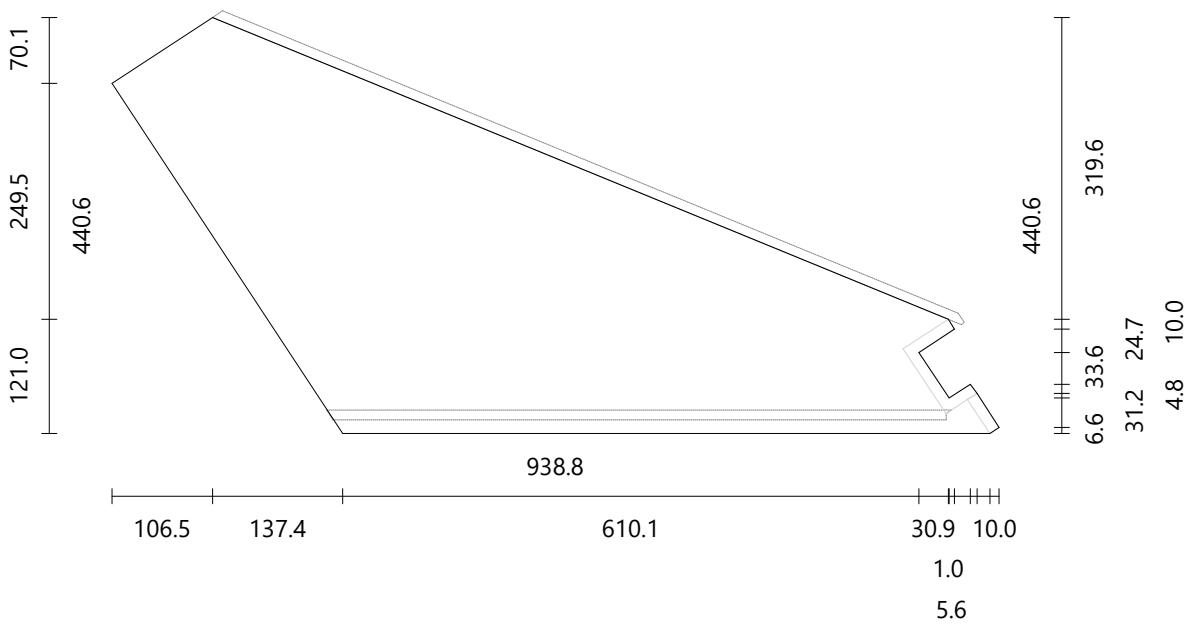

Step

Material Pine
 Dimensions 965.7 × 345.1 mm
 Thickness 22.0 mm

Riser

Material Pine
 Dimensions 858.2 × 209.3 mm
 Thickness 10.0 mm
 Angle Left: -34.32°

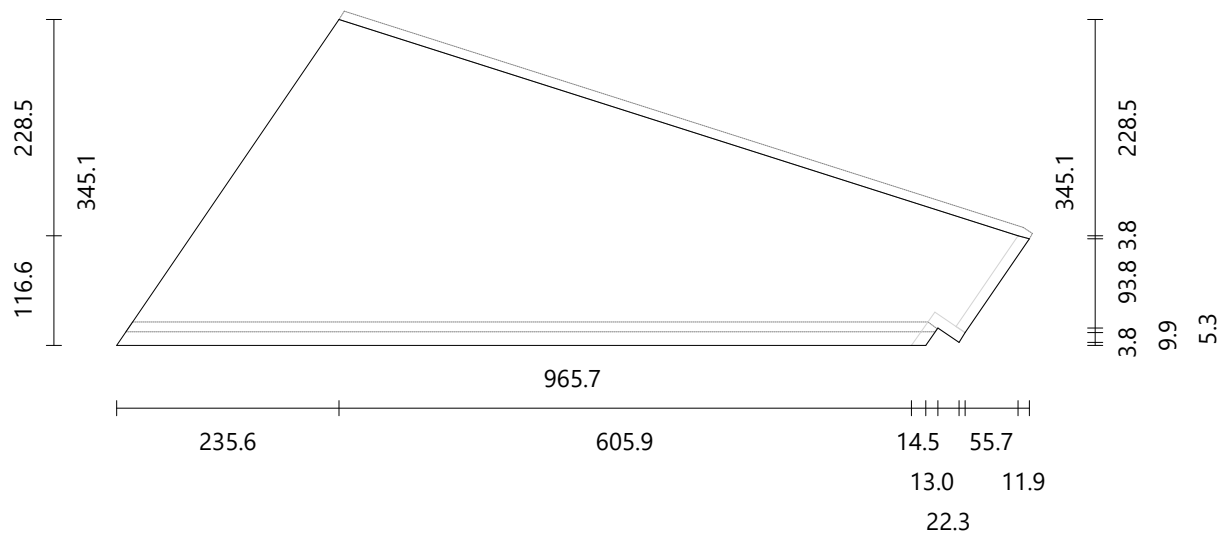

Step

Material Pine
Dimensions 804.8 × 339.4 mm
Thickness 22.0 mm

Riser

Material Pine
Dimensions 768.2 × 209.3 mm
Thickness 10.0 mm
Angle Left: -16.67°

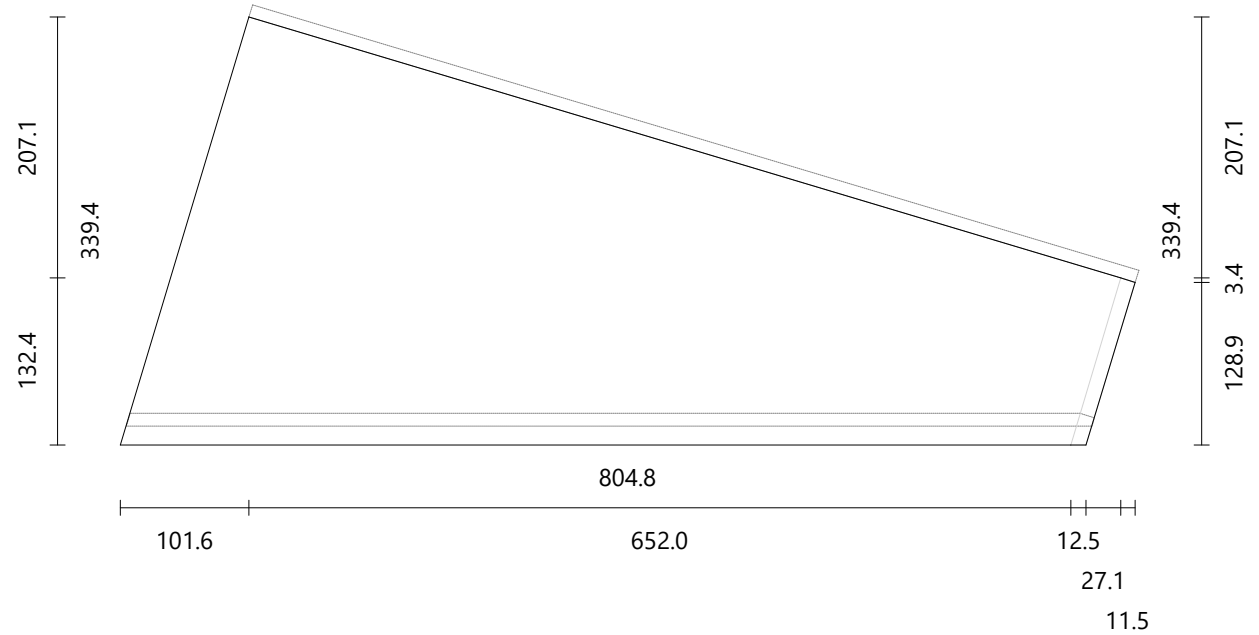

Step

Material Pine
Dimensions 734.0 × 373.4 mm
Thickness 22.0 mm

Riser

Material Pine
Dimensions 734.0 × 209.3 mm
Thickness 10.0 mm
Angle 0°

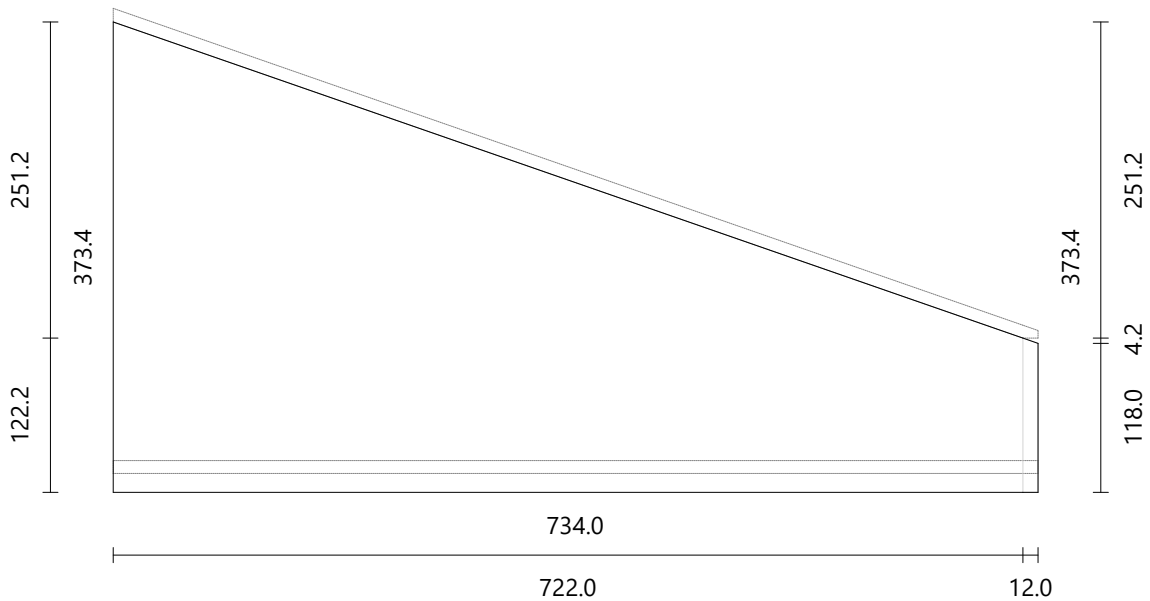

Step

Material Pine
Dimensions 909.1 × 383.1 mm
Thickness 22.0 mm

Riser

Material Pine
Dimensions 779.3 × 209.3 mm
Thickness 10.0 mm
Angle Left: 19.18°

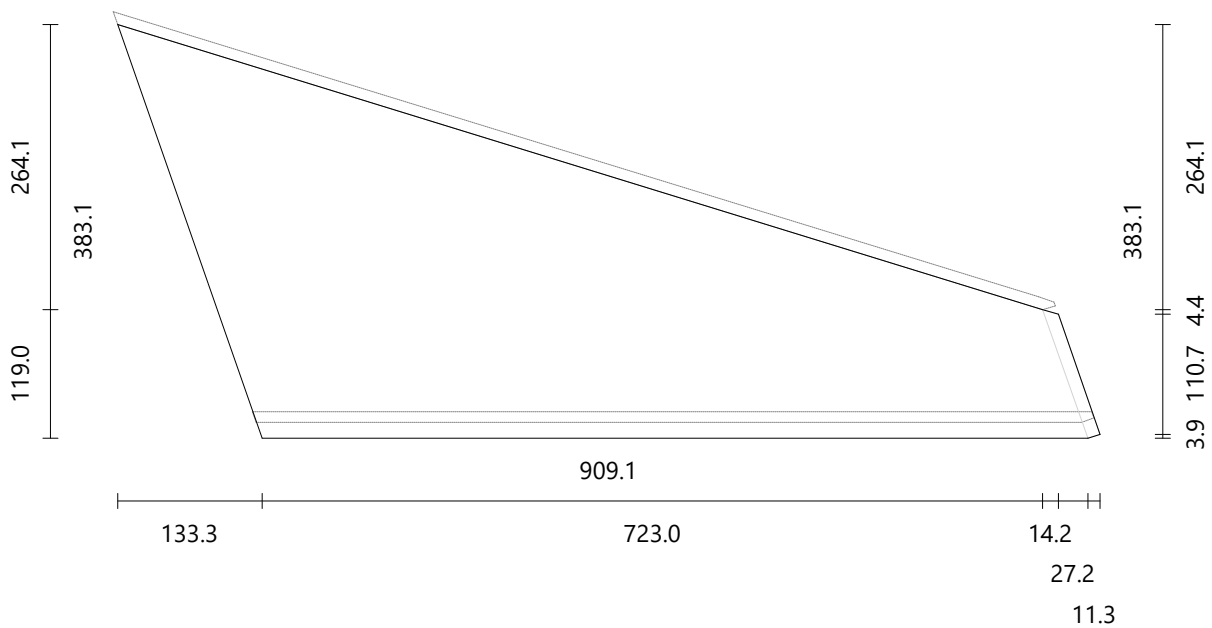

Step

Material Pine
 Dimensions 1098.1 × 424.5 mm
 Thickness 22.0 mm

Riser

Material Pine
 Dimensions 913.2 × 209.3 mm
 Thickness 10.0 mm
 Angle Left: 36.33°

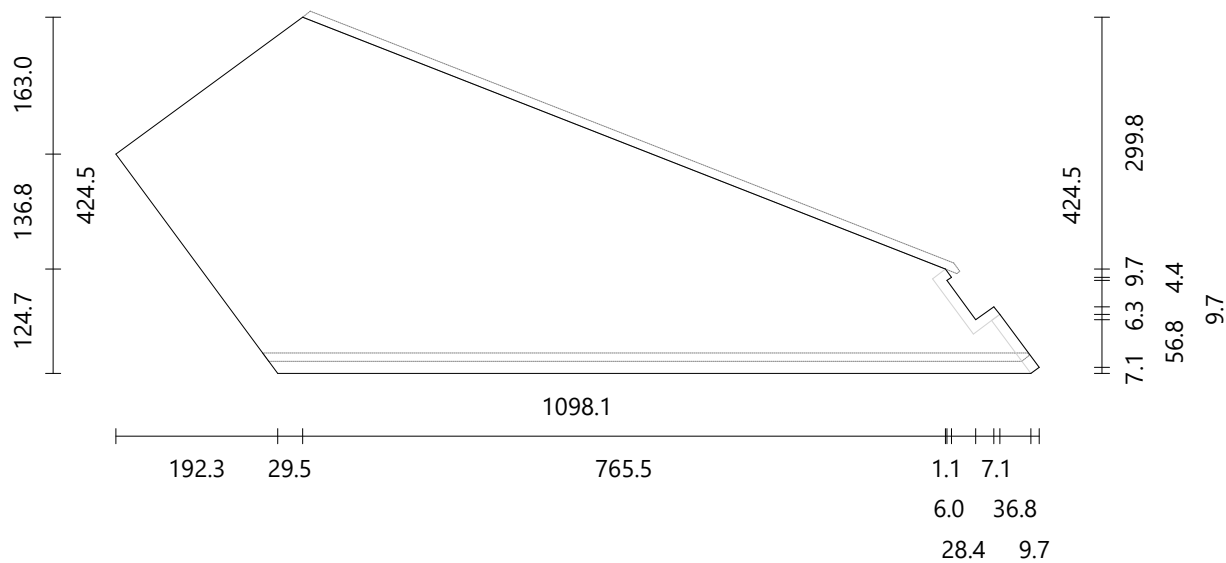

Step

Material Pine
 Dimensions 868.8 × 429.0 mm
 Thickness 22.0 mm

Riser

Material Pine
 Dimensions 838.6 × 209.3 mm
 Thickness 10.0 mm
 Angle Left: -32.29°

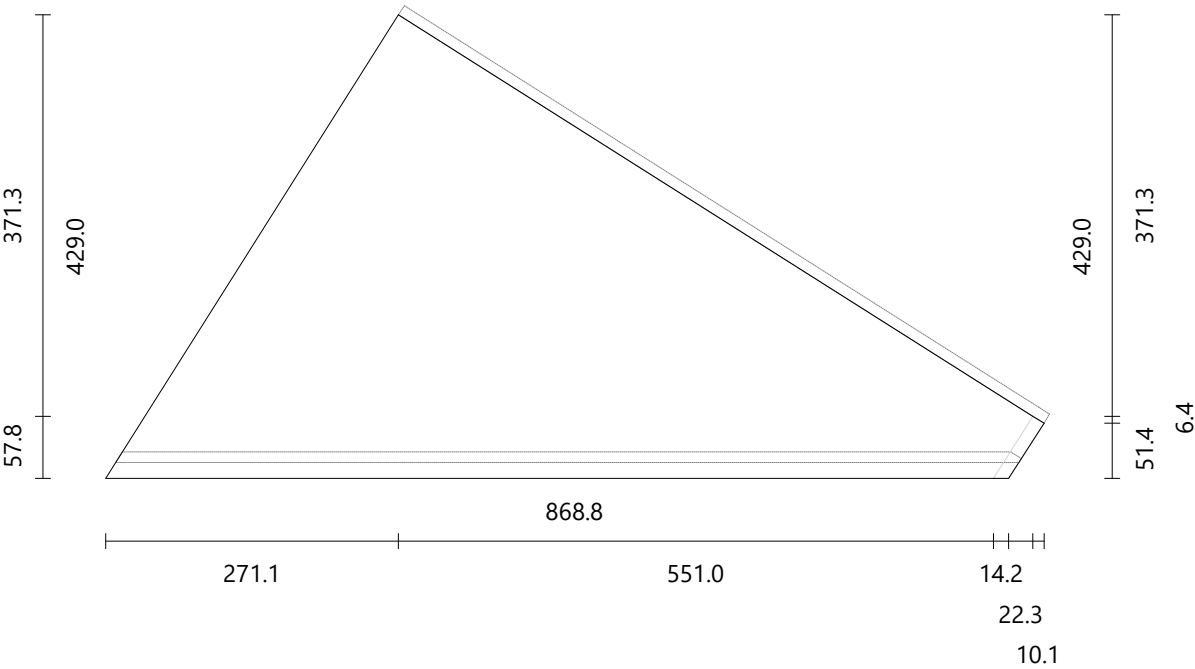

Step

Material Pine
 Dimensions 734.0 × 900.0 mm
 Thickness 22.0 mm

Riser

Material Pine
 Dimensions 707.0 × 209.3 mm
 Thickness 10.0 mm
 Angle 0°

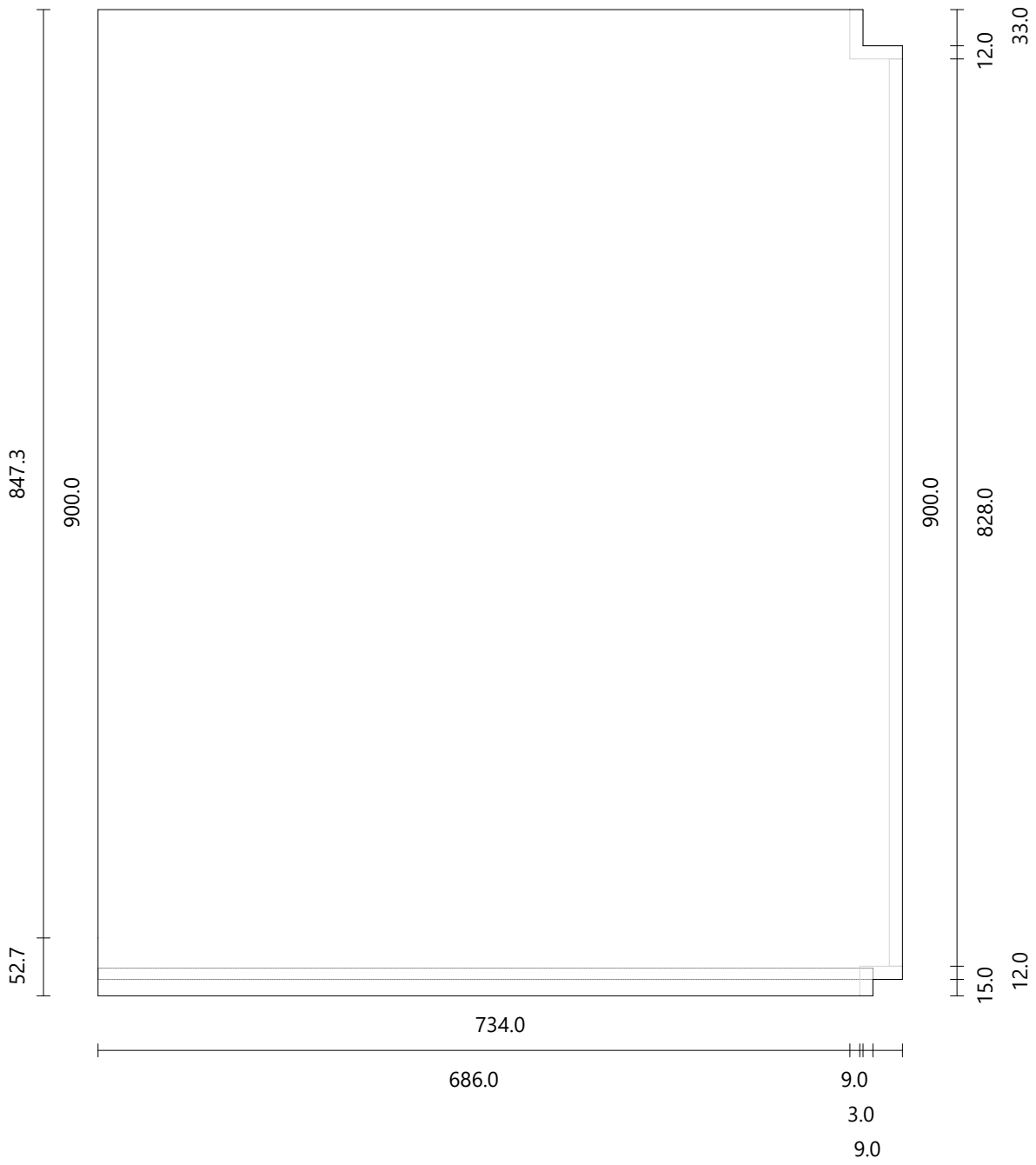

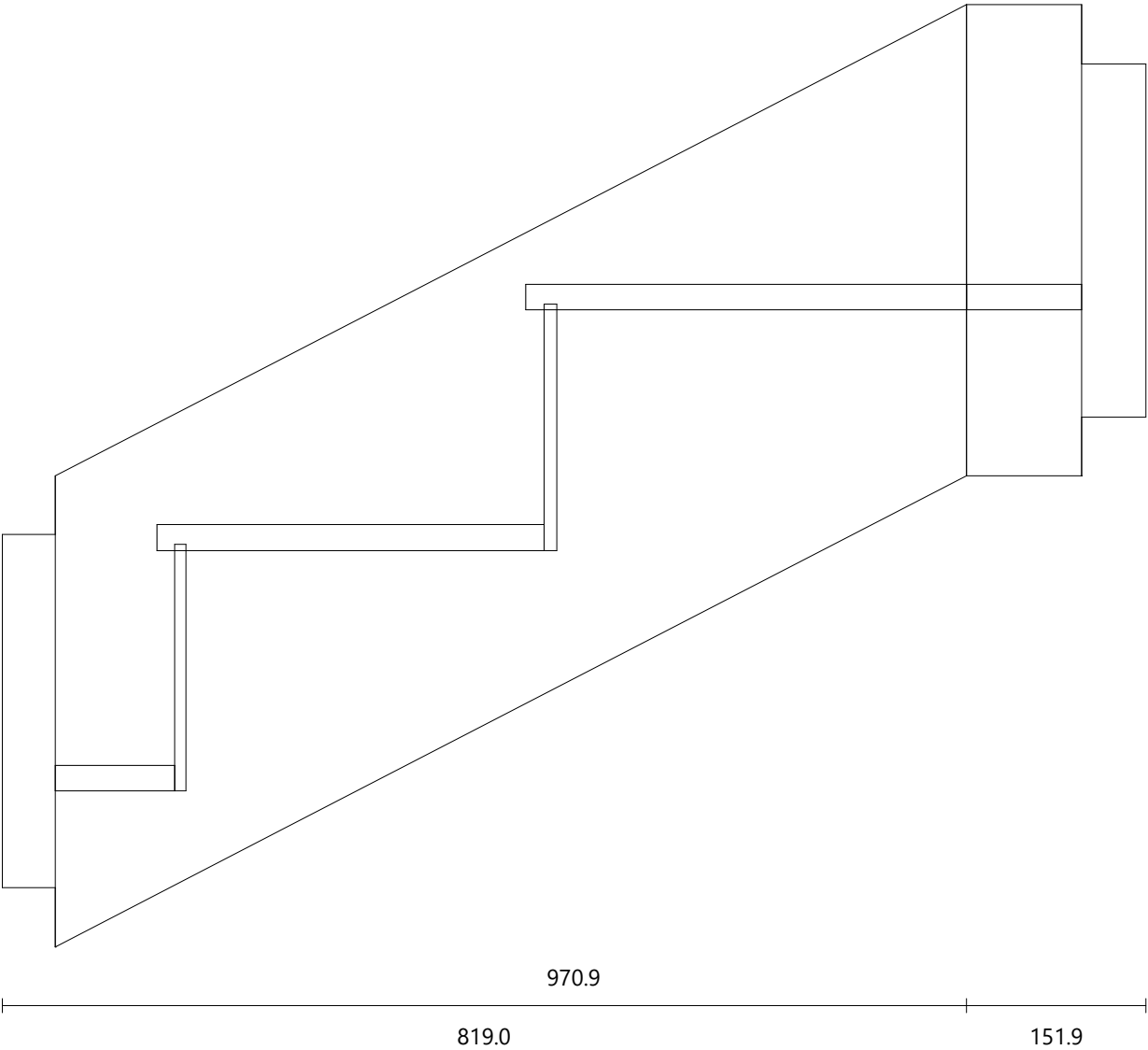

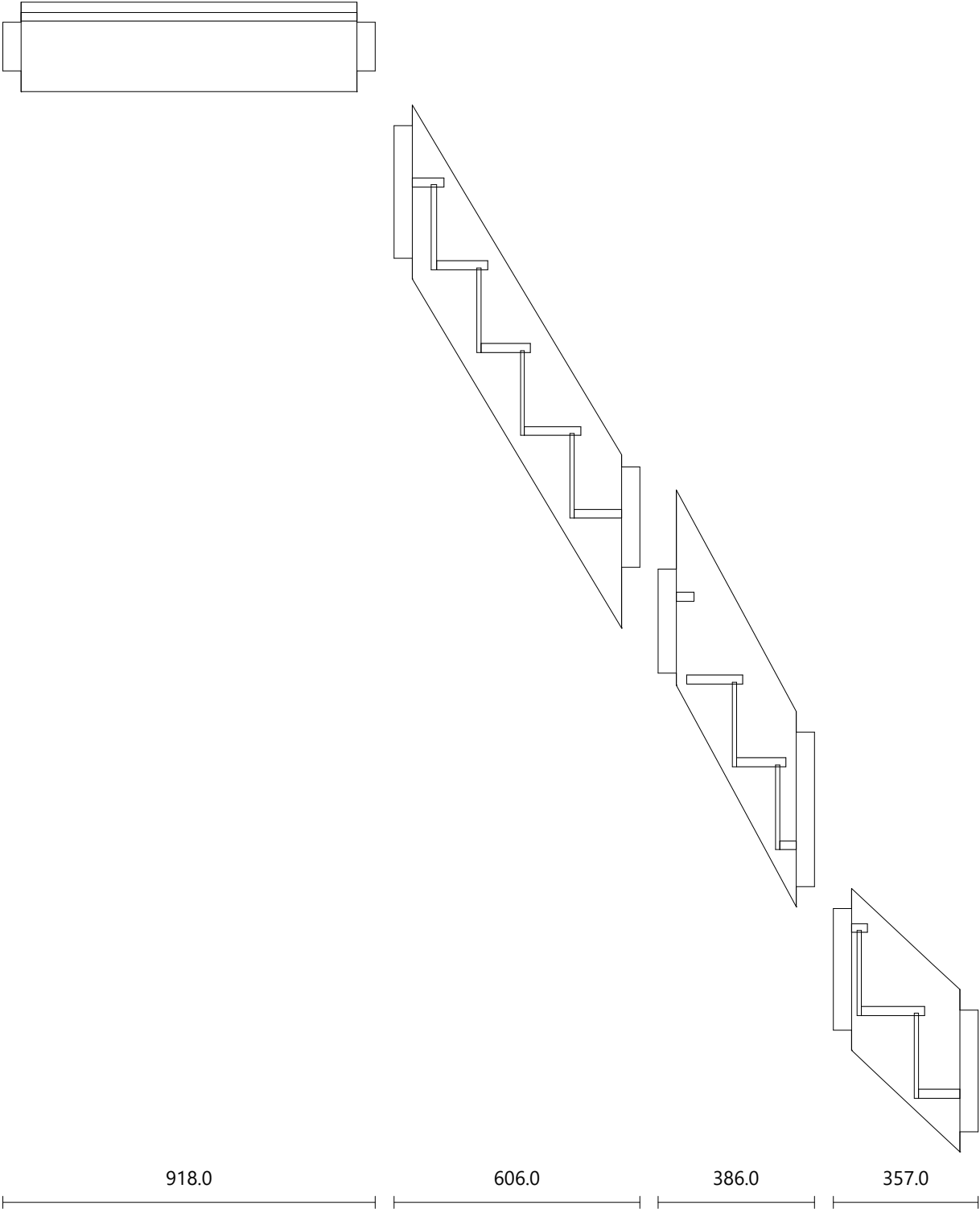

Material Pine
 Dimensions 1071.9 × 355.4 mm
 Thickness 28.0 mm

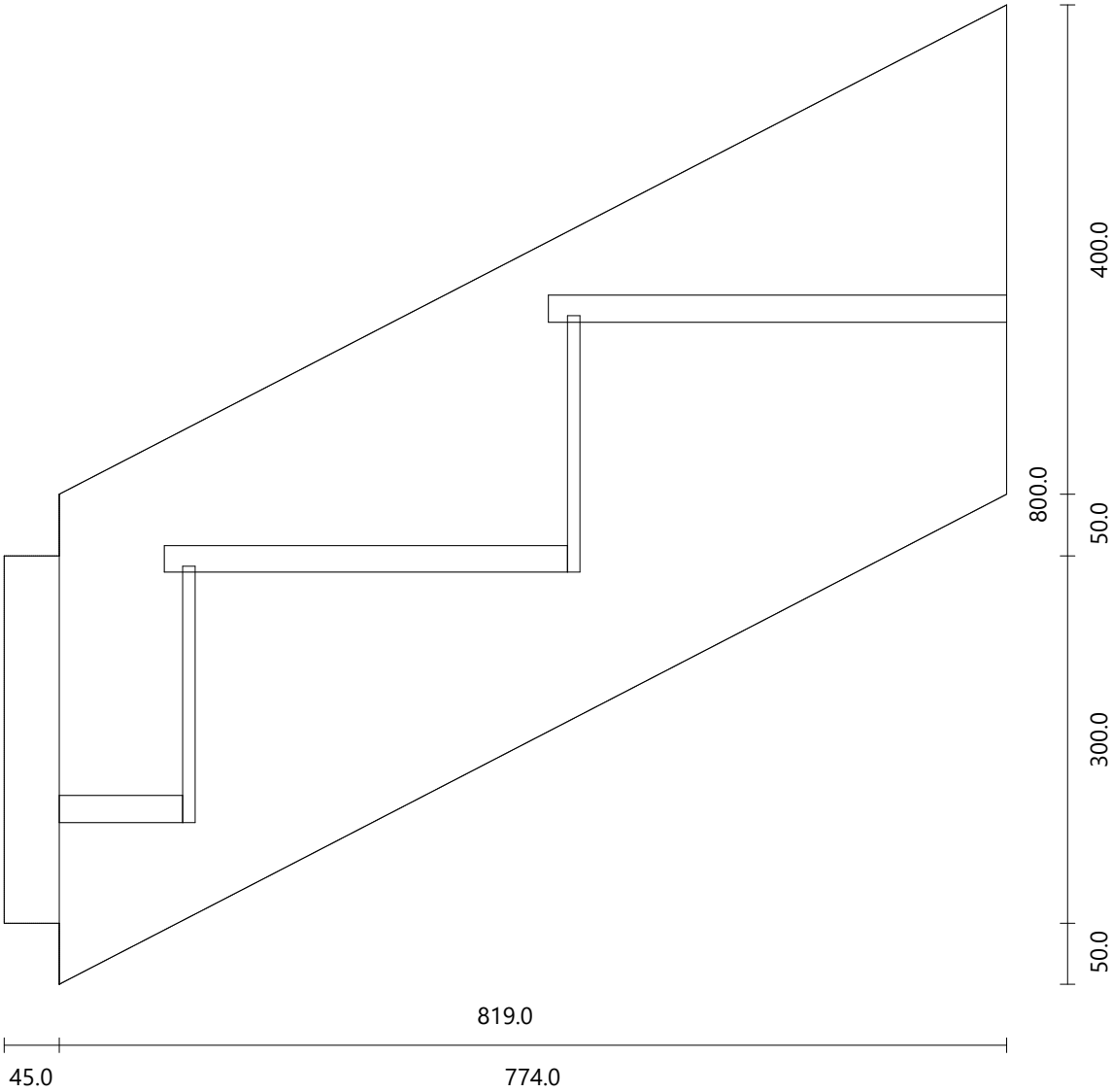

Material Pine
 Dimensions 183.6 × 400.0 mm
 Thickness 28.0 mm

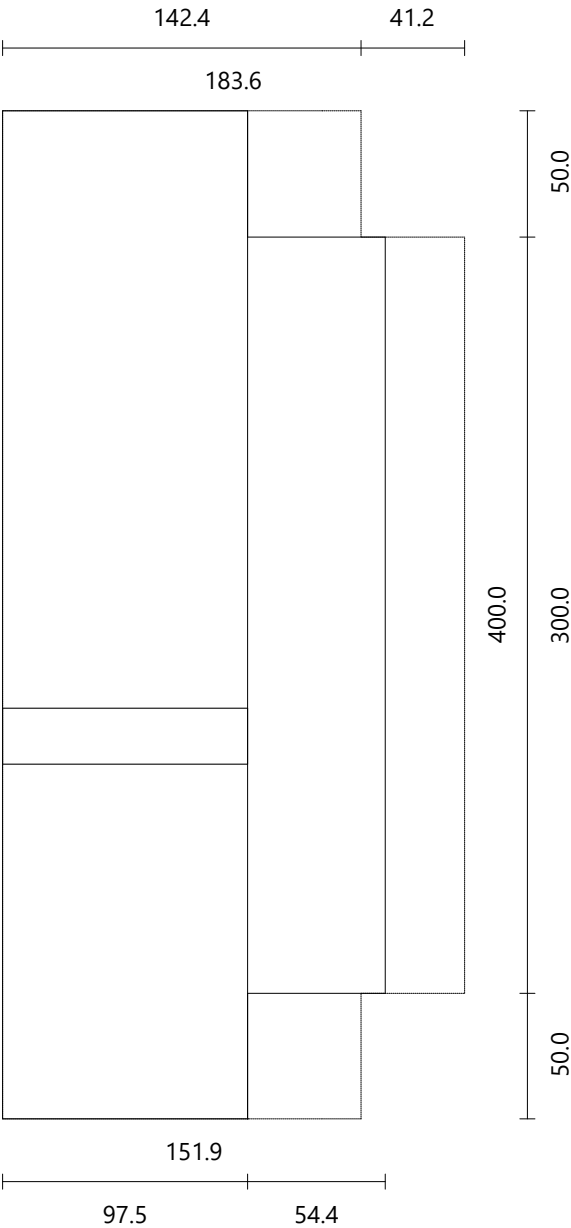

Material Pine
Dimensions 639.2 × 292.0 mm
Thickness 28.0 mm

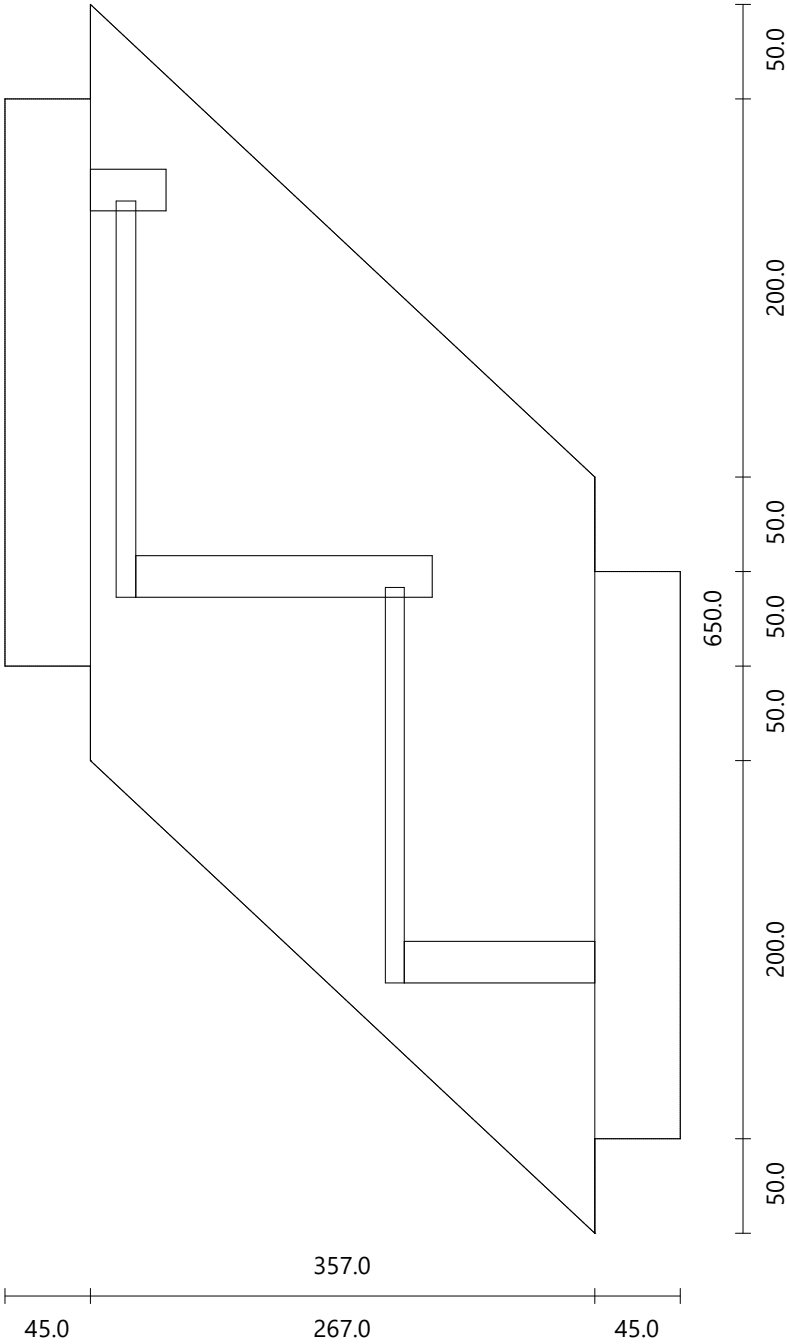

Material Pine
Dimensions 1039.2 × 263.2 mm
Thickness 28.0 mm

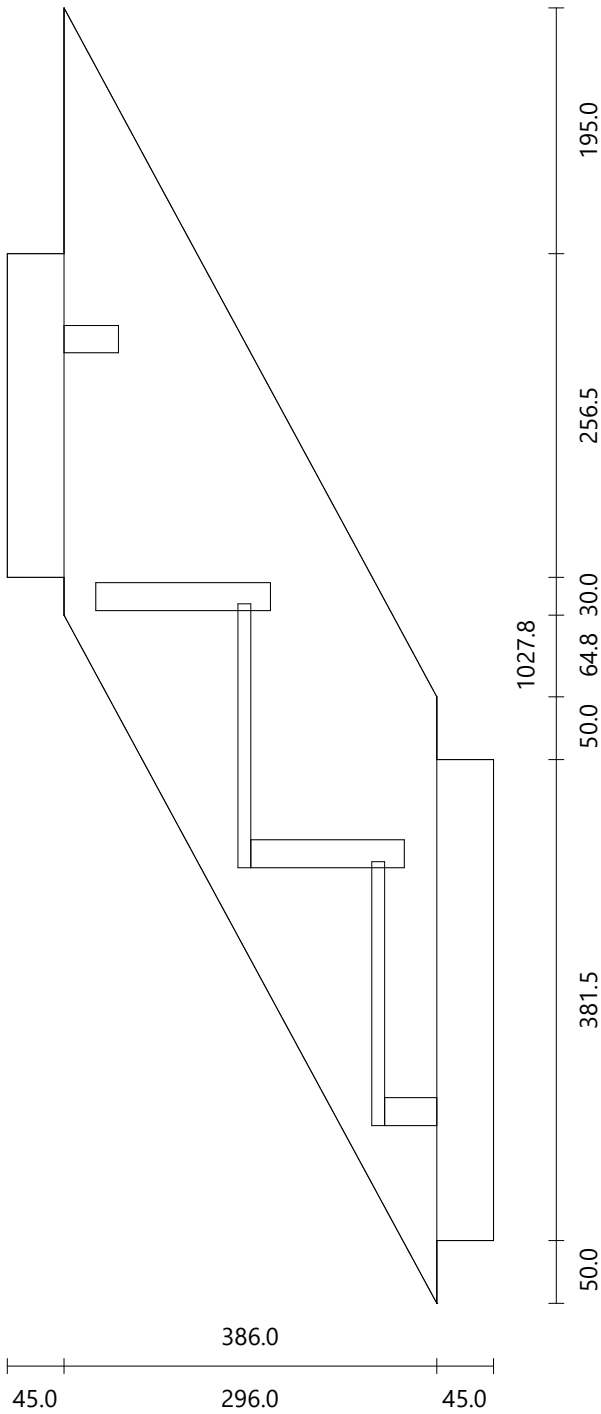

Material Pine
 Dimensions 1368.5 × 247.0 mm
 Thickness 28.0 mm

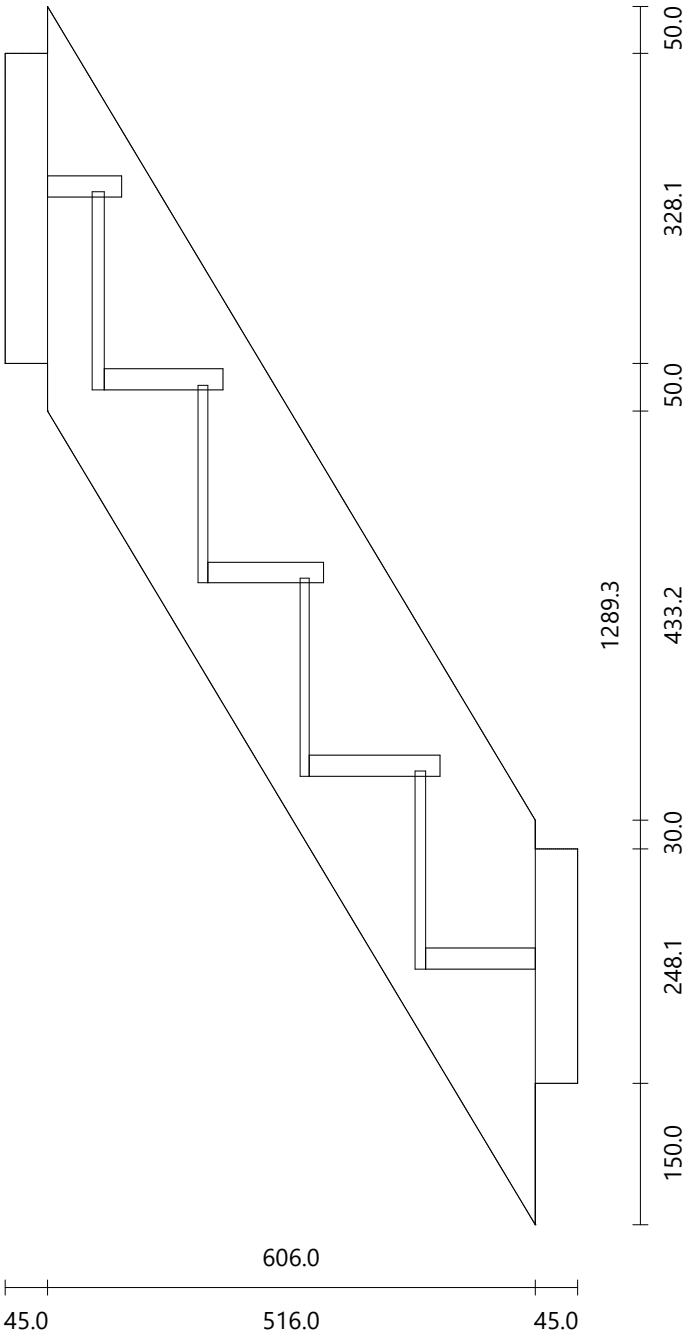

Material Pine
Dimensions 918.0 × 220.0 mm
Thickness 28.0 mm

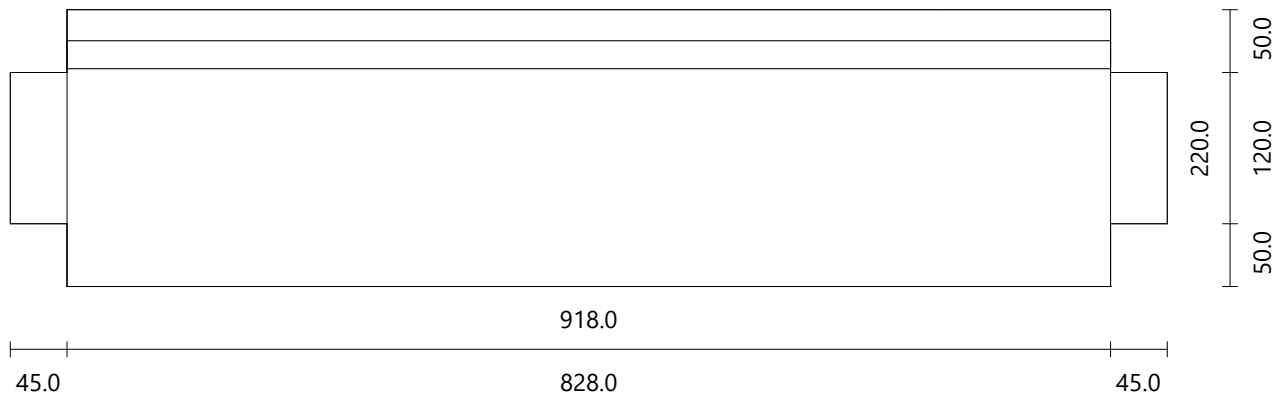

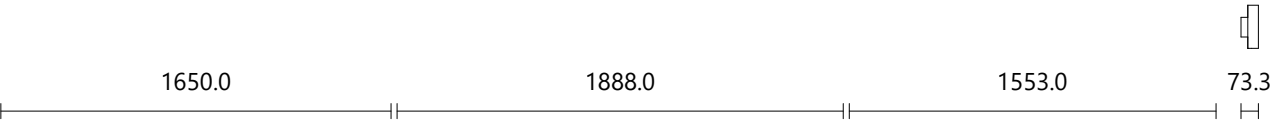
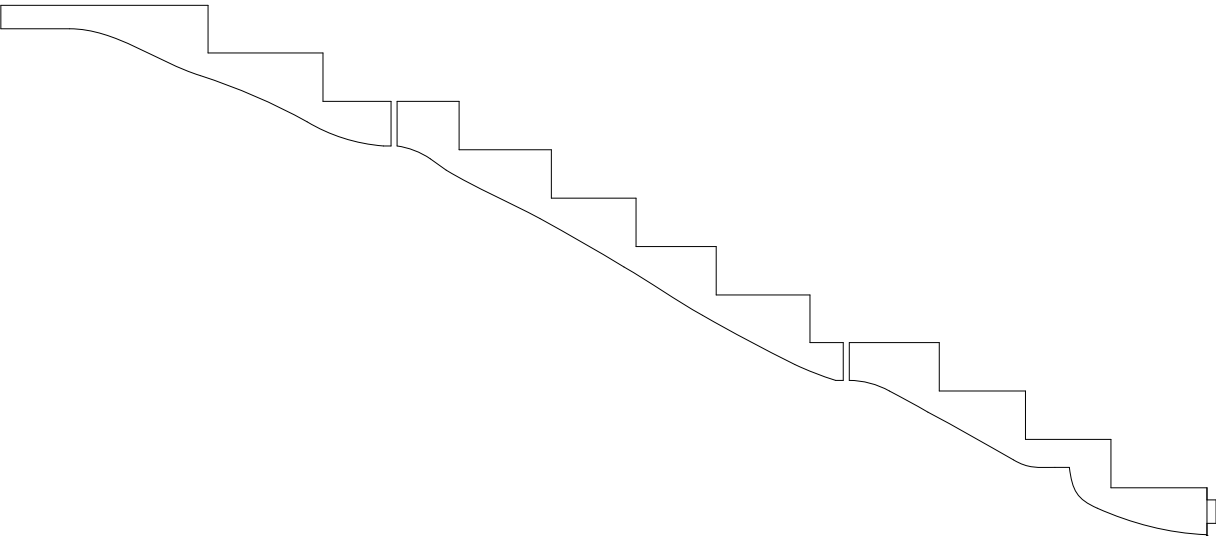

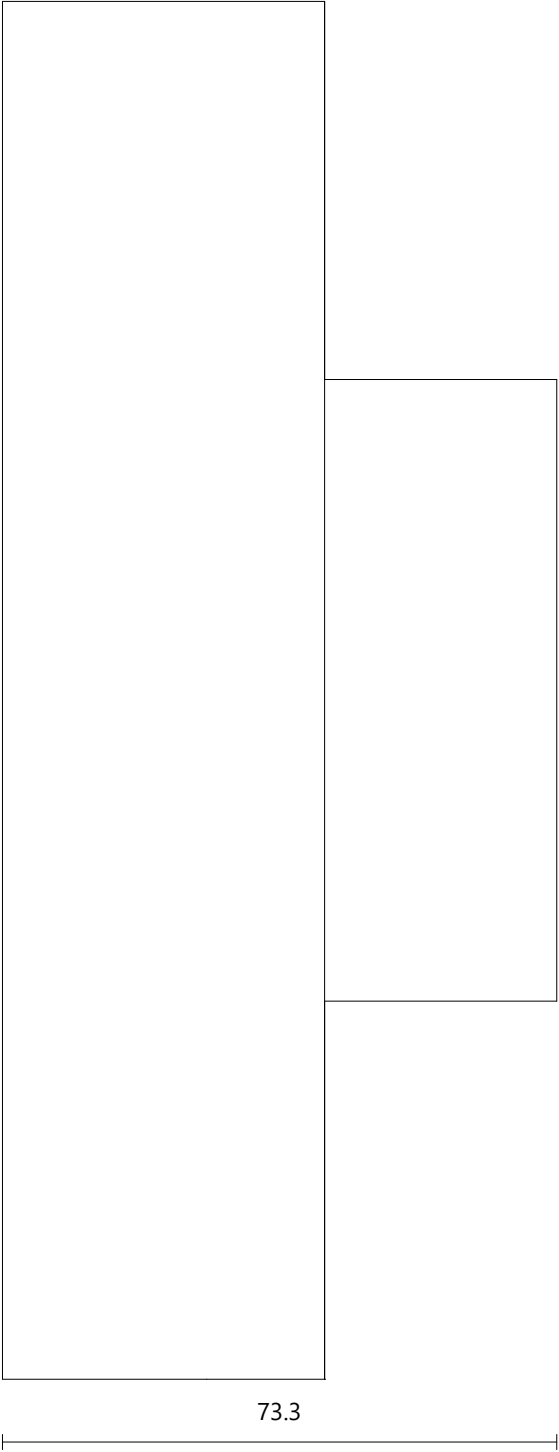

Material Pine
Dimensions 127.5 × 182.3 mm
Thickness 25.0 mm

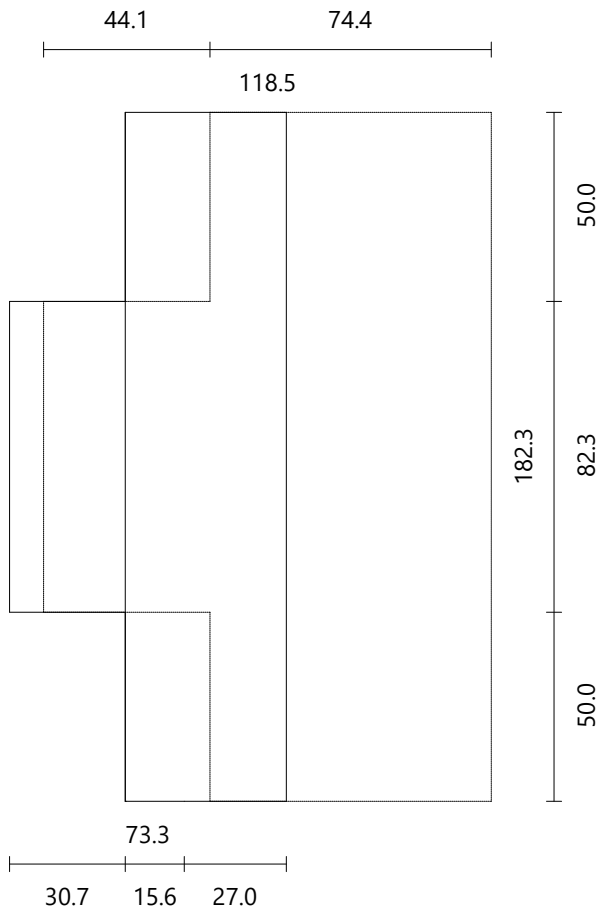

Material Pine
Dimensions 1730.0 × 325.0 mm
Thickness 32.0 mm

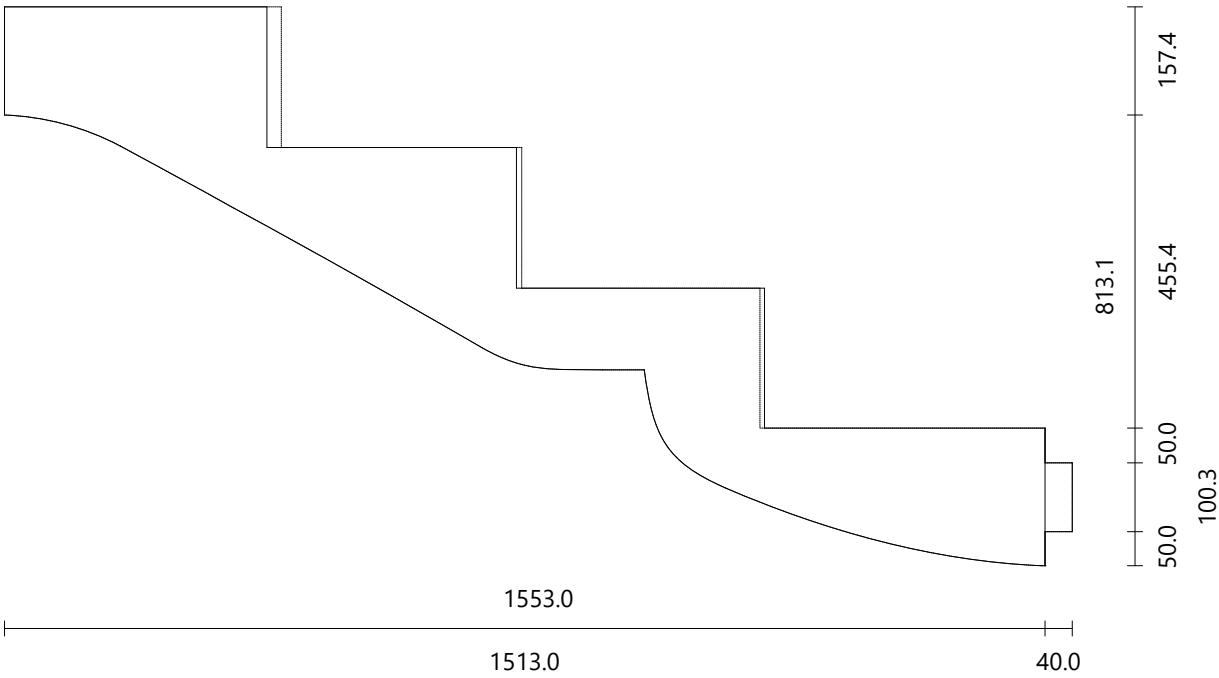

Material Pine
Dimensions 2222.8 × 308.5 mm
Thickness 32.0 mm

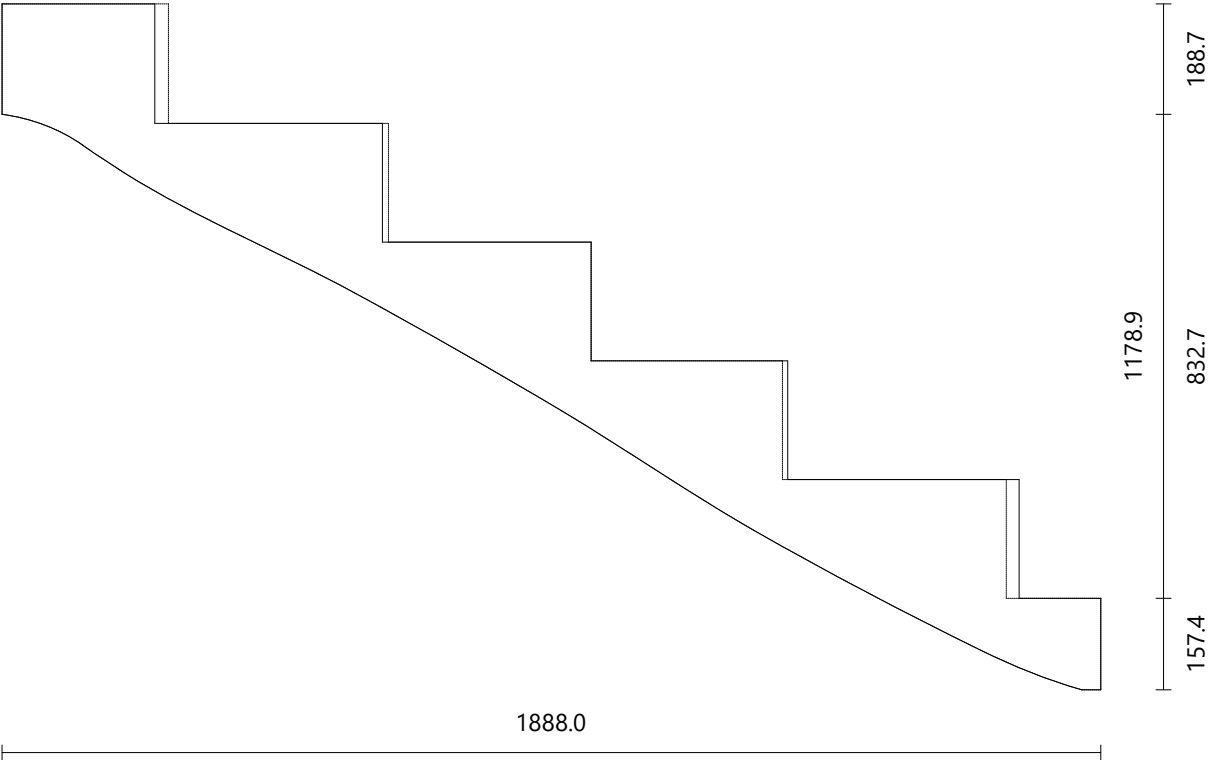

Material Pine
Dimensions 1753.5 × 361.7 mm
Thickness 32.0 mm

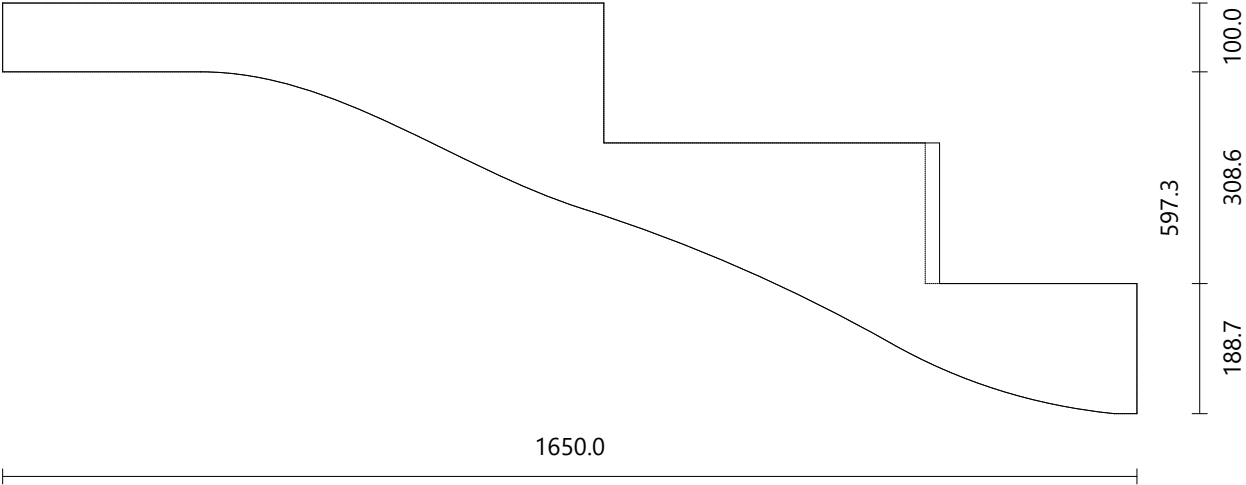

Material Pine
Dimensions 127.5 × 182.3 mm
Thickness 25.0 mm

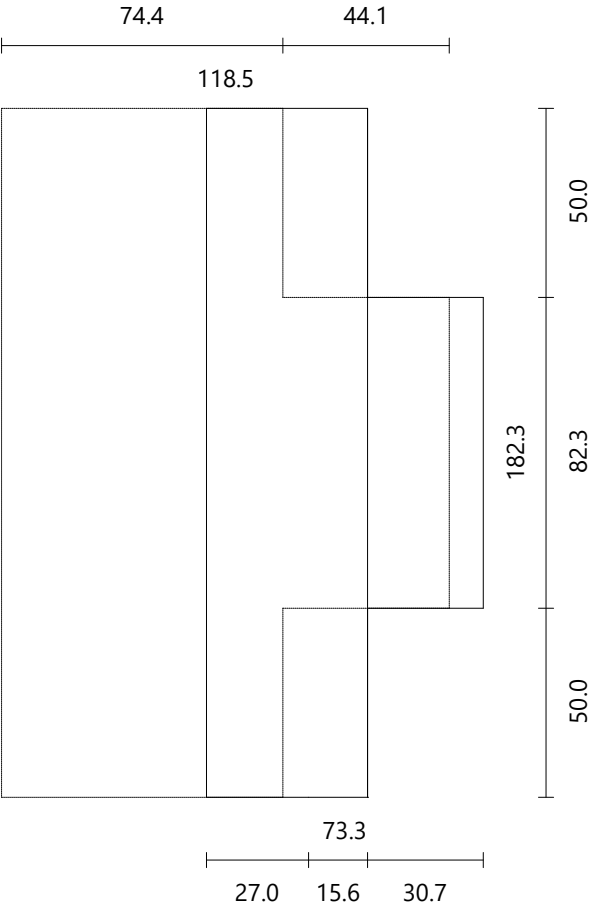

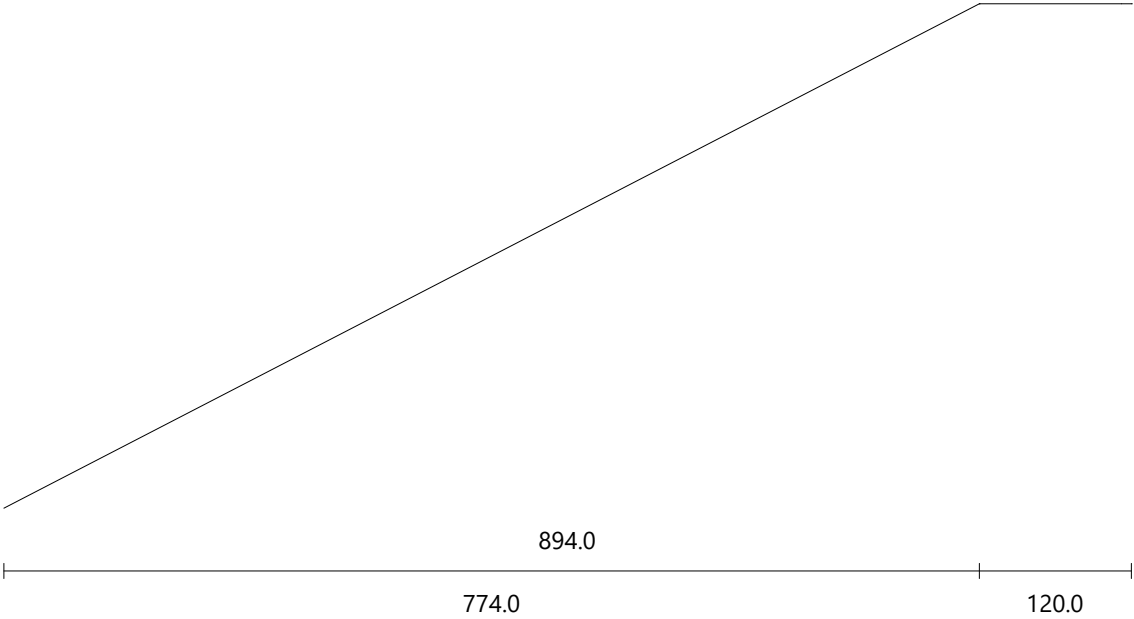
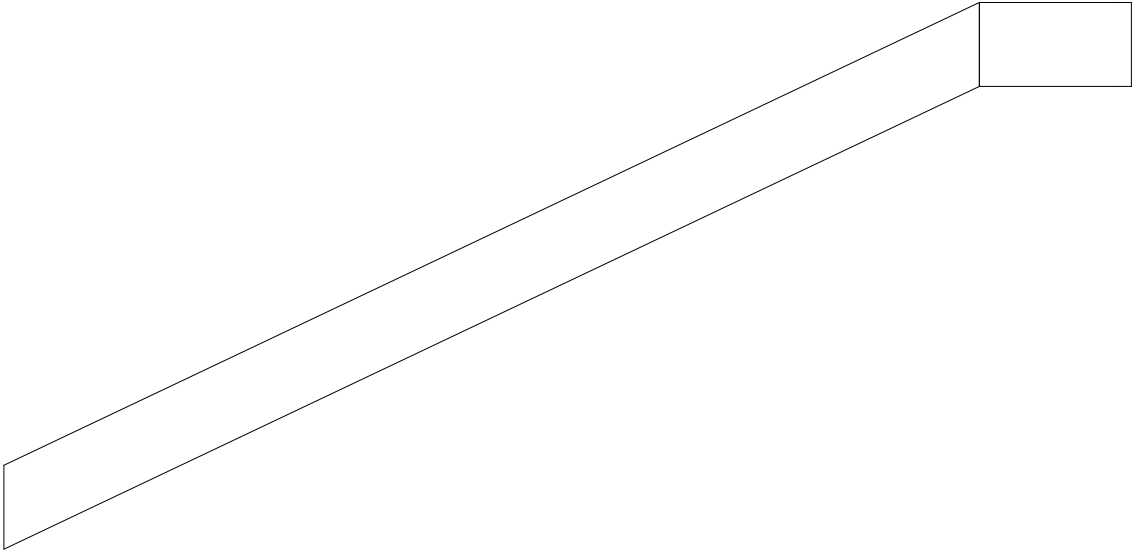



Material Pine
Dimensions 885.1 × 60.0 mm
Thickness 40.0 mm

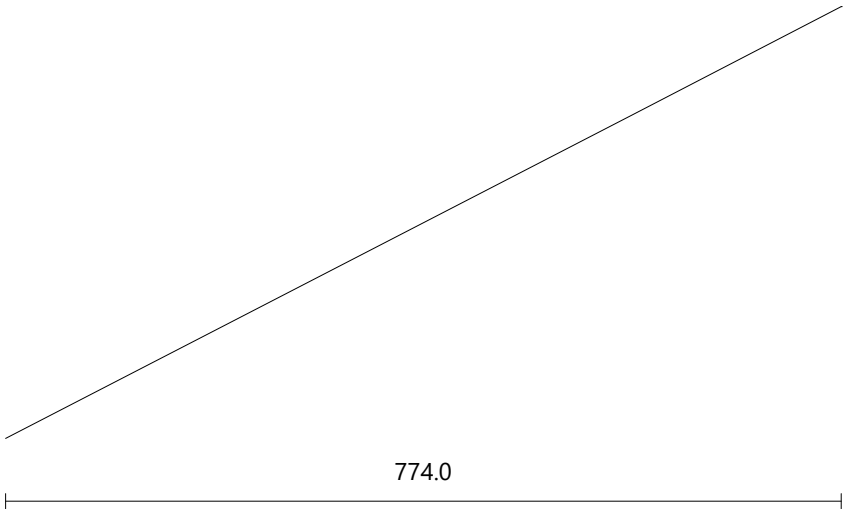
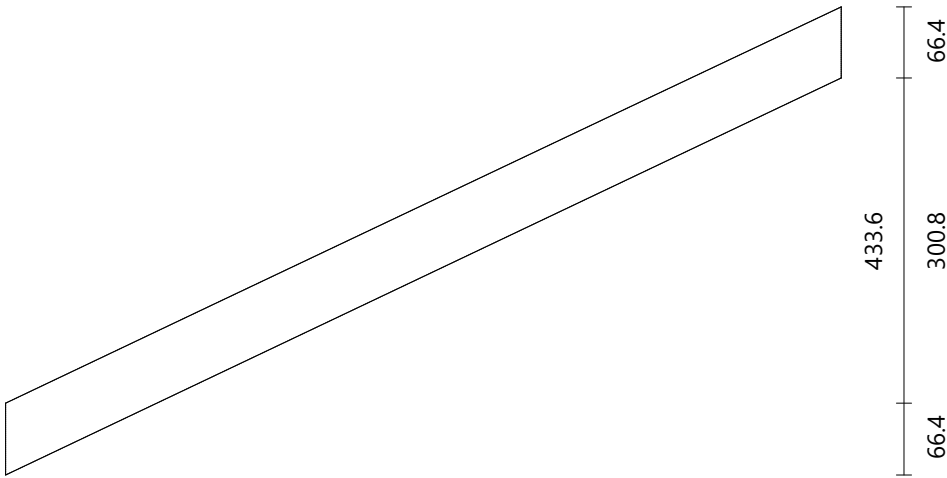

Material Pine
Dimensions 151.9 × 66.5 mm
Thickness 40.0 mm

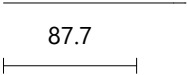
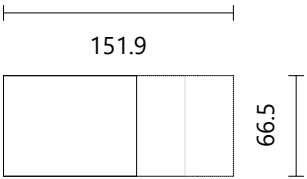

Material Pine
 Dimensions 583.2 × 60.0 mm
 Thickness 40.0 mm

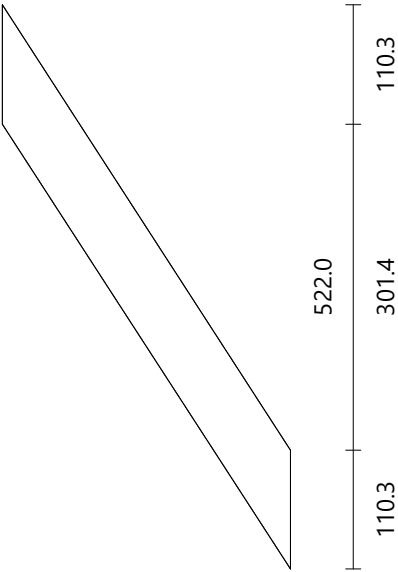

Material Pine
Dimensions 734.2 × 60.0 mm
Thickness 40.0 mm

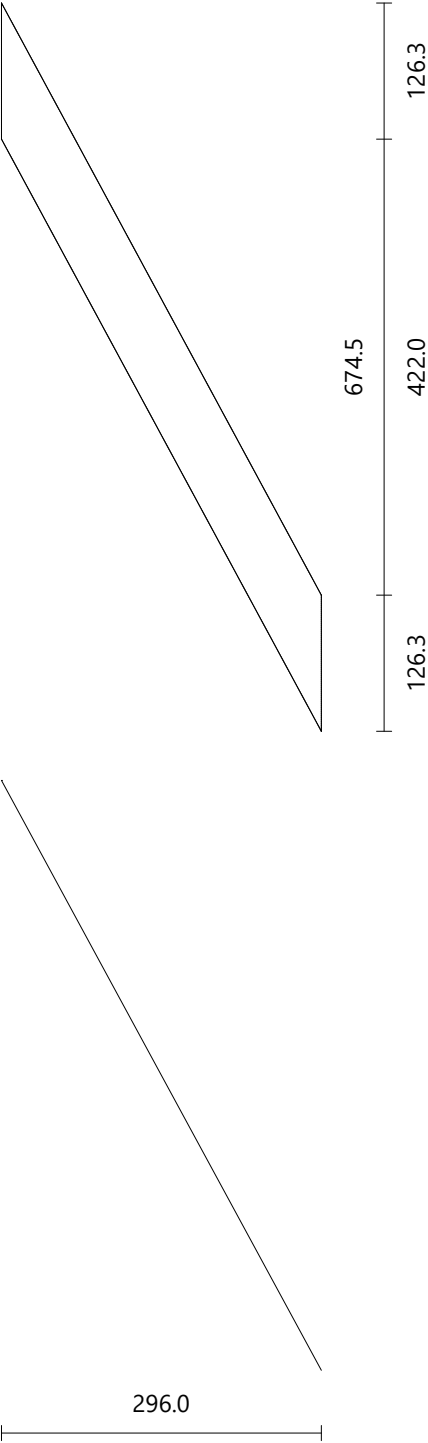

Material Pine
Dimensions 1157.8 × 60.0 mm
Thickness 40.0 mm

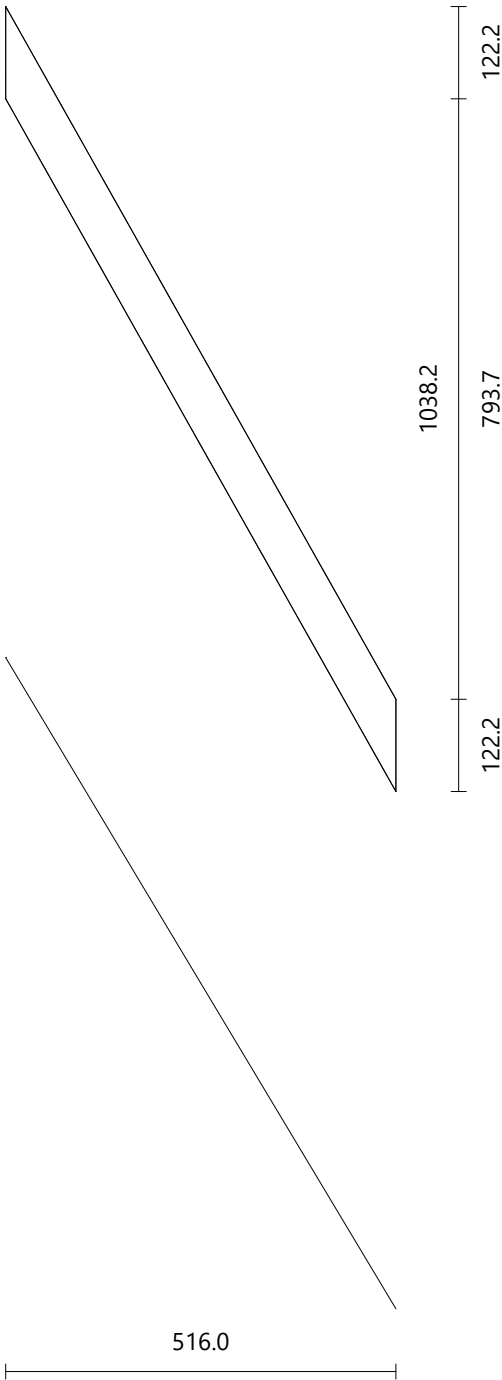

Material Pine
Dimensions 828.0 × 60.0 mm
Thickness 40.0 mm

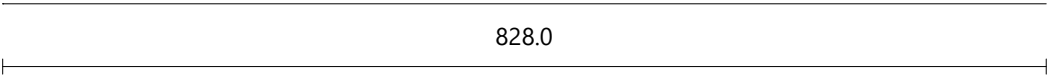
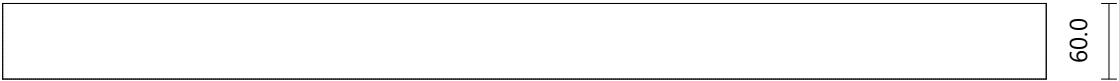

Corner Newel Post

Right Side

Flights: 1-2

Top View

Material Pine
Dimensions 82.0 × 82.0 mm
Height 1986.0 mm

Step #3 Height: 612.9 mm
Step #4 Height: 817.1 mm

Face 1 Right Stringboard #2
Right Handrail #2
Face 4 Right Stringboard #1
Right Handrail #1

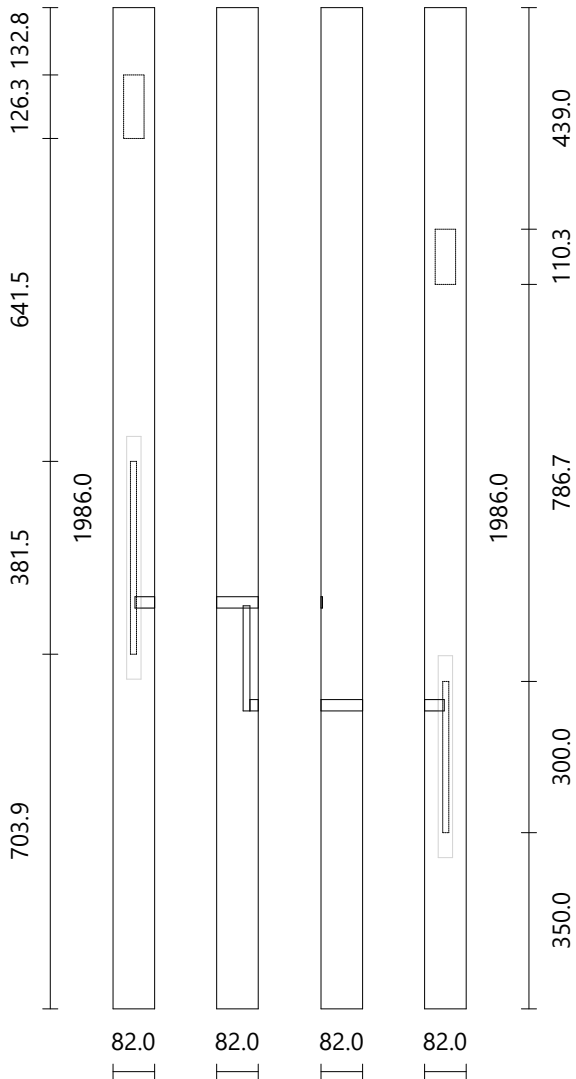
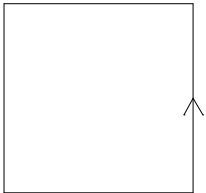

Corner Newel Post	Right Side	Flights: 2-3	Top View
Material	Pine		
Dimensions	82.0 × 82.0 mm		
Height	1509.8 mm		
Step #7	Height: 279.8 mm		
Step #8	Height: 484.1 mm		
Face 1	Right Stringboard #3 Right Handrail #3		
Face 4	Right Stringboard #2 Right Handrail #2		

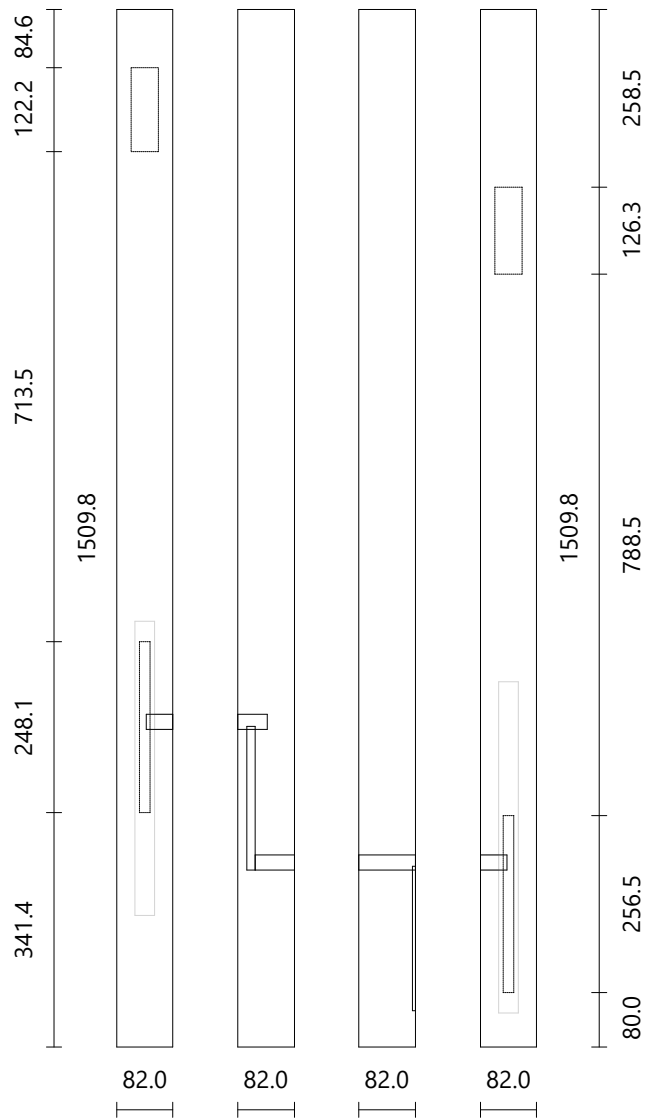
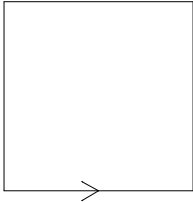

Corner Newel Post Left Side Flight: 1 Top View

Material Pine
Dimensions 82.0 × 82.0 mm
Height 1391.0 mm

Step #1 Height: 204.3 mm

Face 2 Left Stringboard #1
 Left Handrail #1

Face 4 Left Cut String #1

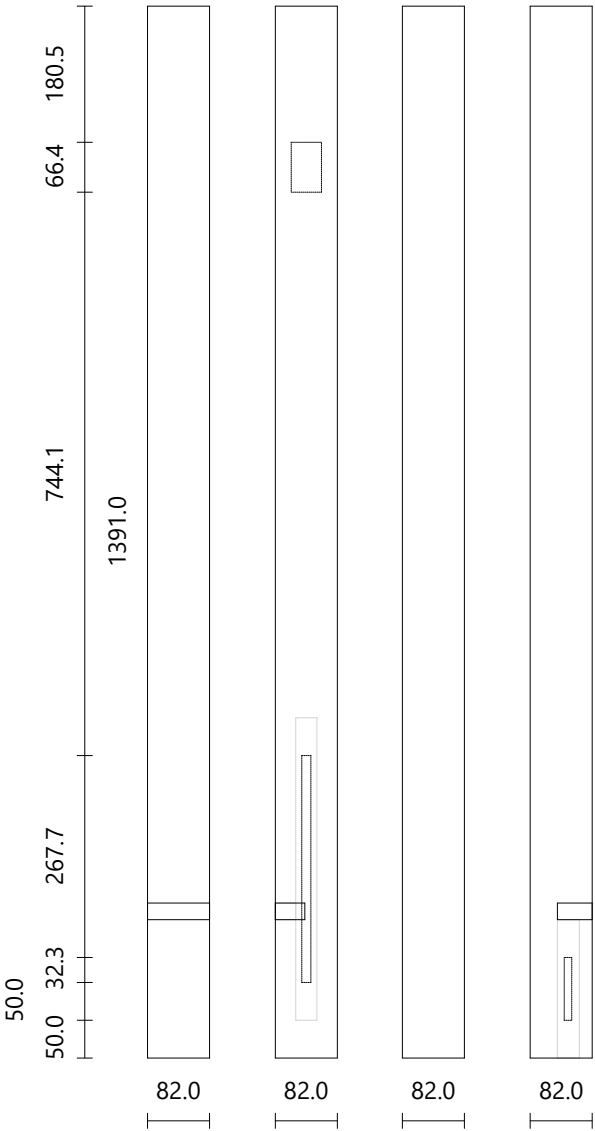
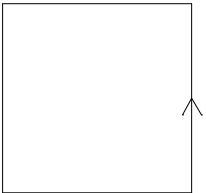

End Newel Post	Right Side	Landing: 1	Top View
Material	Pine		
Dimensions	90.0 × 90.0 mm		
Height	1195.0 mm		
Step #14	Height: 245.0 mm		
Face 4	Right Stringboard #4 Right Handrail #4		

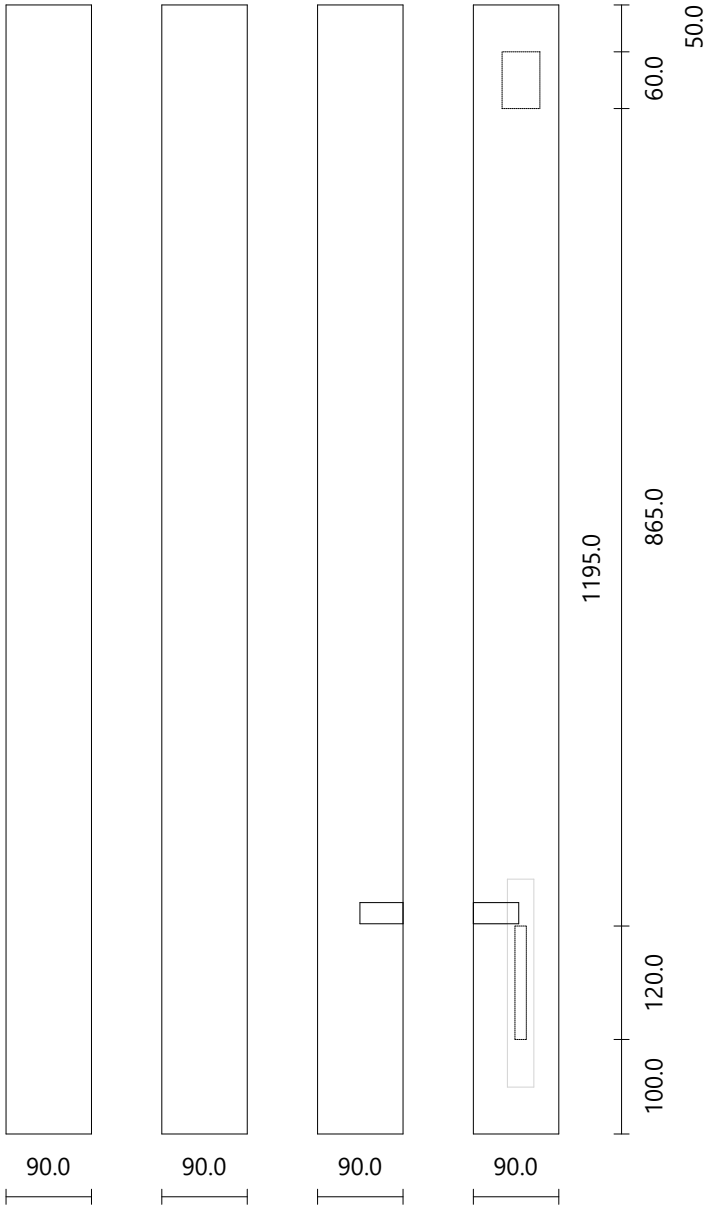

Corner Newel Post Left Side Flight: 2 Top View

Material Pine
Dimensions 90.0 × 90.0 mm
Height 1840.0 mm

Step #3 Height: 612.9 mm
Step #4 Height: 817.1 mm

Face 2 Left Cut String #2
Face 4 Left Stringboard #2
 Left Handrail #2

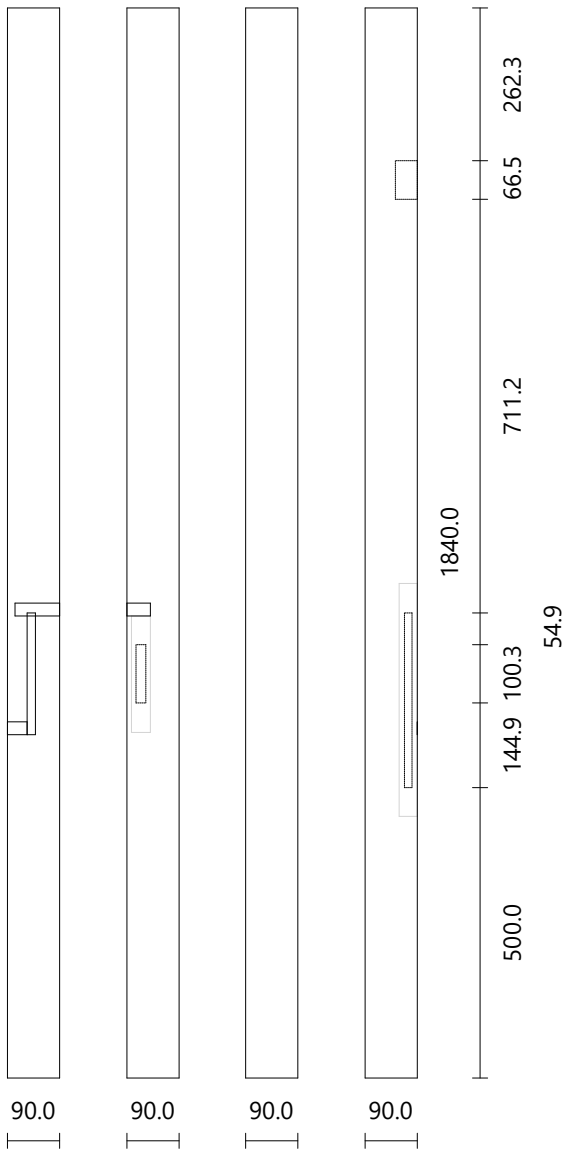
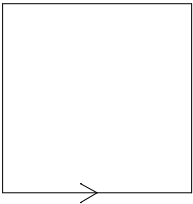

Corner Newel Post Right Side Flight: 1 Top View

Material Pine
Dimensions 82.0 × 82.0 mm
Height 1391.0 mm

Step #1 Height: 204.3 mm

Face 2 Right Stringboard #1
Right Handrail #1
Face 4 Right Cut String #1

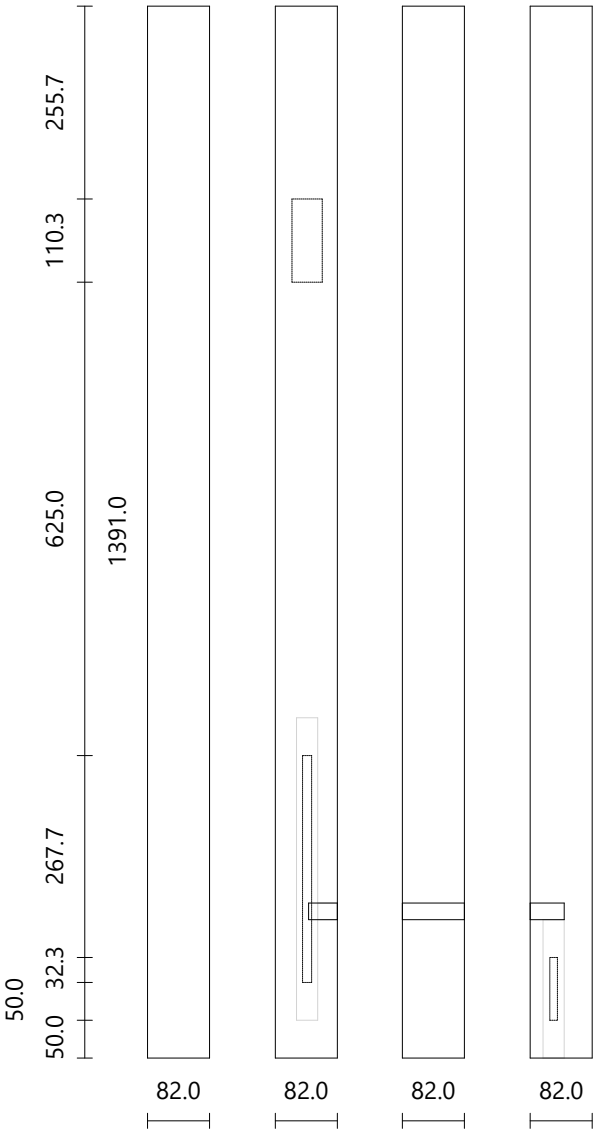
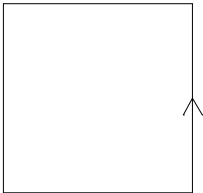

Corner Newel Post	Right Side	Flights: 3-4	Top View
Material	Pine		
Dimensions	82.0 × 82.0 mm		
Height	1657.1 mm		
Step #12	Height: 298.6 mm		
Step #13	Height: 502.8 mm		
Step #14	Height: 707.1 mm		
Face 1	Right Stringboard #4 Right Handrail #4		
Face 4	Right Stringboard #3 Right Handrail #3		

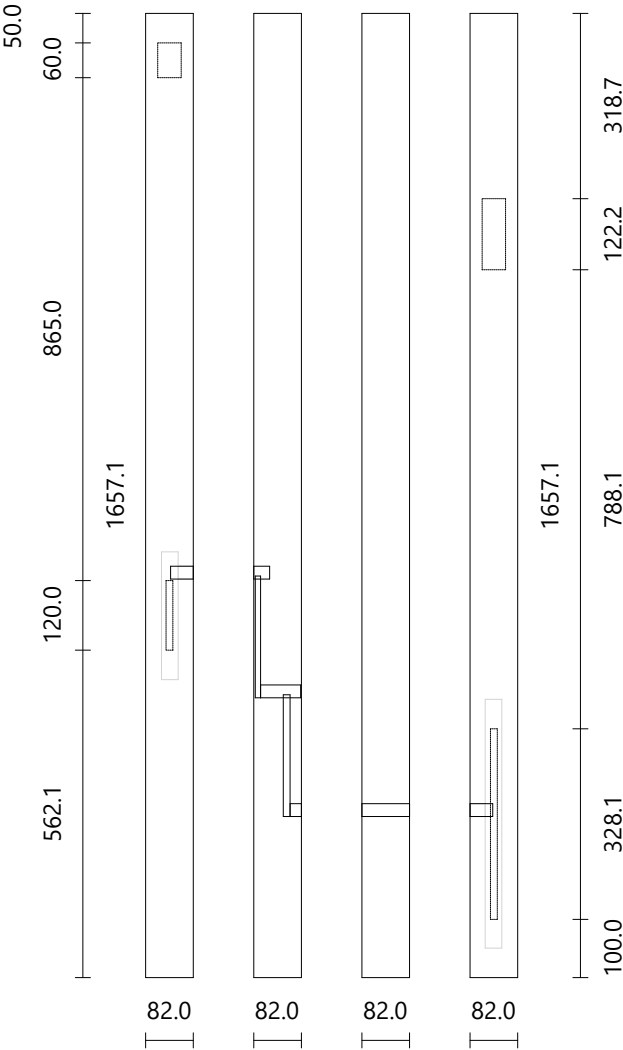
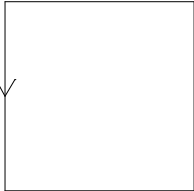

Part	Material	Dimensions	Cutting List Volume	Real Volume
Step #1	Pine	592.4 × 242.0 × 22.0	0.00 m ³	0.00 m ³
Step #2	Pine	578.0 × 332.9 × 22.0	0.00 m ³	0.00 m ³
Step #3	Pine	719.1 × 465.8 × 22.0	0.01 m ³	0.00 m ³
Step #4	Pine	809.6 × 376.5 × 22.0	0.01 m ³	0.00 m ³
Step #5	Pine	618.9 × 368.2 × 22.0	0.01 m ³	0.00 m ³
Step #6	Pine	688.6 × 366.3 × 22.0	0.01 m ³	0.00 m ³
Step #7	Pine	938.8 × 440.6 × 22.0	0.01 m ³	0.00 m ³
Step #8	Pine	965.7 × 345.1 × 22.0	0.01 m ³	0.00 m ³
Step #9	Pine	804.8 × 339.4 × 22.0	0.01 m ³	0.00 m ³
Step #10	Pine	734.0 × 373.4 × 22.0	0.01 m ³	0.00 m ³
Step #11	Pine	909.1 × 383.1 × 22.0	0.01 m ³	0.00 m ³
Step #12	Pine	1098.1 × 424.5 × 22.0	0.01 m ³	0.01 m ³
Step #13	Pine	868.8 × 429.0 × 22.0	0.01 m ³	0.00 m ³
Step #14	Pine	734.0 × 900.0 × 22.0	0.01 m ³	0.01 m ³
Riser #1	Pine	542.3 × 187.3 × 10.0	0.00 m ³	0.00 m ³
Riser #2	Pine	578.0 × 209.3 × 10.0	0.00 m ³	0.00 m ³
Riser #3	Pine	606.2 × 209.3 × 10.0	0.00 m ³	0.00 m ³
Riser #4	Pine	711.6 × 209.3 × 10.0	0.00 m ³	0.00 m ³
Riser #5	Pine	597.4 × 209.3 × 10.0	0.00 m ³	0.00 m ³
Riser #6	Pine	602.5 × 209.3 × 10.0	0.00 m ³	0.00 m ³
Riser #7	Pine	660.7 × 209.3 × 10.0	0.00 m ³	0.00 m ³
Riser #8	Pine	858.2 × 209.3 × 10.0	0.00 m ³	0.00 m ³
Riser #9	Pine	768.2 × 209.3 × 10.0	0.00 m ³	0.00 m ³
Riser #10	Pine	734.0 × 209.3 × 10.0	0.00 m ³	0.00 m ³
Riser #11	Pine	779.3 × 209.3 × 10.0	0.00 m ³	0.00 m ³
Riser #12	Pine	913.2 × 209.3 × 10.0	0.00 m ³	0.00 m ³
Riser #13	Pine	838.6 × 209.3 × 10.0	0.00 m ³	0.00 m ³
Riser #14	Pine	707.0 × 209.3 × 10.0	0.00 m ³	0.00 m ³
Left Stringboard #1	Pine	1071.9 × 355.4 × 28.0	0.01 m ³	0.01 m ³
Left Stringboard #2	Pine	183.6 × 400.0 × 28.0	0.00 m ³	0.00 m ³
Right Stringboard #1	Pine	639.2 × 292.0 × 28.0	0.01 m ³	0.00 m ³
Right Stringboard #2	Pine	1039.2 × 263.2 × 28.0	0.01 m ³	0.00 m ³
Right Stringboard #3	Pine	1368.5 × 247.0 × 28.0	0.01 m ³	0.01 m ³
Right Stringboard #4	Pine	918.0 × 220.0 × 28.0	0.01 m ³	0.01 m ³
Left Cut String #1	Pine	127.5 × 182.3 × 25.0	0.00 m ³	0.00 m ³
Left Cut String #2	Pine	1730.0 × 325.0 × 32.0	0.02 m ³	0.01 m ³
Left Cut String #3	Pine	2222.8 × 308.5 × 32.0	0.02 m ³	0.01 m ³
Left Cut String #4	Pine	1753.5 × 361.7 × 32.0	0.02 m ³	0.01 m ³
Right Cut String #1	Pine	127.5 × 182.3 × 25.0	0.00 m ³	0.00 m ³
Left Handrail #1	Pine	885.1 × 60.0 × 40.0	0.00 m ³	0.00 m ³
Left Handrail #2	Pine	151.9 × 66.5 × 40.0	0.00 m ³	0.00 m ³
Right Handrail #1	Pine	583.2 × 60.0 × 40.0	0.00 m ³	0.00 m ³
Right Handrail #2	Pine	734.2 × 60.0 × 40.0	0.00 m ³	0.00 m ³
Right Handrail #3	Pine	1157.8 × 60.0 × 40.0	0.00 m ³	0.00 m ³
Right Handrail #4	Pine	828.0 × 60.0 × 40.0	0.00 m ³	0.00 m ³
Newel Post #1	Pine	82.0 × 82.0 × 1986.0	0.01 m ³	0.01 m ³
Newel Post #2	Pine	82.0 × 82.0 × 1509.8	0.01 m ³	0.01 m ³
Newel Post #3	Pine	82.0 × 82.0 × 1391.0	0.01 m ³	0.01 m ³
Newel Post #4	Pine	90.0 × 90.0 × 1195.0	0.01 m ³	0.01 m ³

Part	Material	Dimensions	Cutting List Volume	Real Volume
Newel Post #5	Pine	90.0 × 90.0 × 1840.0	0.01 m ³	0.01 m ³
Newel Post #6	Pine	82.0 × 82.0 × 1391.0	0.01 m ³	0.01 m ³
Newel Post #7	Pine	82.0 × 82.0 × 1657.1	0.01 m ³	0.01 m ³

Part	Material	Cutting List Volume	Real Volume	Weight	Price
Steps	Pine	0.10 m ³	0.07 m ³		
Risers	Pine	0.02 m ³	0.02 m ³		
Stringboards	Pine	0.04 m ³	0.03 m ³		
Lateral Cut Strings	Pine	0.06 m ³	0.03 m ³		
Handrails	Pine	0.01 m ³	0.01 m ³		
Newel Posts	Pine	0.08 m ³	0.08 m ³		
Total		0.31 m ³	0.24 m ³		