

Multi-Flight Stair		Riser Height	198.75 mm
Risers	12	Tread Width	230.95 mm
Floor Height	2385.00 mm	Stair Rule	628.45 mm

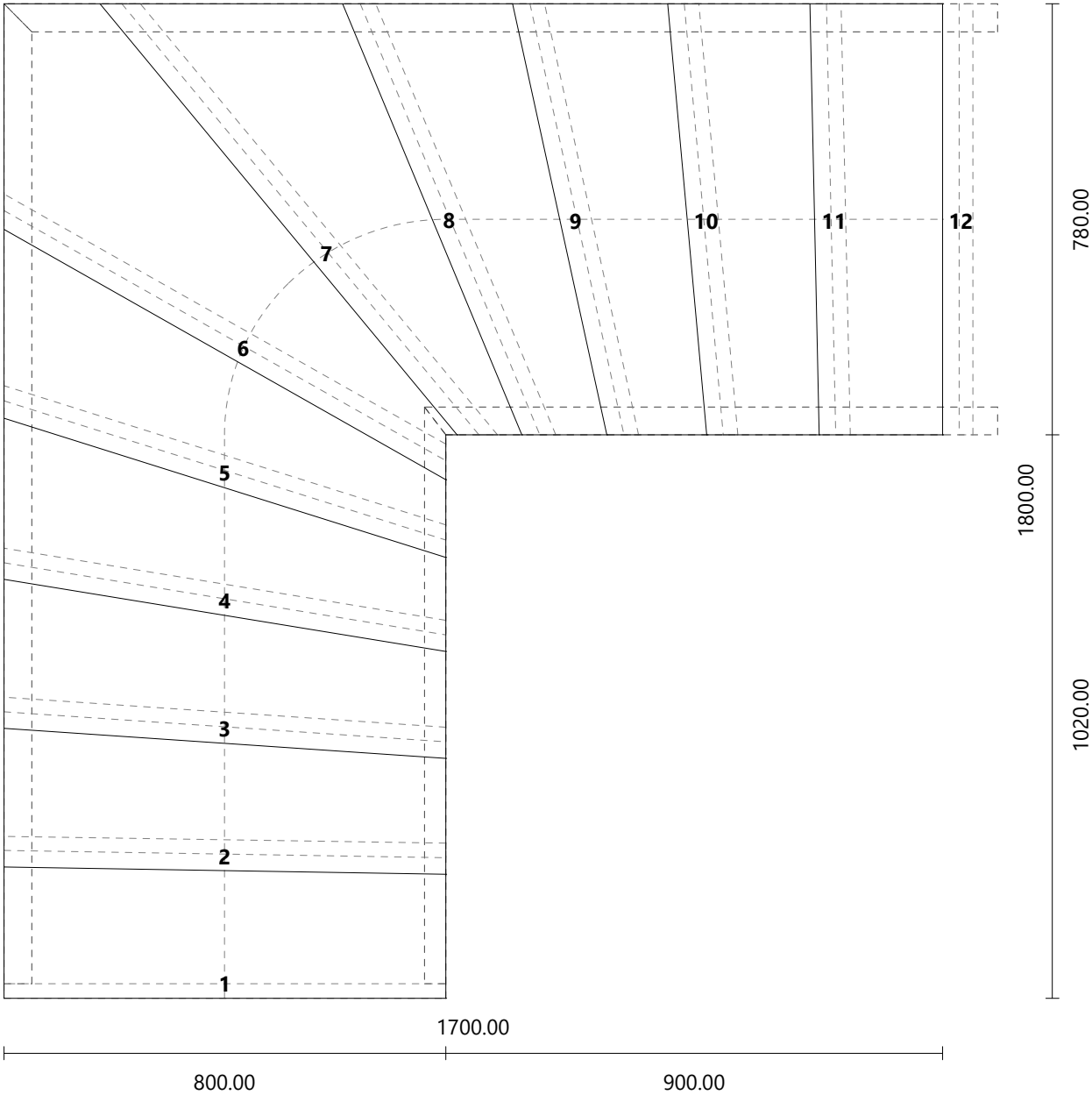

Wooddesigner & Atelierbois

Step

Material oak/chene/brutx2
Dimensions 800.00 × 267.29 mm
Thickness 38.00 mm

Riser

Material oak/chene/brutx2
Dimensions 800.00 × 170.75 mm
Thickness 26.00 mm
Angle 0°

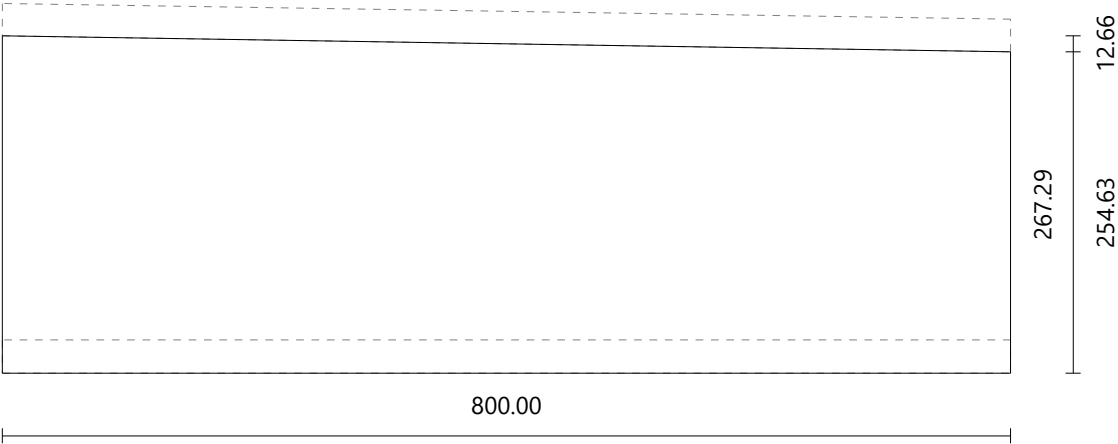

Step

Material oak/chene/brutx2
Dimensions 804.56 × 281.66 mm
Thickness 38.00 mm

Riser

Material oak/chene/brutx2
Dimensions 800.51 × 208.75 mm
Thickness 26.00 mm
Angle 0.91°

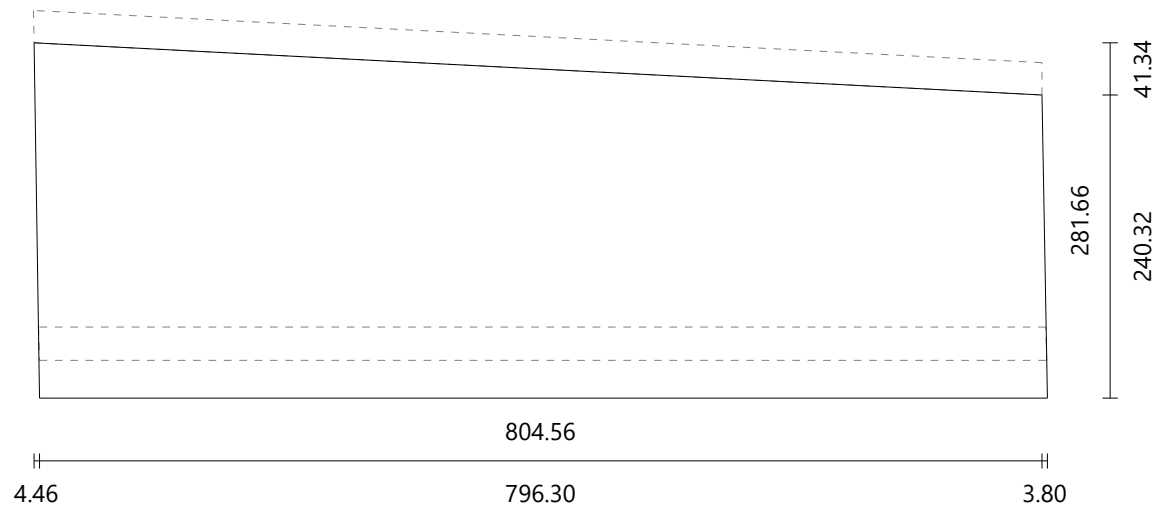

Step

Material oak/chene/brutx2
Dimensions 822.00 × 298.93 mm
Thickness 38.00 mm

Riser

Material oak/chene/brutx2
Dimensions 803.58 × 208.75 mm
Thickness 26.00 mm
Angle 3.86°

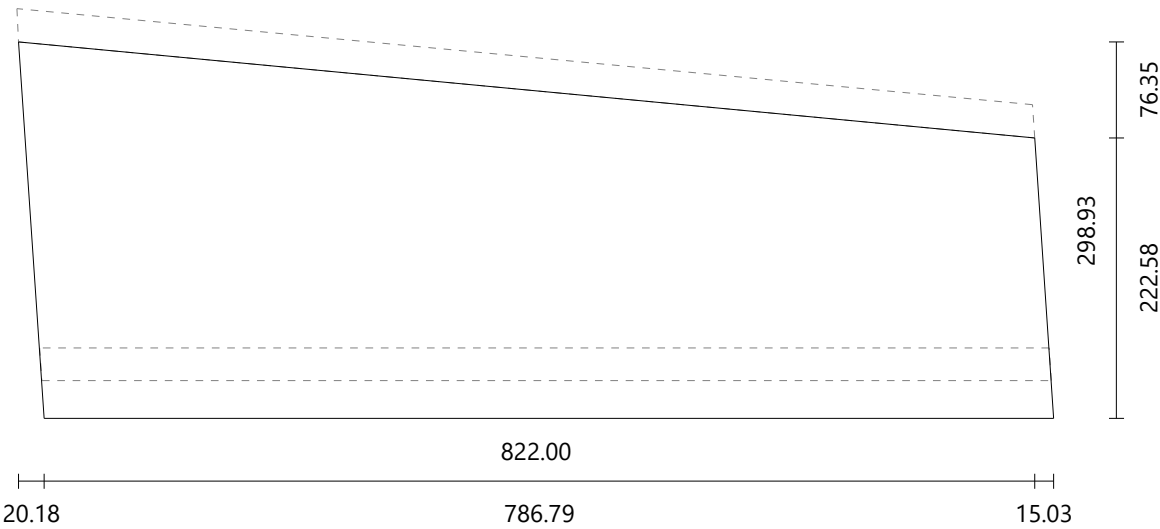

Step

Material oak/chene/brutx2
Dimensions 862.58 × 318.72 mm
Thickness 38.00 mm

Riser

Material oak/chene/brutx2
Dimensions 814.82 × 208.75 mm
Thickness 26.00 mm
Angle 9.27°

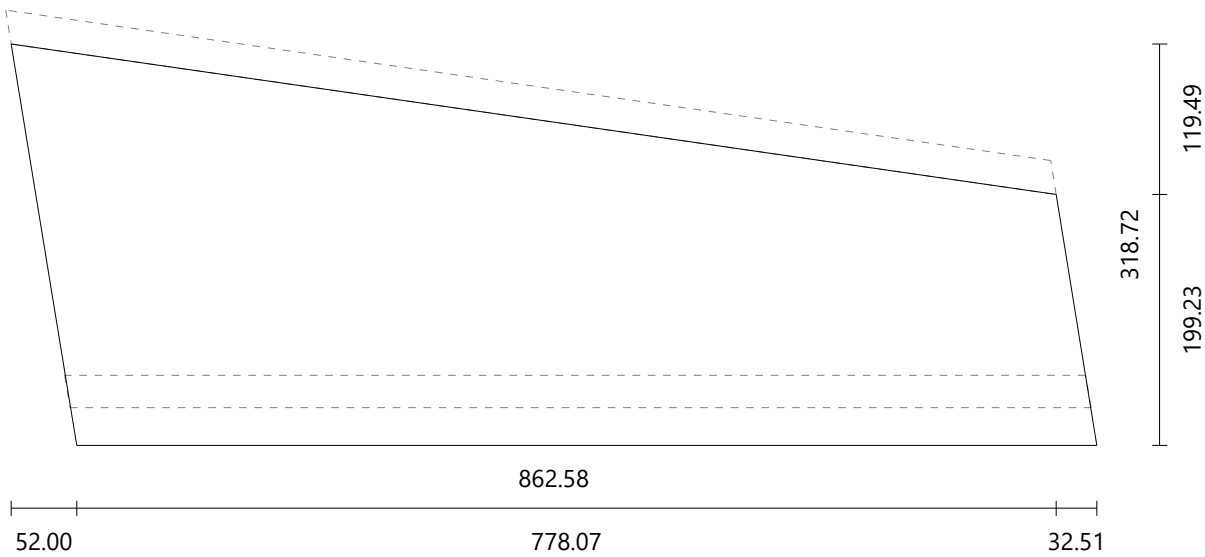

Step

Material oak/chene/brutx2
Dimensions 951.58 × 359.15 mm
Thickness 38.00 mm

Riser

Material oak/chene/brutx2
Dimensions 846.81 × 208.75 mm
Thickness 26.00 mm
Angle 17.46°

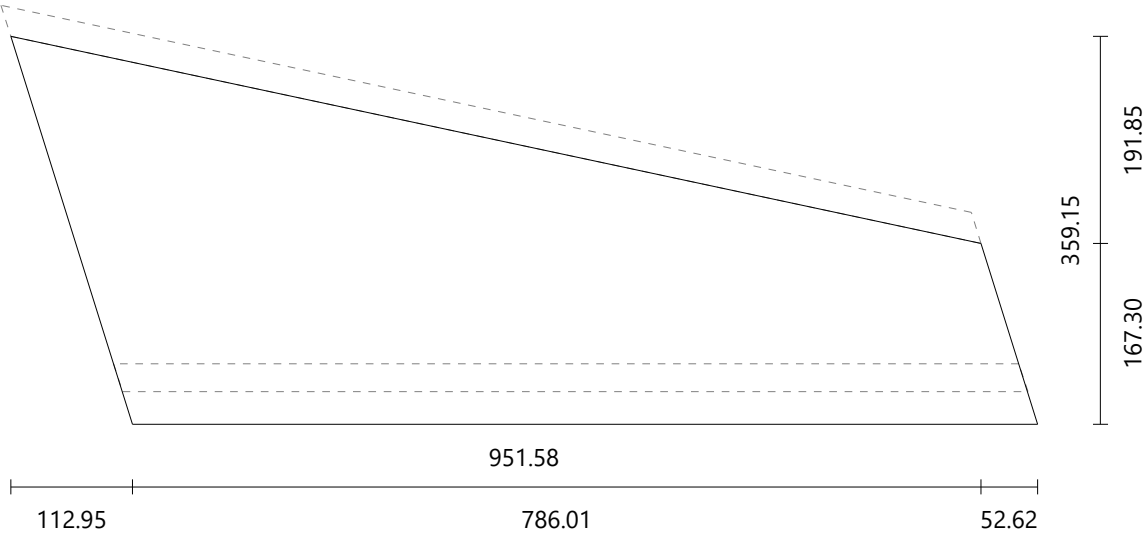

Step

Material oak/chene/brutx2
Dimensions 1132.49 × 460.43 mm
Thickness 38.00 mm

Riser

Material oak/chene/brutx2
Dimensions 933.92 × 208.75 mm
Thickness 26.00 mm
Angle 29.5°

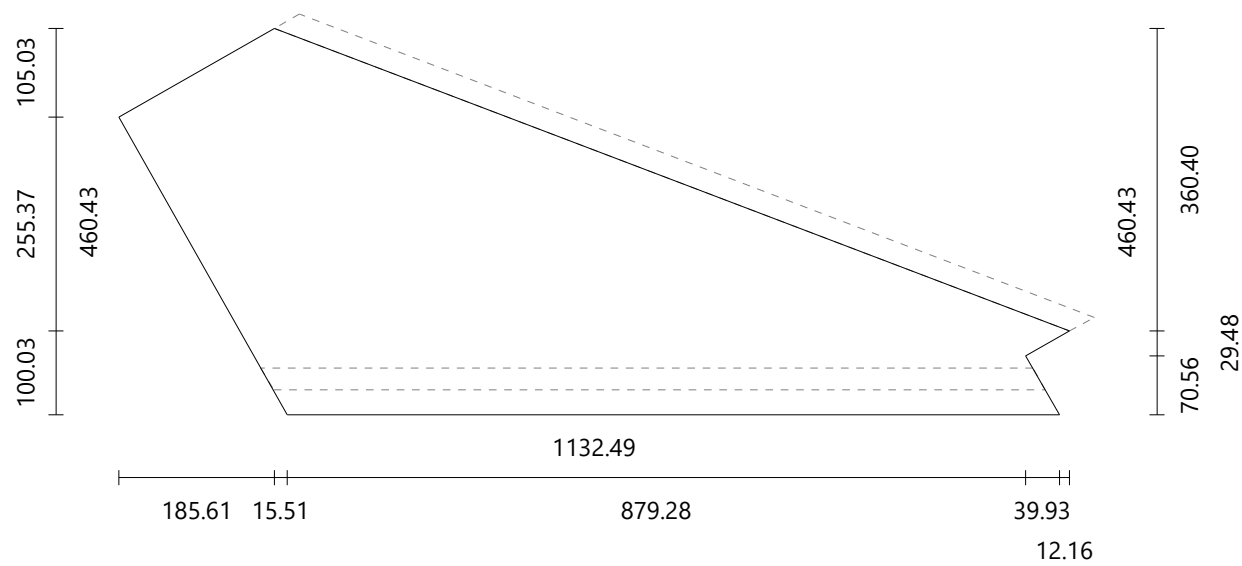

Step

Material oak/chene/brutx2
Dimensions 1109.19 × 362.74 mm
Thickness 38.00 mm

Riser

Material oak/chene/brutx2
Dimensions 1034.70 × 208.75 mm
Thickness 26.00 mm
Angle -39.66°

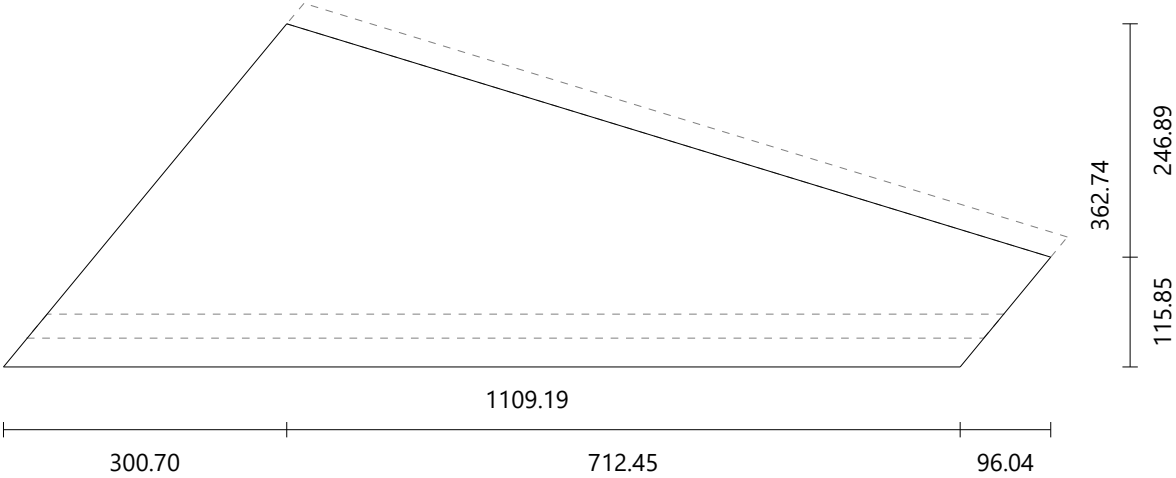

Step

Material oak/chene/brutx2
Dimensions 916.35 × 313.44 mm
Thickness 38.00 mm

Riser

Material oak/chene/brutx2
Dimensions 856.21 × 208.75 mm
Thickness 26.00 mm
Angle -22.68°

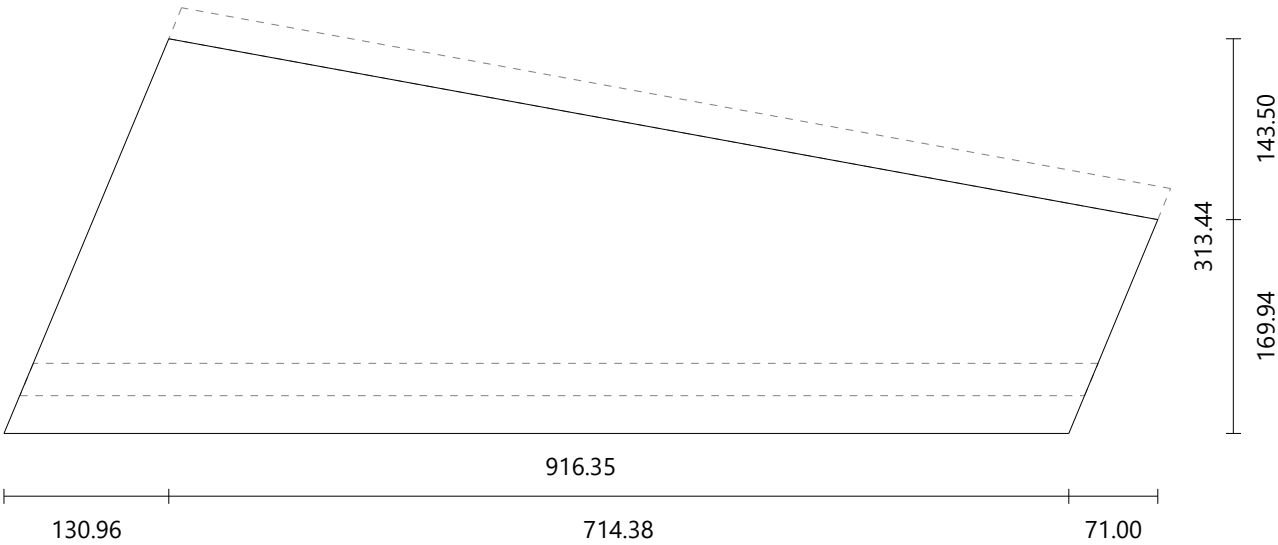

Step

Material oak/chene/brutx2
Dimensions 843.50 × 303.60 mm
Thickness 38.00 mm

Riser

Material oak/chene/brutx2
Dimensions 804.07 × 208.75 mm
Thickness 26.00 mm
Angle -12.32°

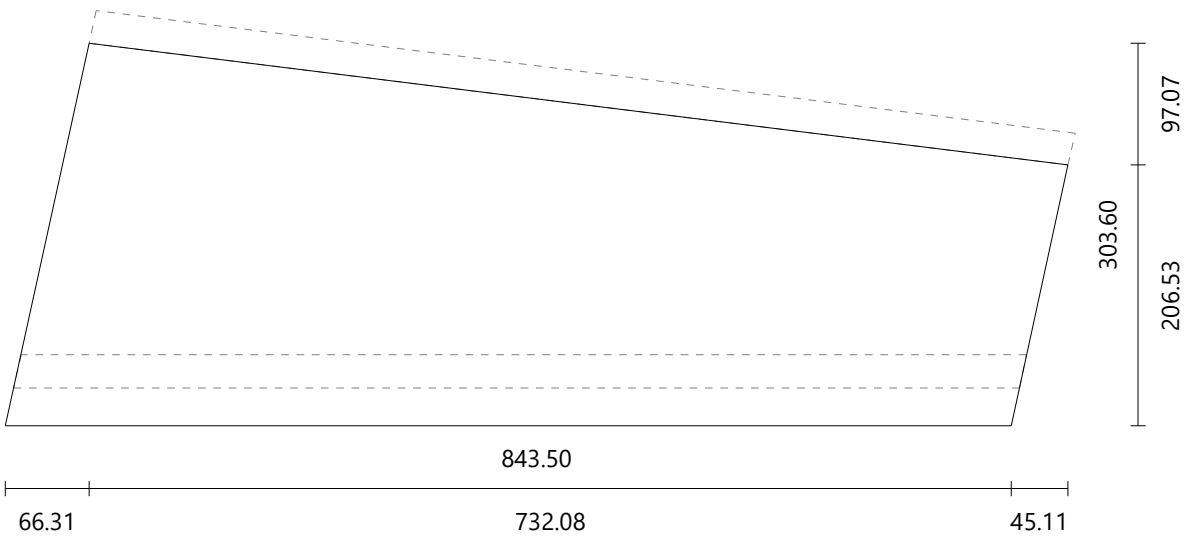

Step

Material oak/chene/brutx2
Dimensions 804.43 × 286.91 mm
Thickness 38.00 mm

Riser

Material oak/chene/brutx2
Dimensions 785.59 × 208.75 mm
Thickness 26.00 mm
Angle -5.2°

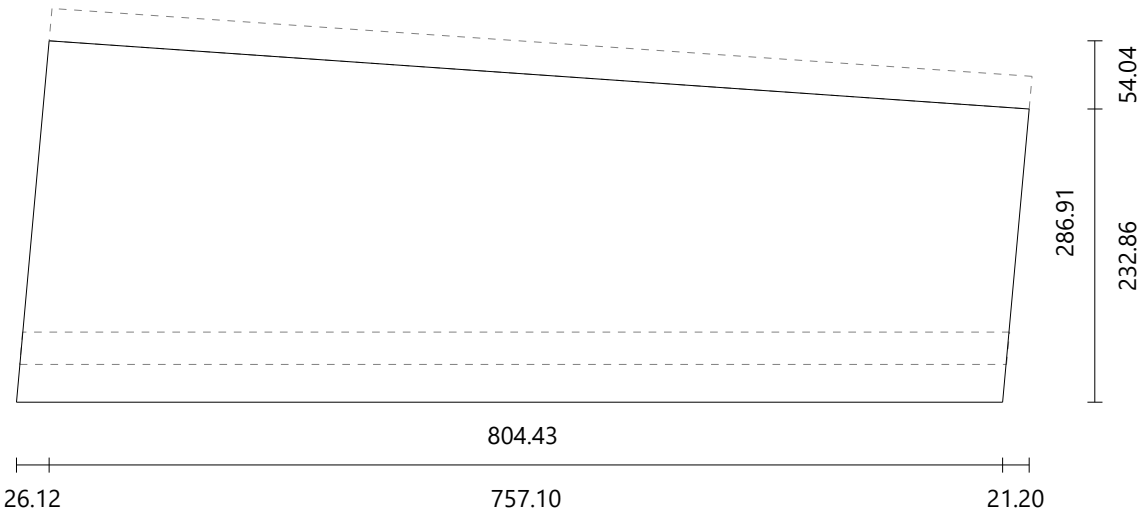

Step

Material oak/chene/brutx2
Dimensions 785.60 × 269.27 mm
Thickness 38.00 mm

Riser

Material oak/chene/brutx2
Dimensions 780.74 × 208.75 mm
Thickness 26.00 mm
Angle -1.23°

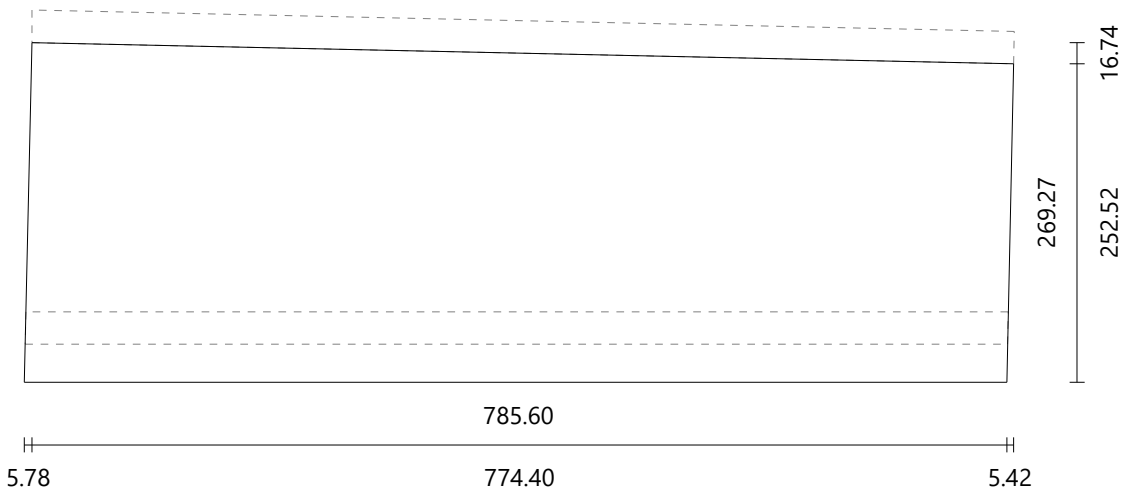

Step

Material oak/chene/brutx2
Dimensions 780.00 × 100.00 mm
Thickness 38.00 mm

Riser

Material oak/chene/brutx2
Dimensions 780.00 × 208.75 mm
Thickness 26.00 mm
Angle 0°

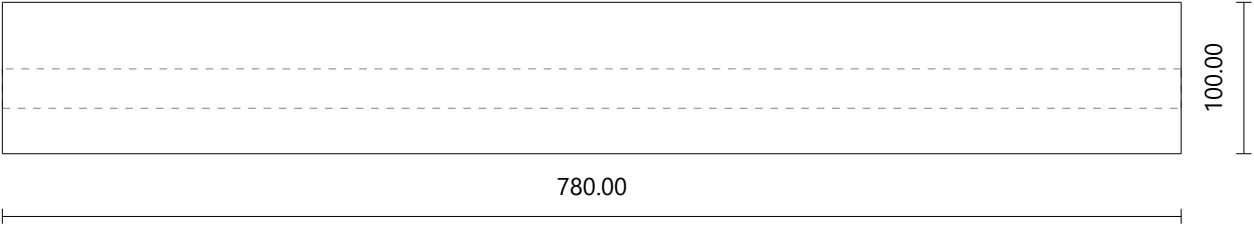

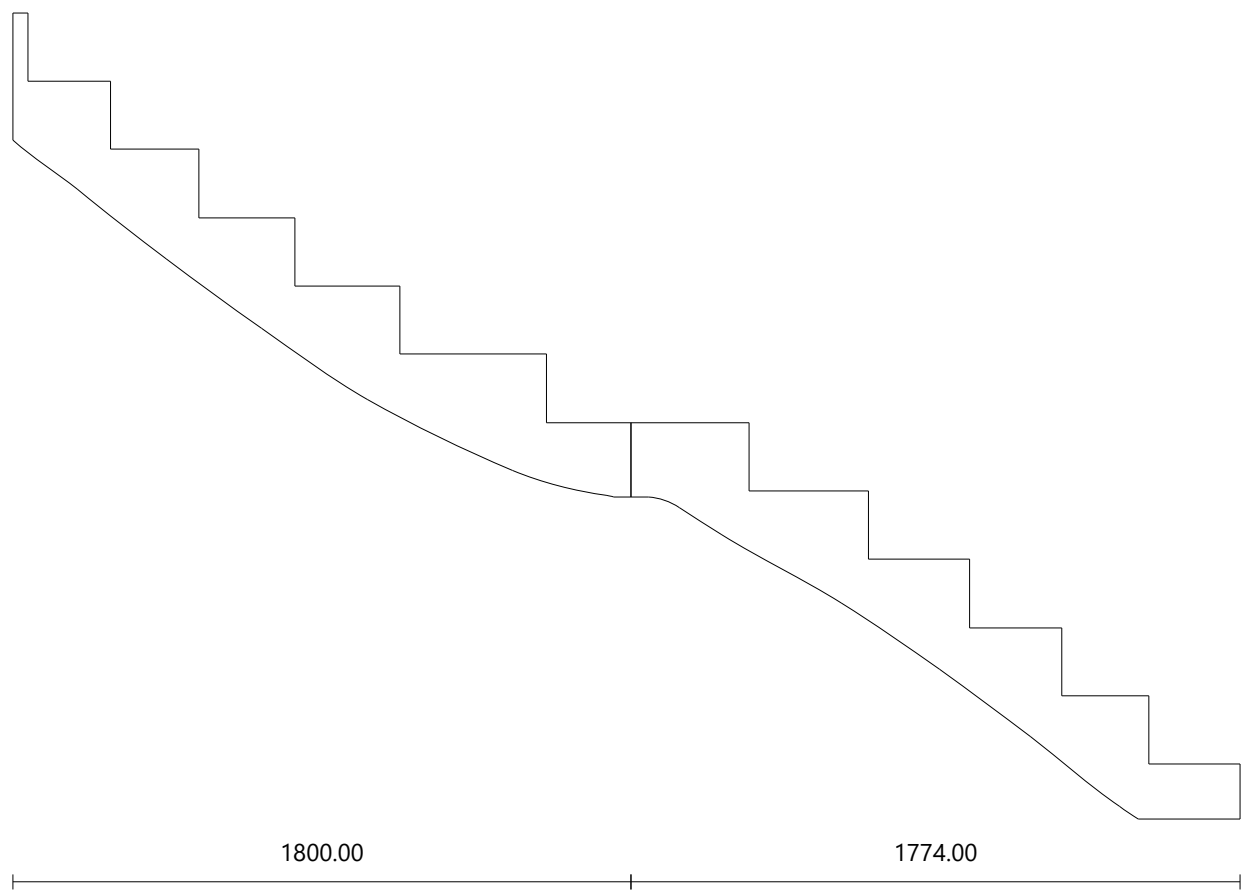

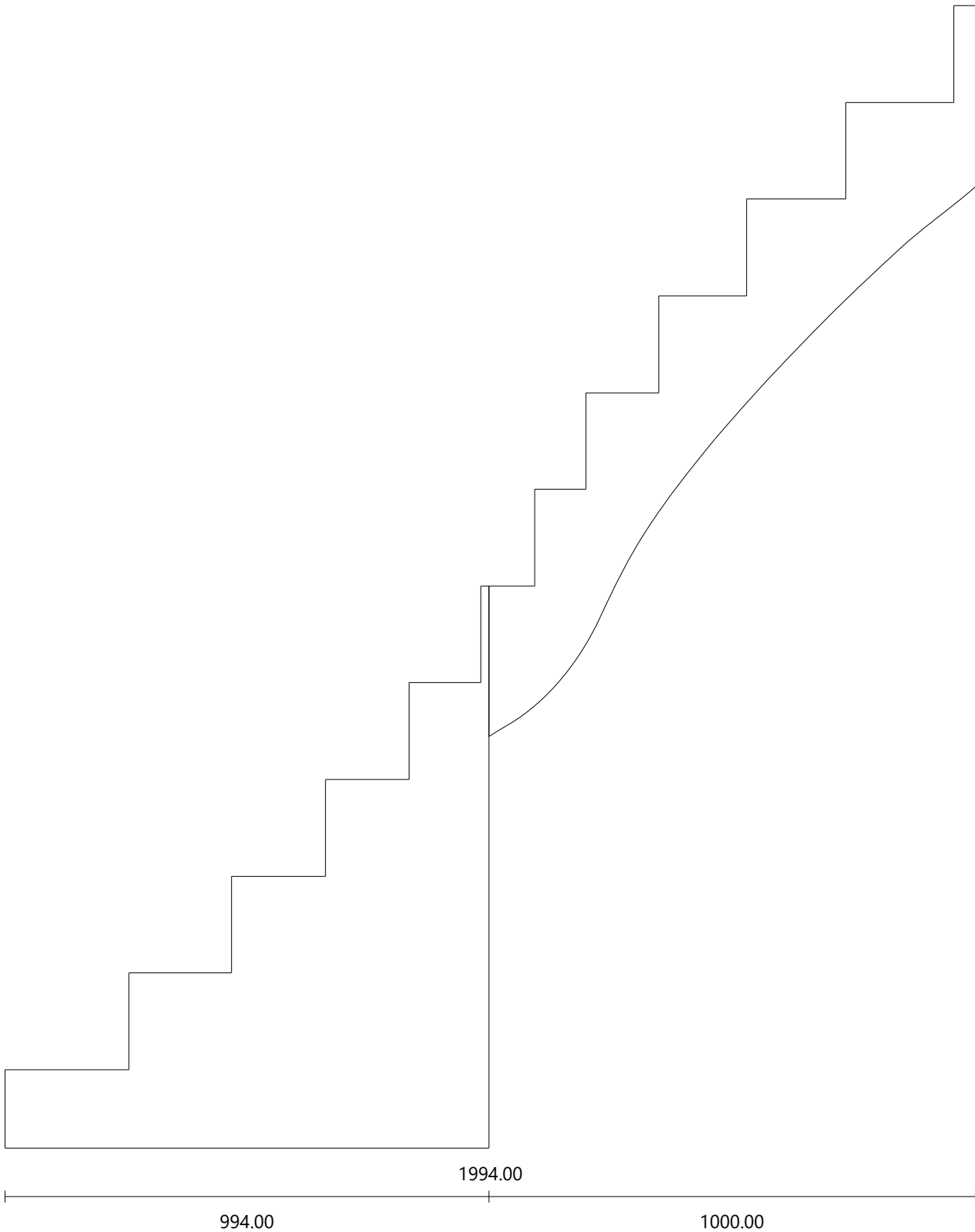

Material pine
Dimensions 2116.47 × 393.64 mm
Thickness 50.00 mm

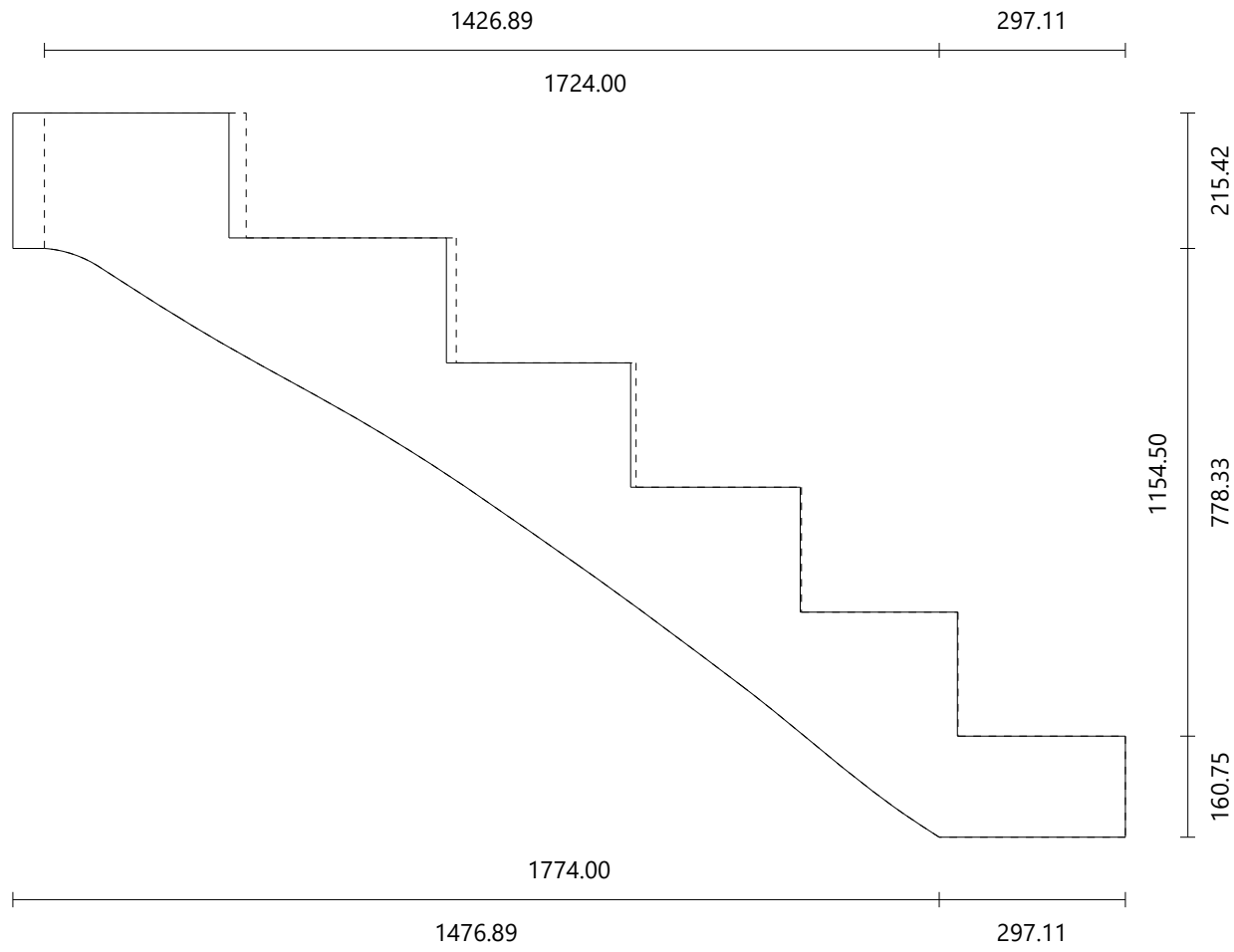

Material pine
 Dimensions 2277.65 × 399.45 mm
 Thickness 50.00 mm

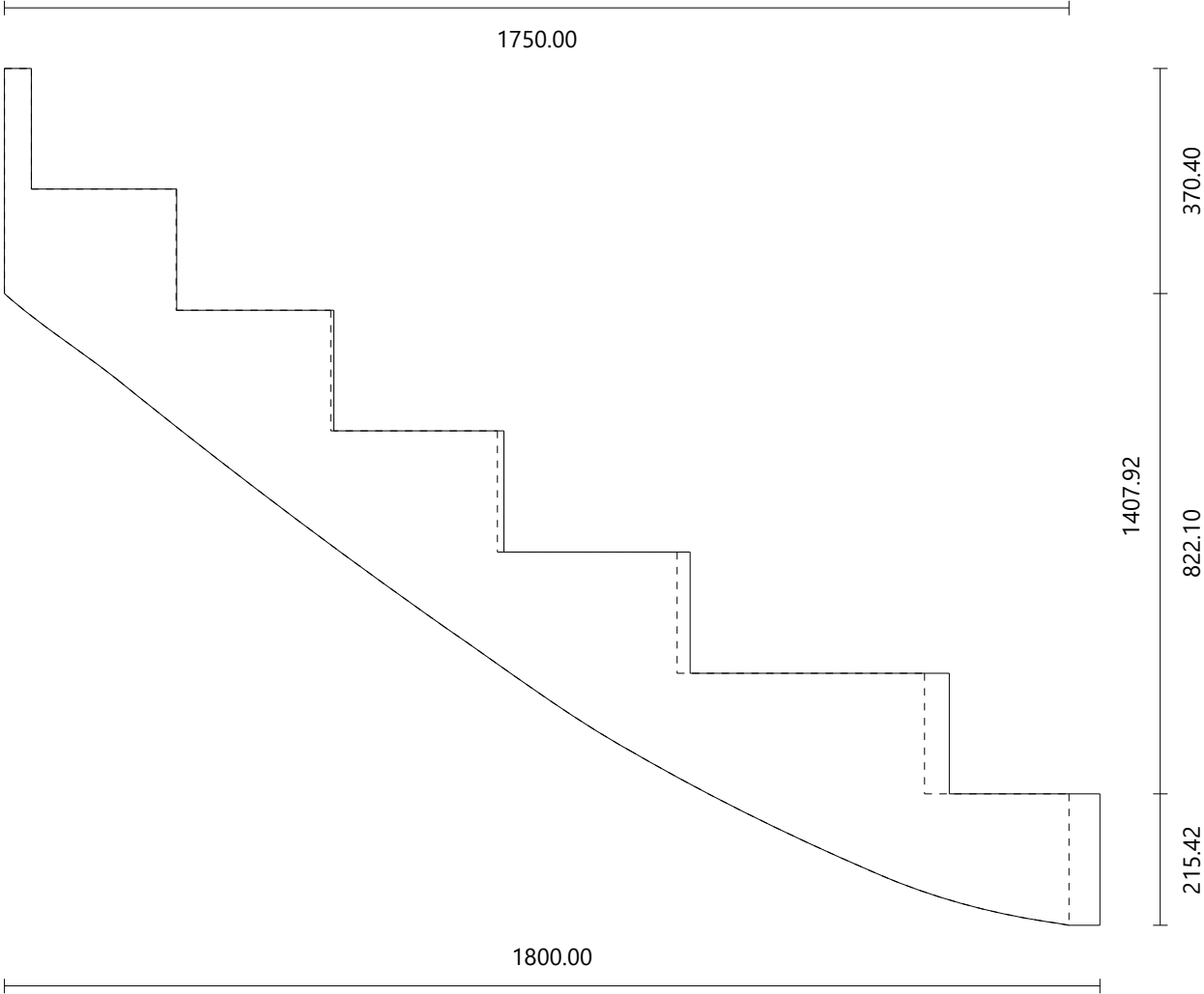

Material oak/chene/brutx2
Dimensions 1044.00 × 1154.50 mm
Thickness 38.00 mm

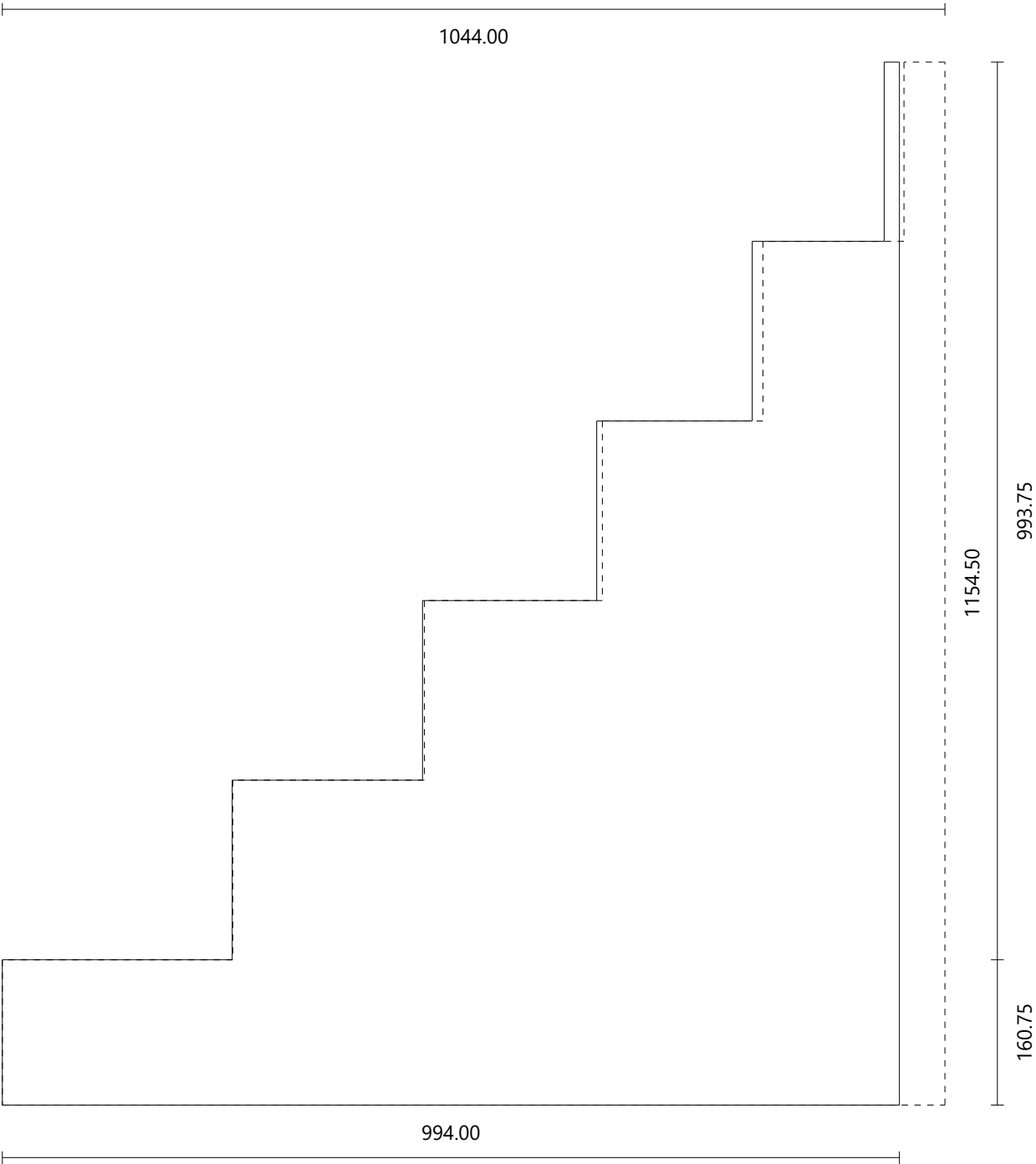

Material	pine
Dimensions	1833.88 × 361.47 mm
Thickness	50.00 mm

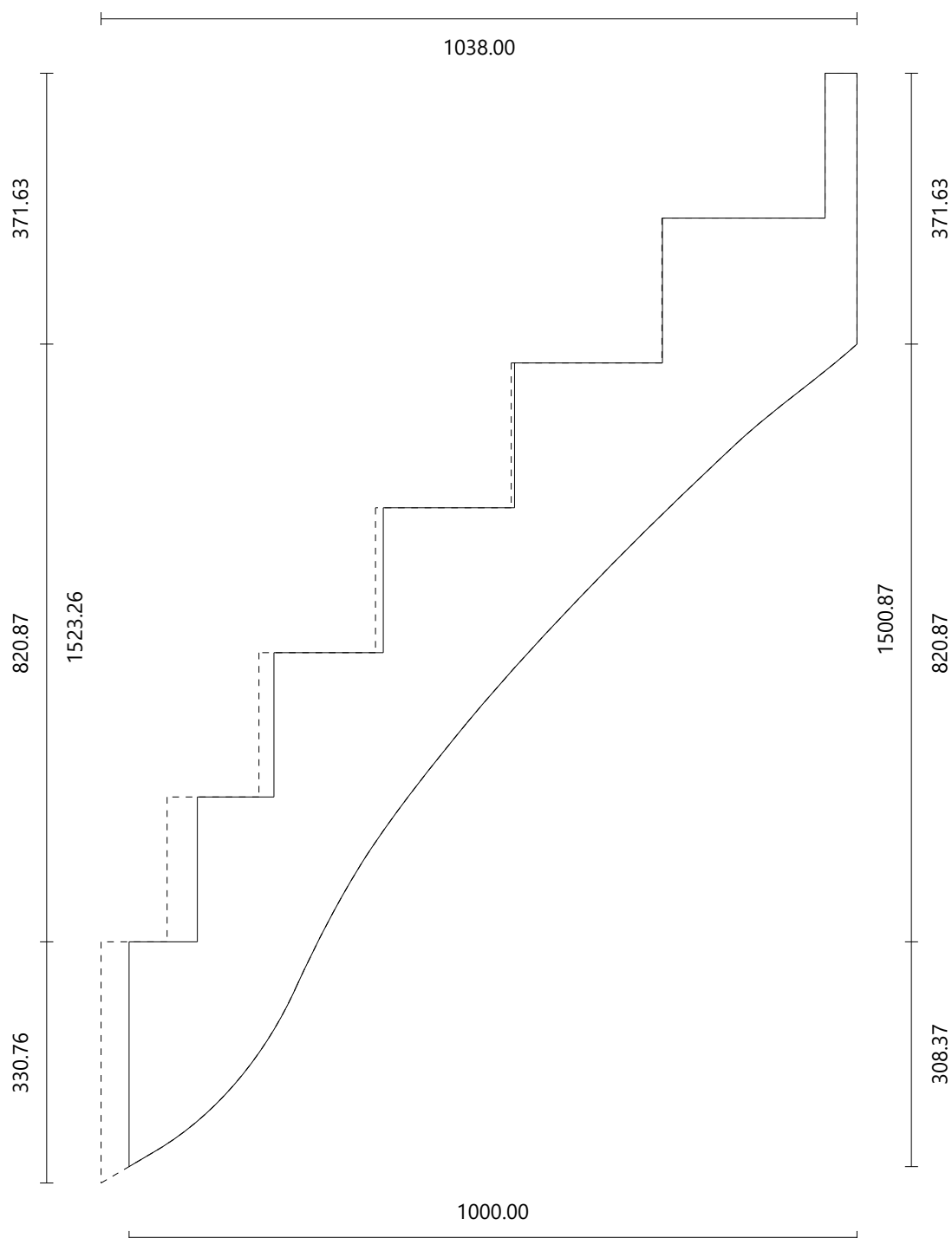

Wooddesigner & Atelierbois

Part	Material	Dimensions	Cutting List Volume	Real Volume
Step #1	oak/chene/brutx2	800.00 × 267.29 × 38.00	0.008 m ³	0.008 m ³
Step #2	oak/chene/brutx2	804.56 × 281.66 × 38.00	0.009 m ³	0.008 m ³
Step #3	oak/chene/brutx2	822.00 × 298.93 × 38.00	0.009 m ³	0.008 m ³
Step #4	oak/chene/brutx2	862.58 × 318.72 × 38.00	0.010 m ³	0.008 m ³
Step #5	oak/chene/brutx2	951.58 × 359.15 × 38.00	0.013 m ³	0.008 m ³
Step #6	oak/chene/brutx2	1132.49 × 460.43 × 38.00	0.020 m ³	0.011 m ³
Step #7	oak/chene/brutx2	1109.19 × 362.74 × 38.00	0.015 m ³	0.009 m ³
Step #8	oak/chene/brutx2	916.35 × 313.44 × 38.00	0.011 m ³	0.008 m ³
Step #9	oak/chene/brutx2	843.50 × 303.60 × 38.00	0.010 m ³	0.008 m ³
Step #10	oak/chene/brutx2	804.43 × 286.91 × 38.00	0.009 m ³	0.008 m ³
Step #11	oak/chene/brutx2	785.60 × 269.27 × 38.00	0.008 m ³	0.008 m ³
Step #12	oak/chene/brutx2	780.00 × 100.00 × 38.00	0.003 m ³	0.003 m ³
Riser #1	oak/chene/brutx2	800.00 × 170.75 × 26.00	0.004 m ³	0.004 m ³
Riser #2	oak/chene/brutx2	800.51 × 208.75 × 26.00	0.004 m ³	0.004 m ³
Riser #3	oak/chene/brutx2	803.58 × 208.75 × 26.00	0.004 m ³	0.004 m ³
Riser #4	oak/chene/brutx2	814.82 × 208.75 × 26.00	0.004 m ³	0.004 m ³
Riser #5	oak/chene/brutx2	846.81 × 208.75 × 26.00	0.005 m ³	0.005 m ³
Riser #6	oak/chene/brutx2	933.92 × 208.75 × 26.00	0.005 m ³	0.005 m ³
Riser #7	oak/chene/brutx2	1034.70 × 208.75 × 26.00	0.006 m ³	0.005 m ³
Riser #8	oak/chene/brutx2	856.21 × 208.75 × 26.00	0.005 m ³	0.005 m ³
Riser #9	oak/chene/brutx2	804.07 × 208.75 × 26.00	0.004 m ³	0.004 m ³
Riser #10	oak/chene/brutx2	785.59 × 208.75 × 26.00	0.004 m ³	0.004 m ³
Riser #11	oak/chene/brutx2	780.74 × 208.75 × 26.00	0.004 m ³	0.004 m ³
Riser #12	oak/chene/brutx2	780.00 × 208.75 × 26.00	0.004 m ³	0.004 m ³
Left Cut String #1	pine	2116.47 × 393.64 × 50.00	0.042 m ³	0.023 m ³
Left Cut String #2	pine	2277.65 × 399.45 × 50.00	0.045 m ³	0.025 m ³
Right Cut String #1	oak/chene/brutx2	1044.00 × 1154.50 × 38.00	0.046 m ³	0.020 m ³
Right Cut String #2	pine	1833.88 × 361.47 × 50.00	0.033 m ³	0.017 m ³

Wooddesigner & Atelierbois

Material	Cutting List Volume	Real Volume	Weight	Price
Steps				
oak/chene/brutx2	0.125 m ³	0.095 m ³	80.59 kg	437,61 €
Risers				
oak/chene/brutx2	0.054 m ³	0.053 m ³	45.33 kg	187,97 €
Lateral Cut Strings				
oak/chene/brutx2	0.046 m ³	0.020 m ³	17.41 kg	160,30 €
pine	0.120 m ³	0.065 m ³	16.26 kg	72,17 €
Total	0.345 m³	0.233 m³	159.59 kg	858,05 €