

Multi-Flight Stair		Riser Height	202.08 mm
Risers	12	Tread Width	171.38 mm
Floor Height	2425.00 mm	Stair Rule	575.55 mm

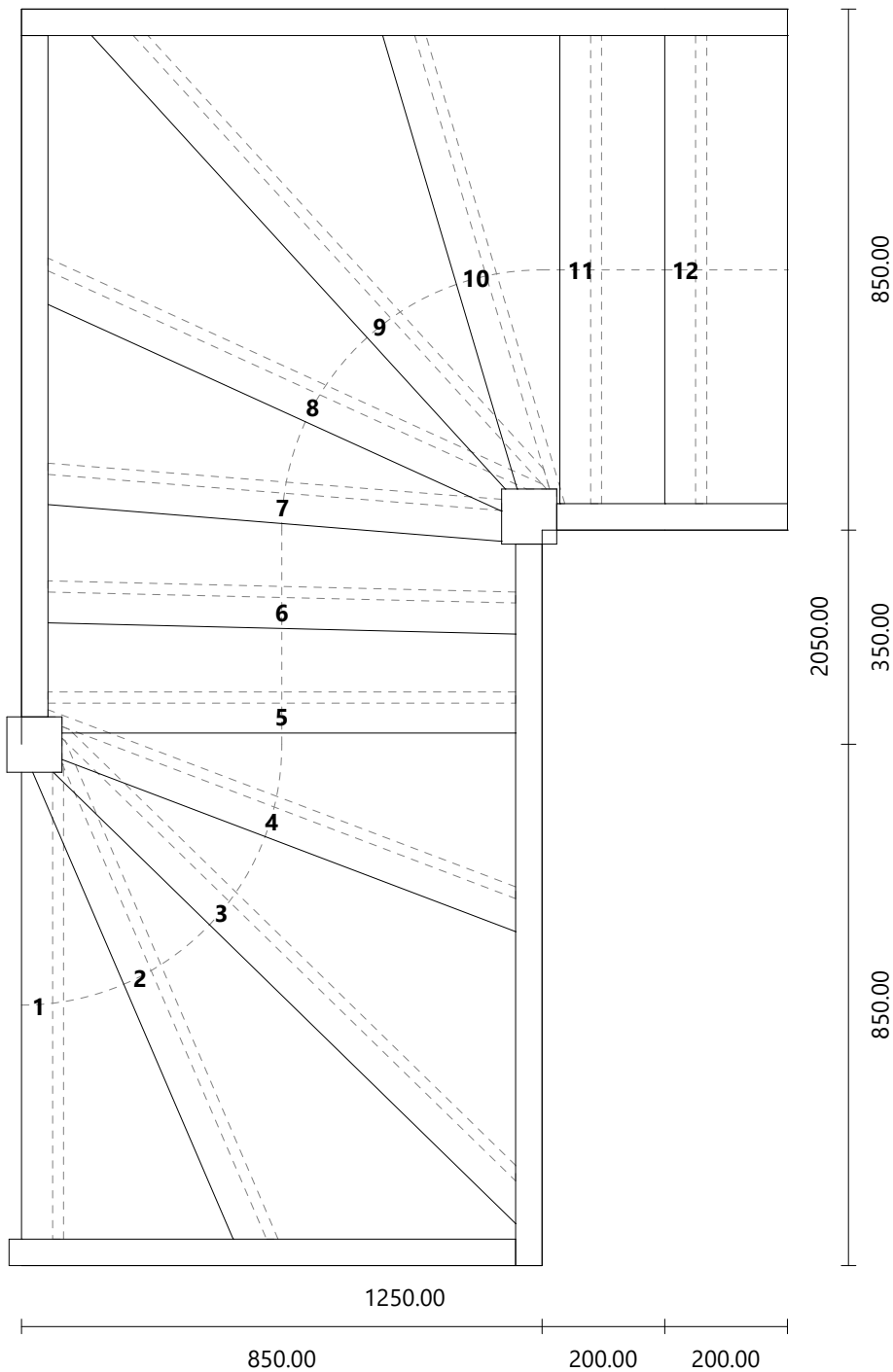

Step

Material Z-wall-white  
Dimensions 792.00 × 406.07 mm  
Thickness 26.00 mm

Riser

Material Z-wall-white  
Dimensions 792.00 × 186.08 mm  
Thickness 18.00 mm  
Angle Right: 0°

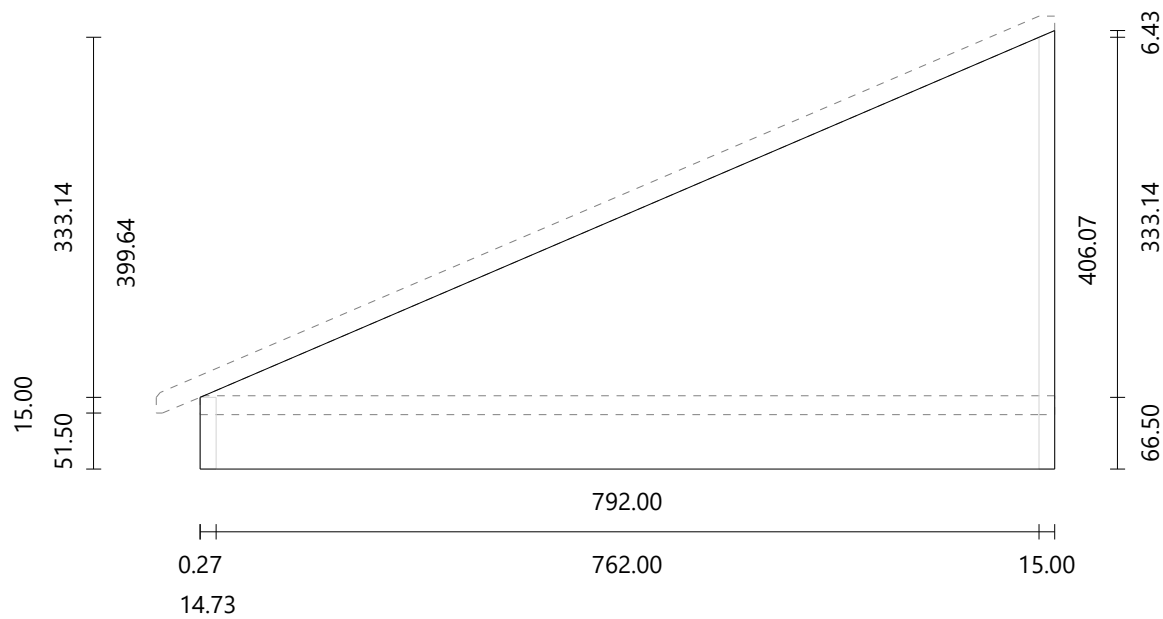

# Wooddesigner & Atelierbois

Step

Material      Z-wall-white  
Dimensions    1068.55 × 469.70 mm  
Thickness      26.00 mm

Riser

Material      Z-wall-white  
Dimensions    909.79 × 212.08 mm  
Thickness      18.00 mm

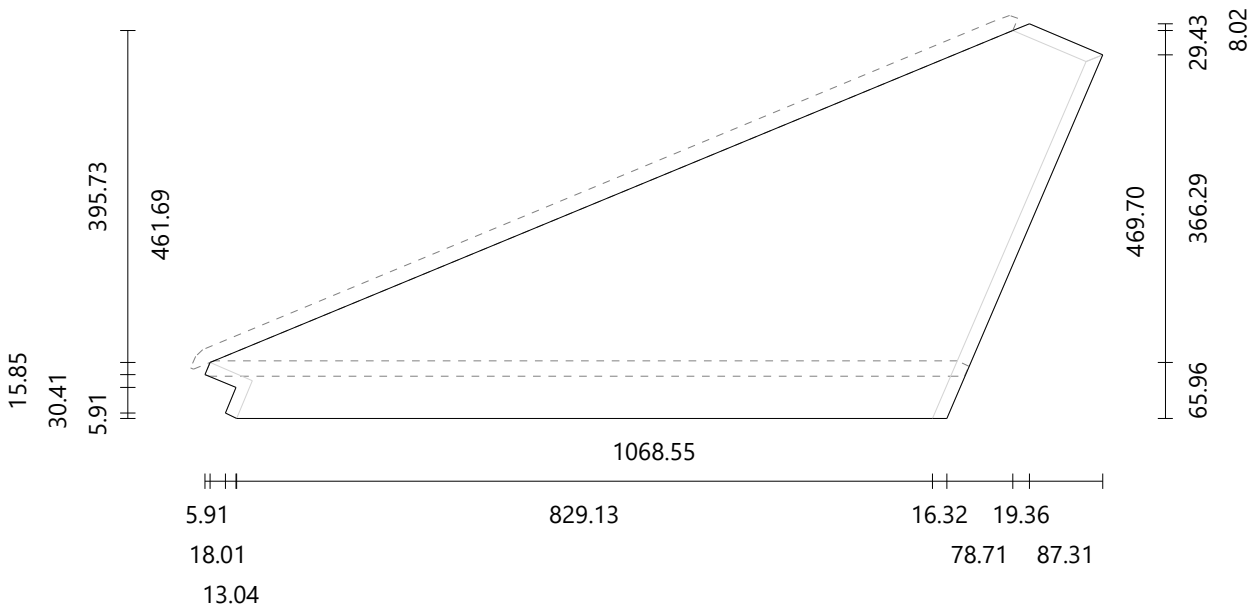

Step

Material      Z-wall-white  
Dimensions    1117.77 × 386.15 mm  
Thickness      26.00 mm

Riser

Material      Z-wall-white  
Dimensions    1068.98 × 212.08 mm  
Thickness      18.00 mm

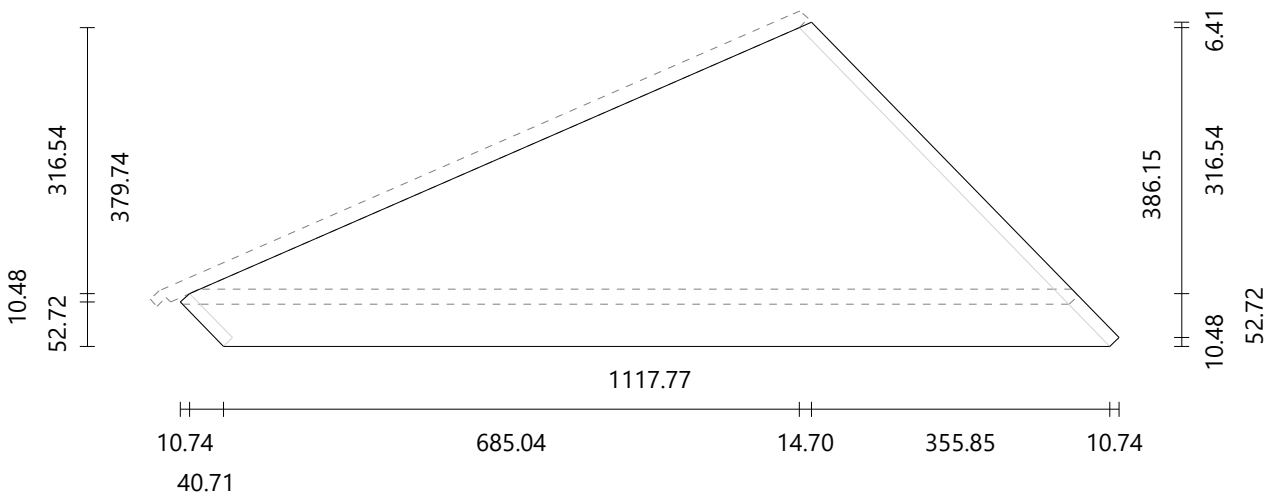

Step

Material      Z-wall-white  
Dimensions    874.64 × 354.19 mm  
Thickness      26.00 mm

Riser

Material      Z-wall-white  
Dimensions    851.78 × 212.08 mm  
Thickness      18.00 mm

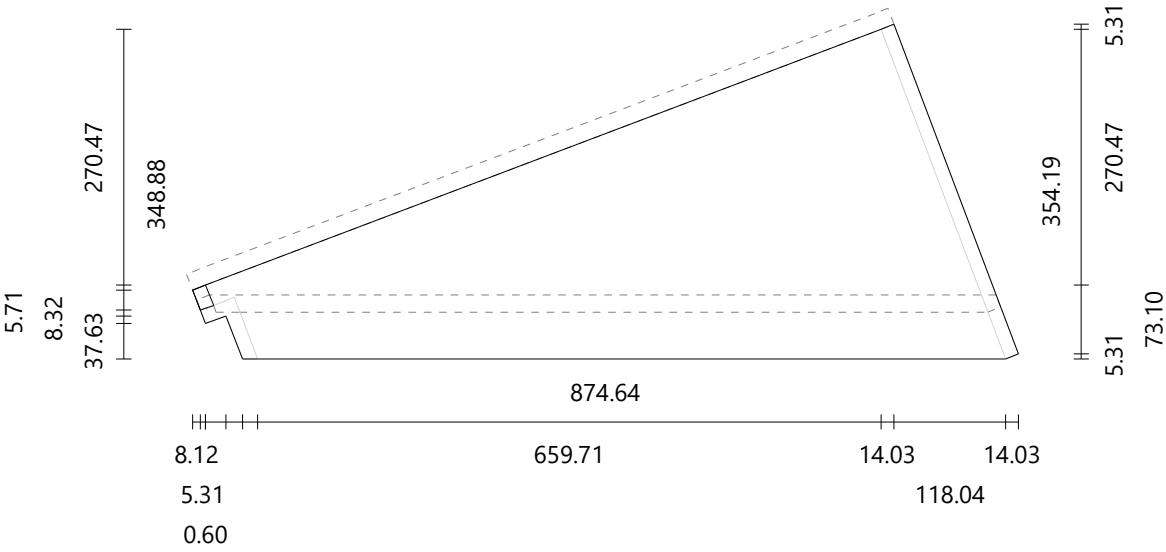

Step

Material      Z-wall-white  
Dimensions    794.00 × 230.62 mm  
Thickness      26.00 mm

Riser

Material      Z-wall-white  
Dimensions    794.00 × 212.08 mm  
Thickness      18.00 mm  
Angle          0°

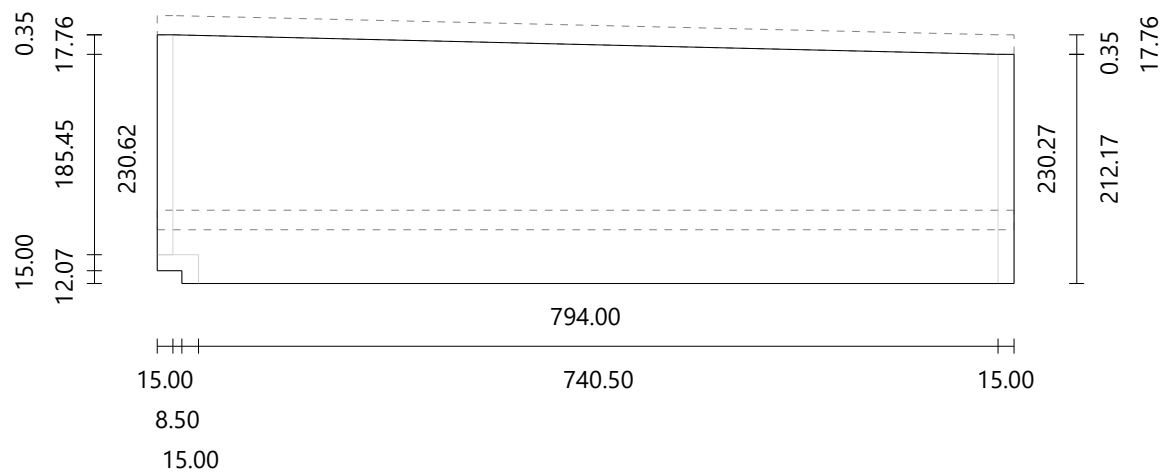

Step

Material Z-wall-white  
Dimensions 799.88 × 243.91 mm  
Thickness 26.00 mm

Riser

Material Z-wall-white  
Dimensions 794.62 × 212.08 mm  
Thickness 18.00 mm

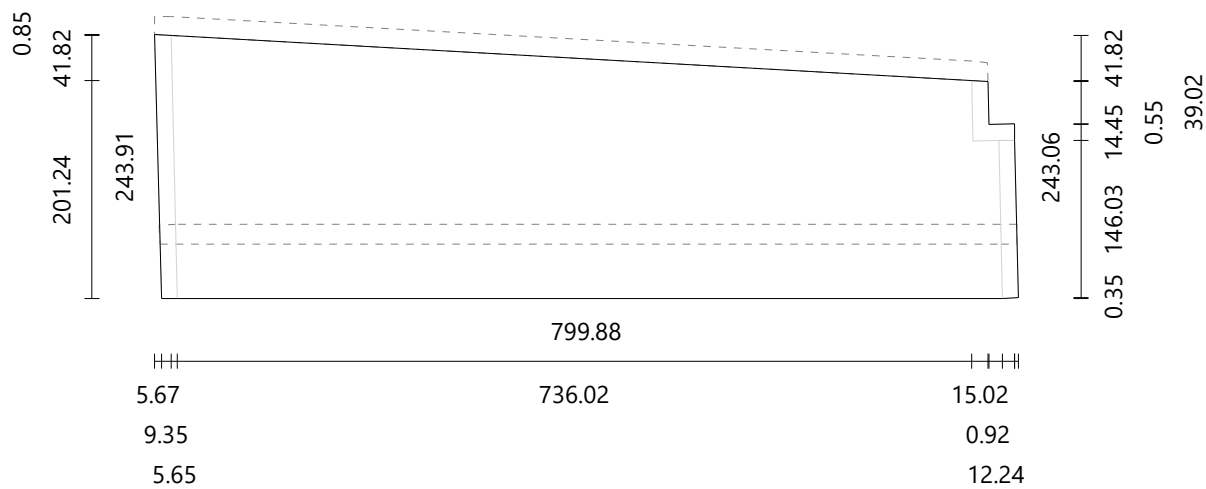

Step

Material Z-wall-white  
Dimensions 824.34 × 386.78 mm  
Thickness 26.00 mm

Riser

Material Z-wall-white  
Dimensions 774.19 × 212.08 mm  
Thickness 18.00 mm

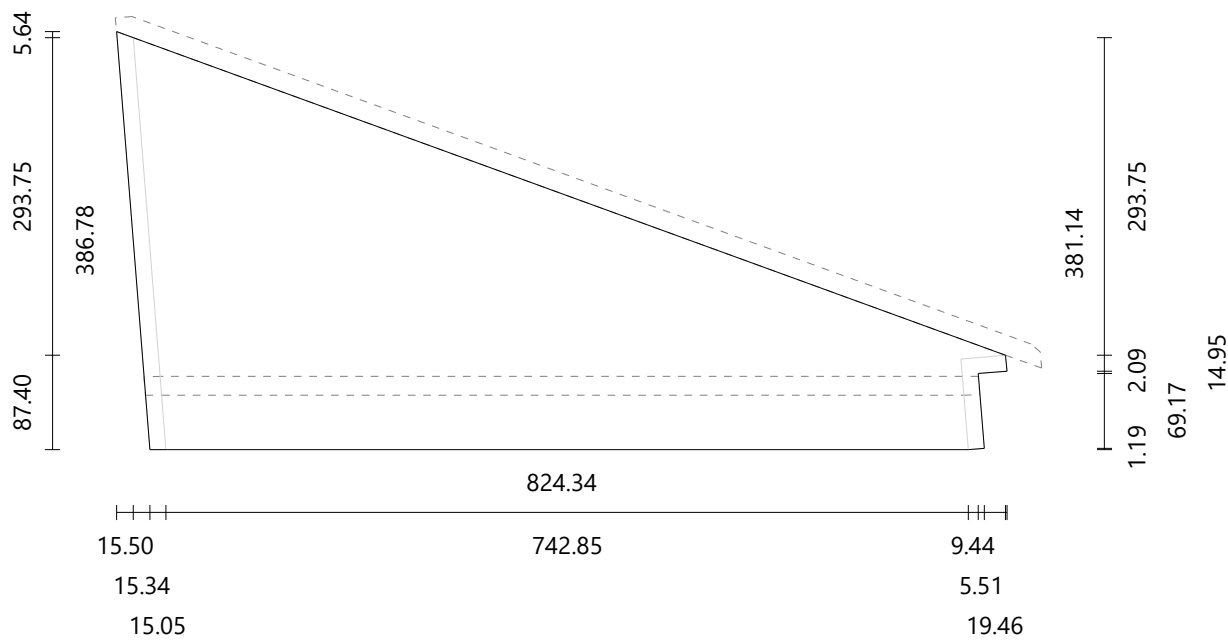



Step

Material Z-wall-white  
Dimensions 1074.20 × 464.56 mm  
Thickness 26.00 mm

Riser

Material Z-wall-white  
Dimensions 916.77 × 212.08 mm  
Thickness 18.00 mm

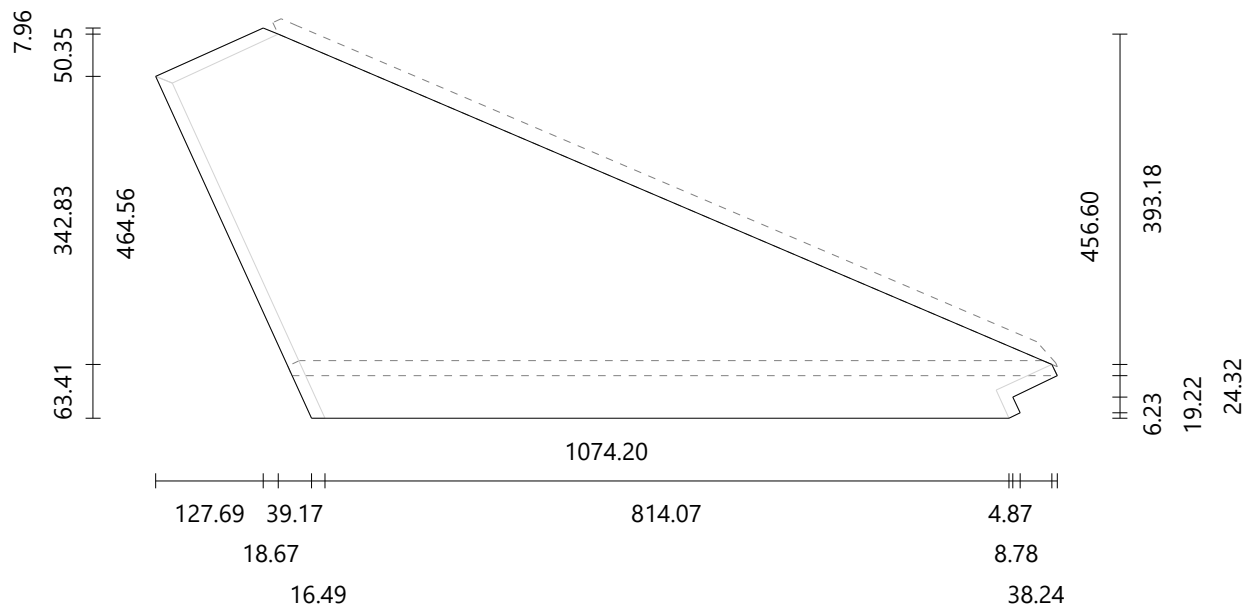

Step

Material Z-wall-white  
Dimensions 1072.56 × 396.61 mm  
Thickness 26.00 mm

Riser

Material Z-wall-white  
Dimensions 1019.32 × 212.08 mm  
Thickness 18.00 mm

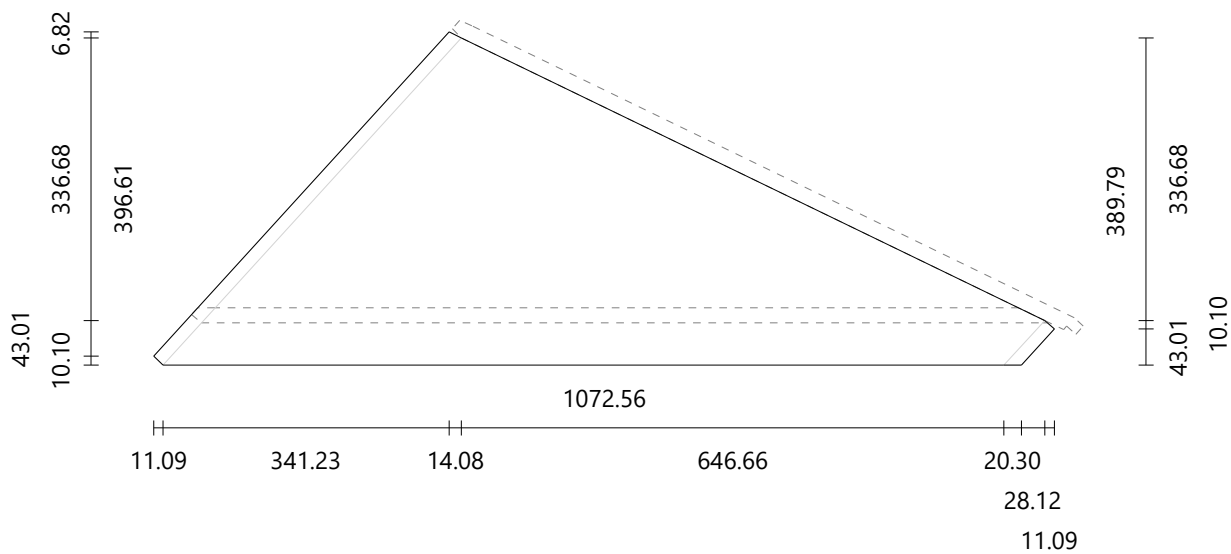

Step

Material      Z-wall-white  
Dimensions    857.58 × 329.24 mm  
Thickness      26.00 mm

Riser

Material      Z-wall-white  
Dimensions    830.94 × 212.08 mm  
Thickness      18.00 mm

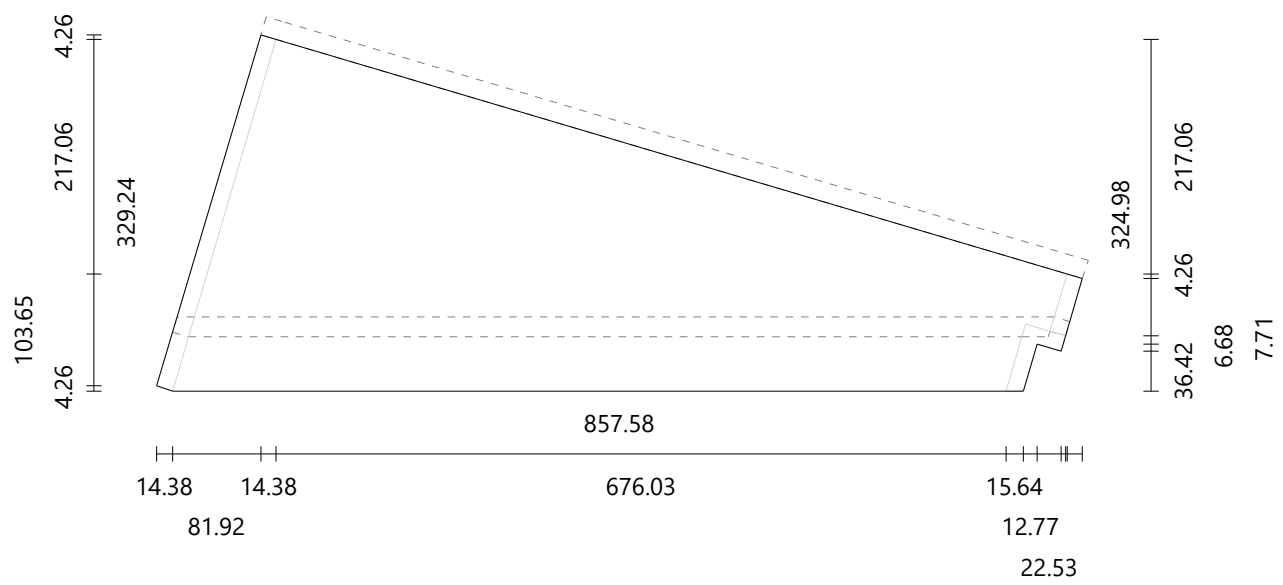

Step

Material        Z-wall-white  
Dimensions    794.00 × 221.38 mm  
Thickness      26.00 mm

Riser

Material        Z-wall-white  
Dimensions    794.00 × 212.08 mm  
Thickness      18.00 mm  
Angle            0°

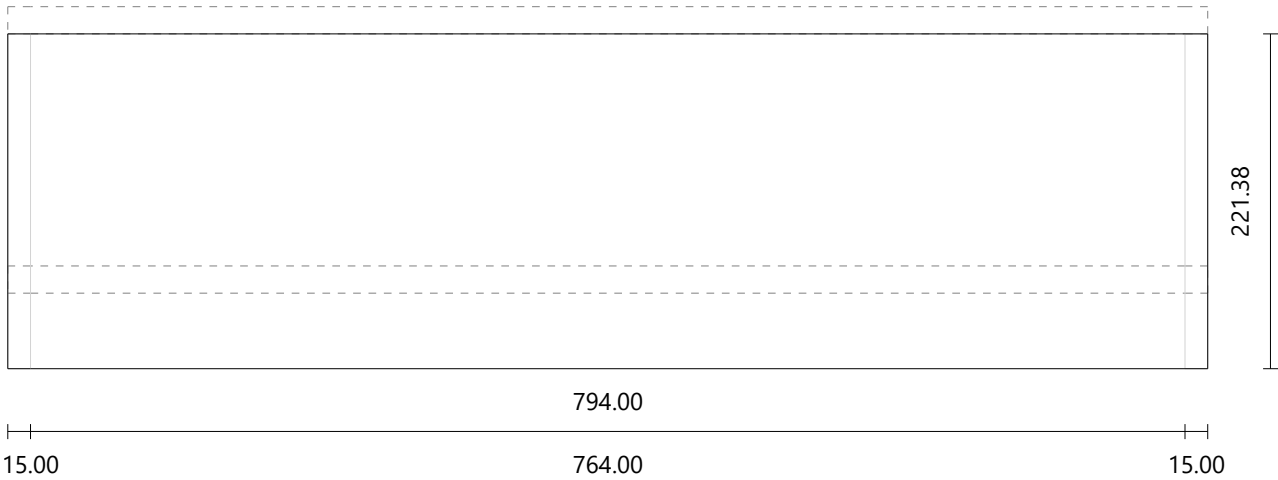

Step

Material        Z-wall-white  
Dimensions    794.00 × 200.00 mm  
Thickness      26.00 mm

Riser

Material        Z-wall-white  
Dimensions    794.00 × 212.08 mm  
Thickness      18.00 mm  
Angle          0°

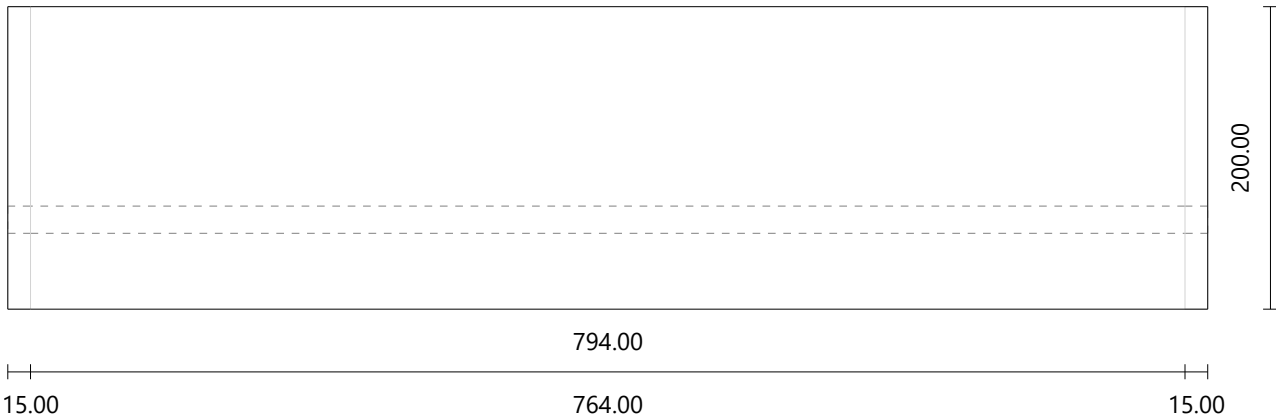

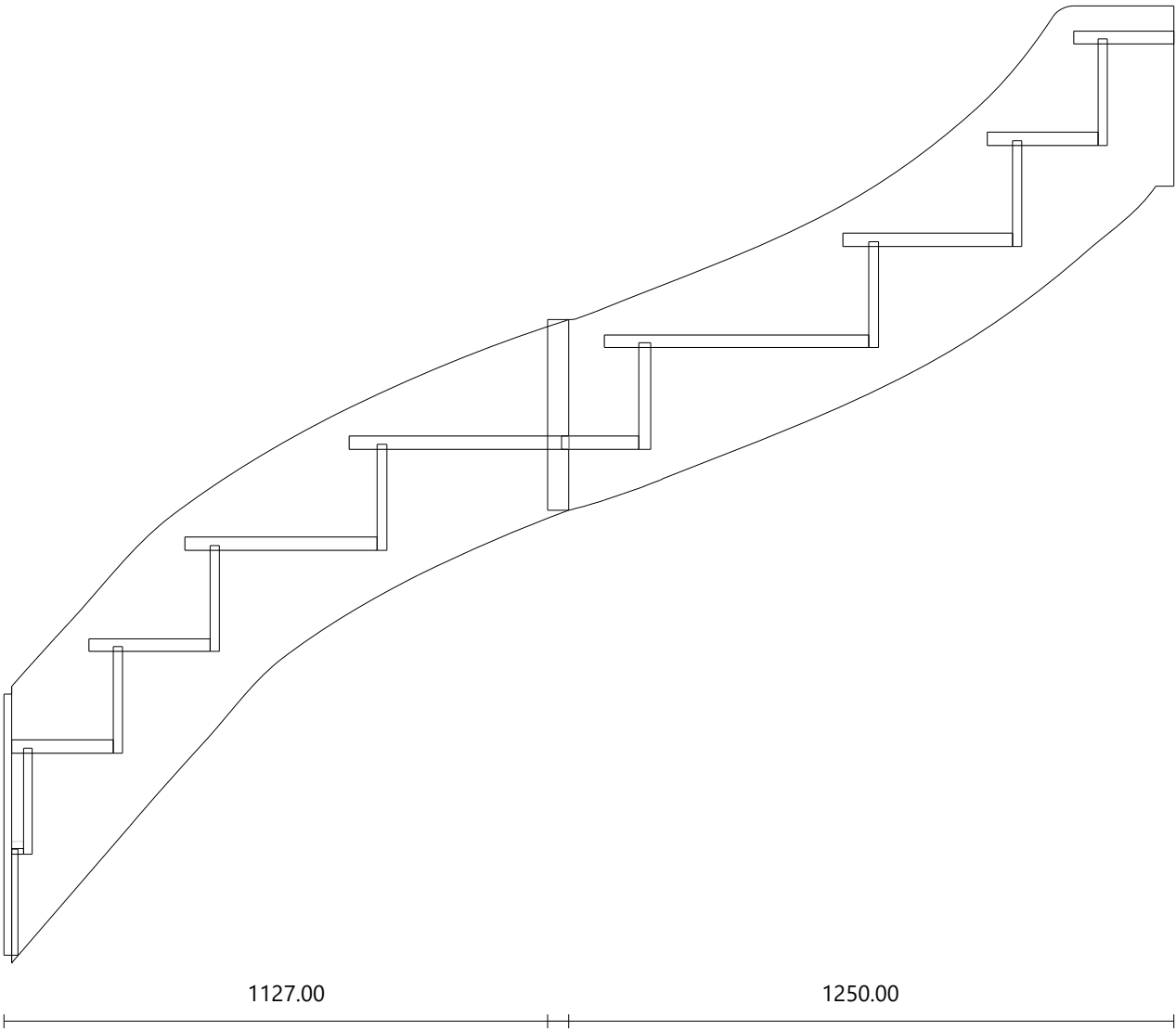

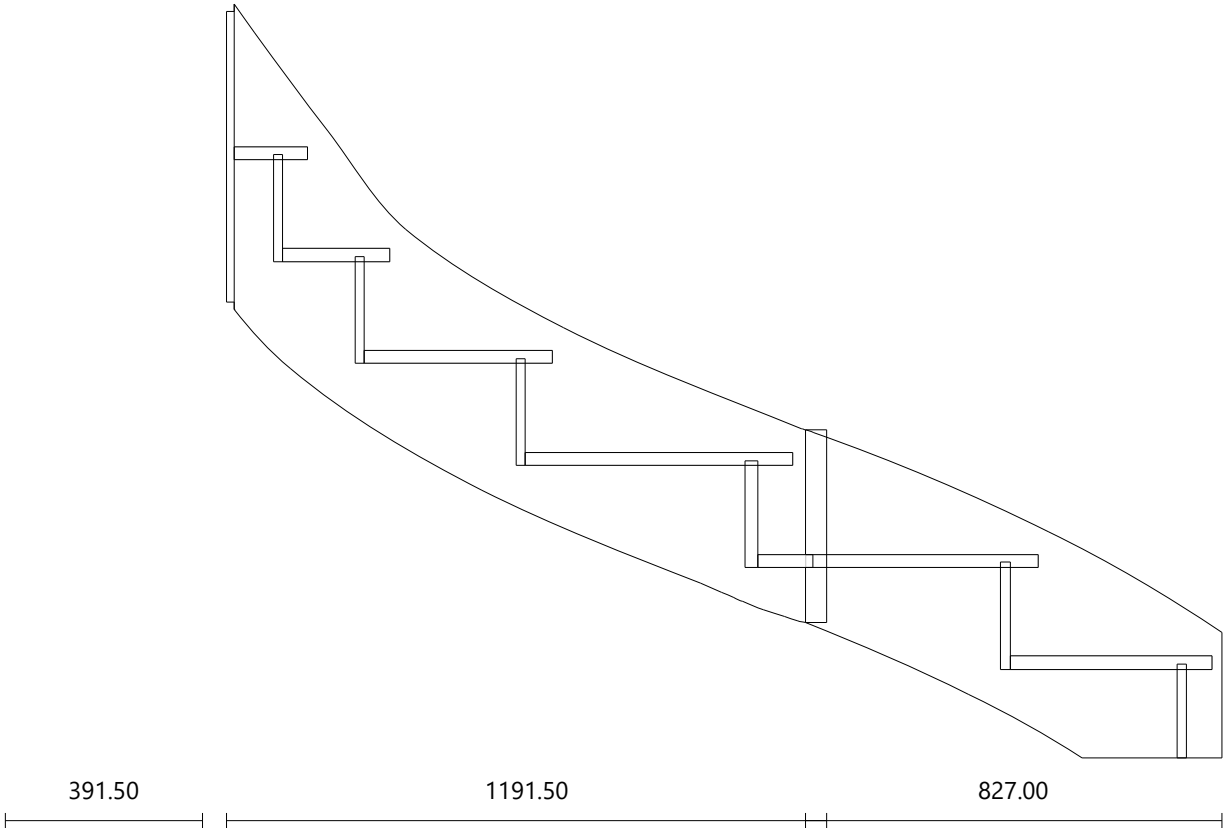
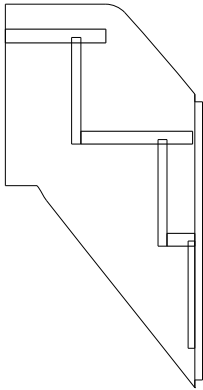

Material      Z-wall-white  
Dimensions    1674.39 × 491.14 mm  
Thickness      43.00 mm

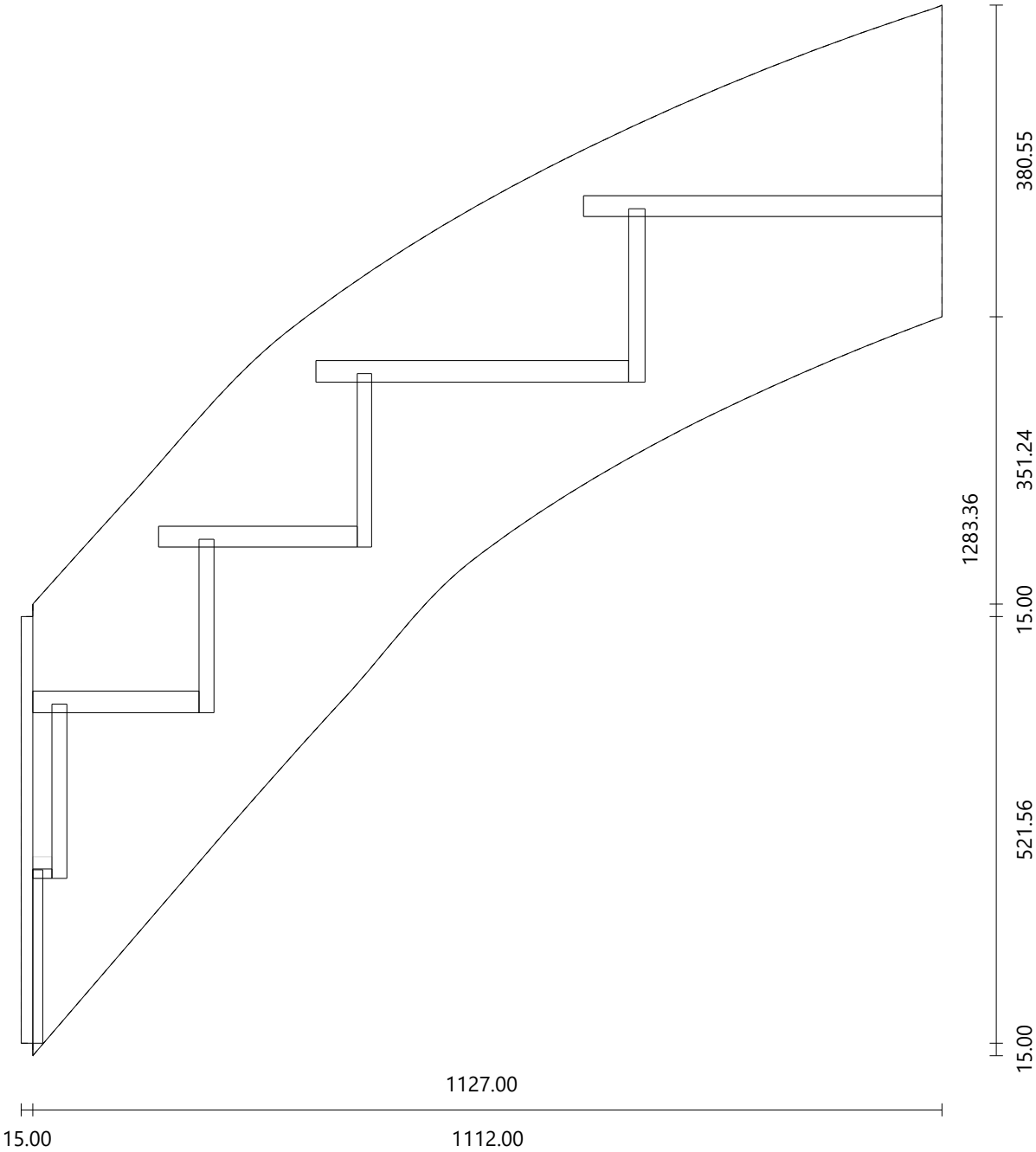



Material      Z-wall-white  
 Dimensions    1590.45 × 469.75 mm  
 Thickness      43.00 mm

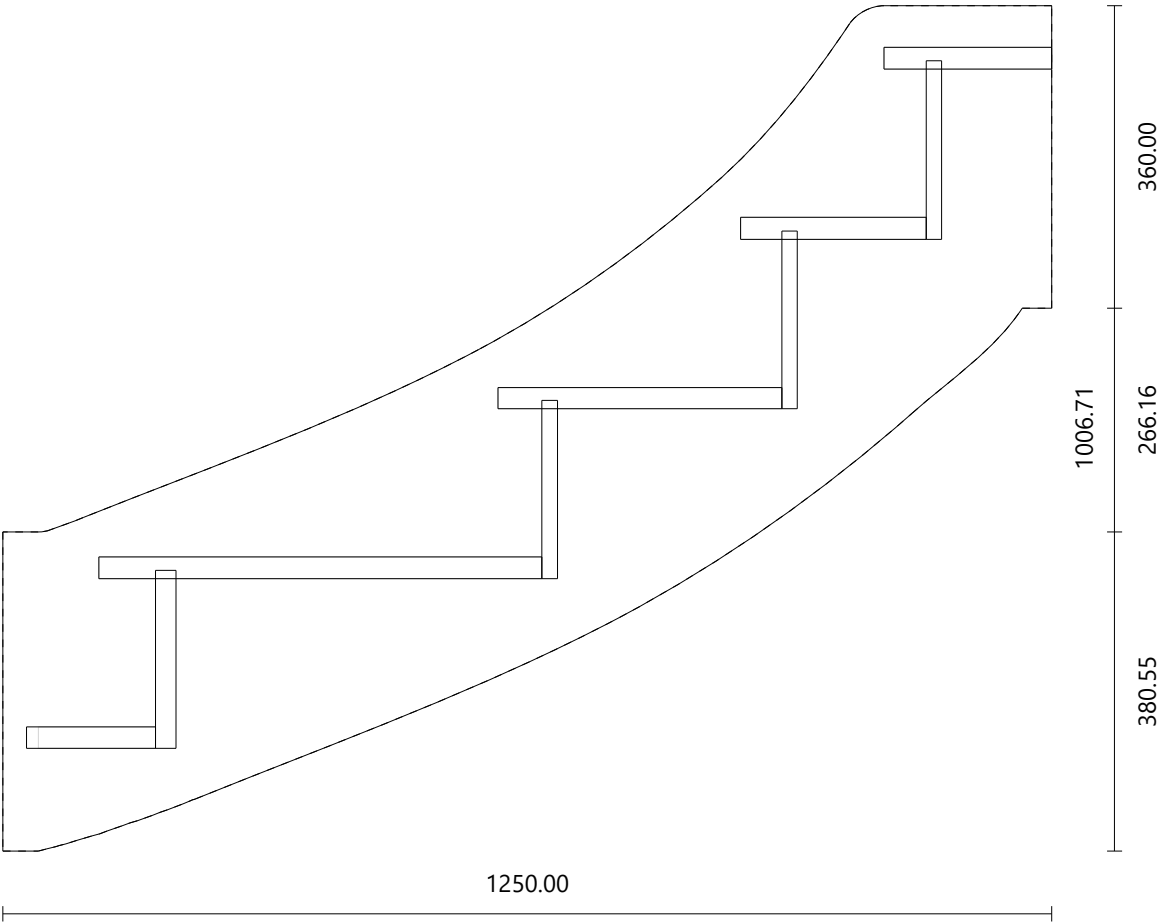

Material      Z-wall-white  
Dimensions    1028.89 × 374.77 mm  
Thickness      43.00 mm

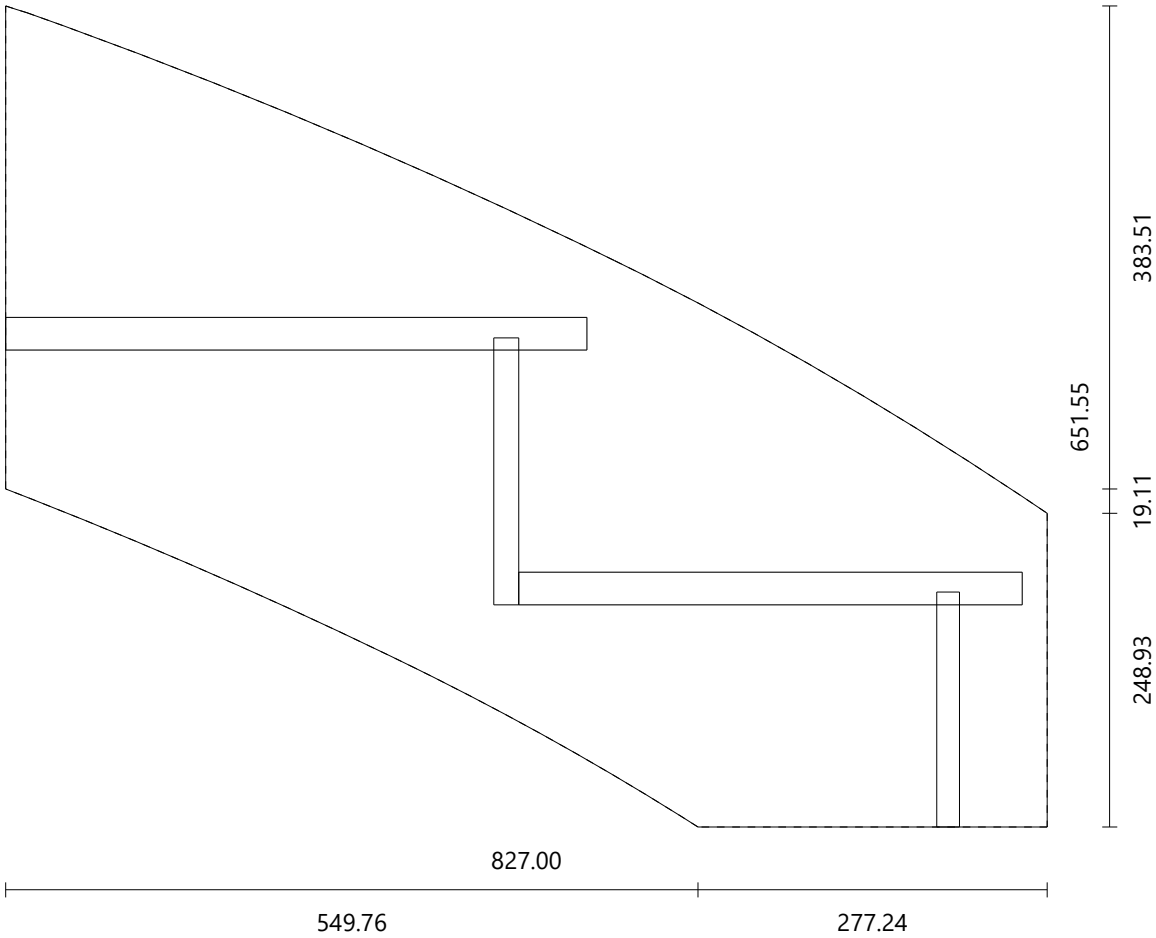

Material      Z-wall-white  
 Dimensions    1675.08 × 527.27 mm  
 Thickness      43.00 mm

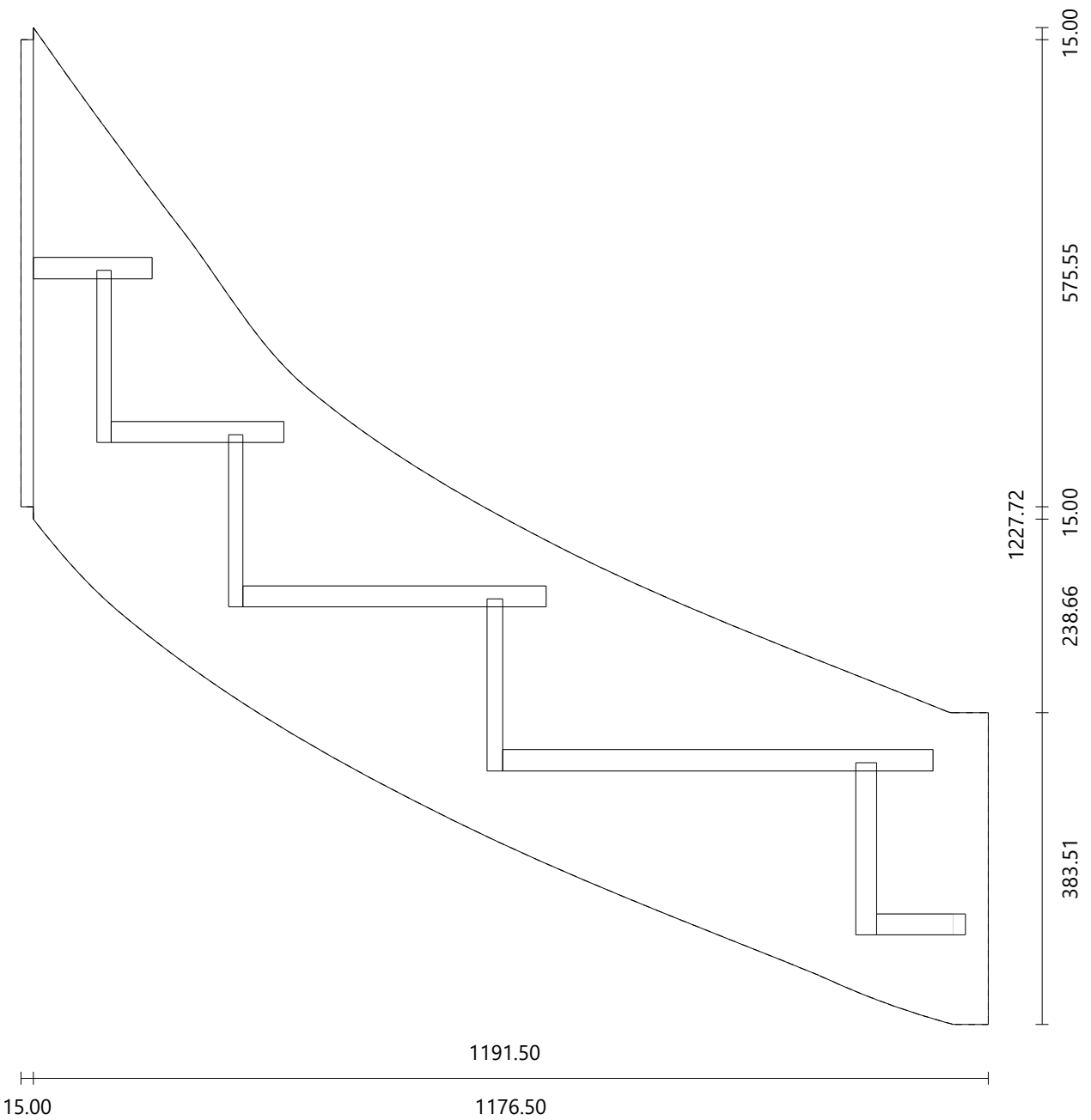

Material      Z-wall-white  
 Dimensions   391.50 × 760.78 mm  
 Thickness    43.00 mm

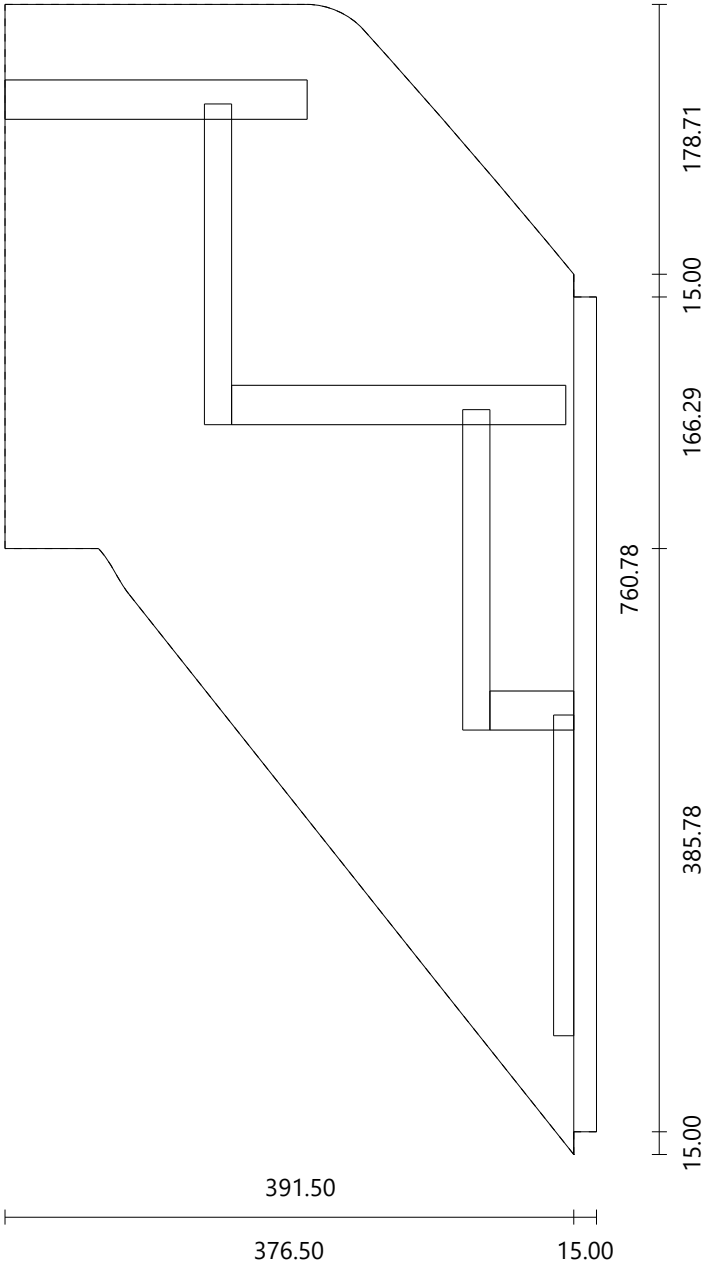

End Newel Post      Left Side      Flights: 1-2      Top View

Material      Z-wall-white  
Dimensions      90.00 × 90.00 mm  
Height      1917.05 mm

Step #1      Height: 202.08 mm  
Step #2      Height: 404.17 mm  
Step #3      Height: 606.25 mm  
Step #4      Height: 808.33 mm  
Step #5      Height: 1010.42 mm

Face 2      Left Stringboard #1

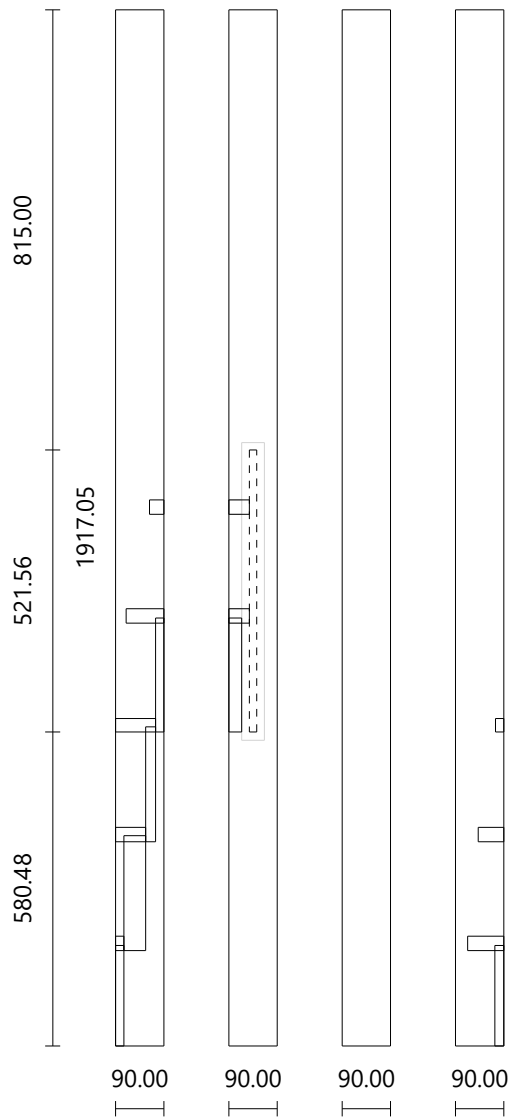
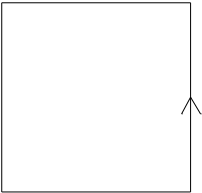

# Wooddesigner & Atelierbois

Corner Newel Post      Right Side      Flights: 2-3      Top View

Material      Z-wall-white  
Dimensions      90.00 × 90.00 mm  
Height      1506.08 mm

Step #6      Height: 372.29 mm  
Step #7      Height: 574.37 mm  
Step #8      Height: 776.45 mm  
Step #9      Height: 978.54 mm  
Step #10      Height: 1180.62 mm

Face 1      Right Stringboard #3  
Face 4      Right Stringboard #2

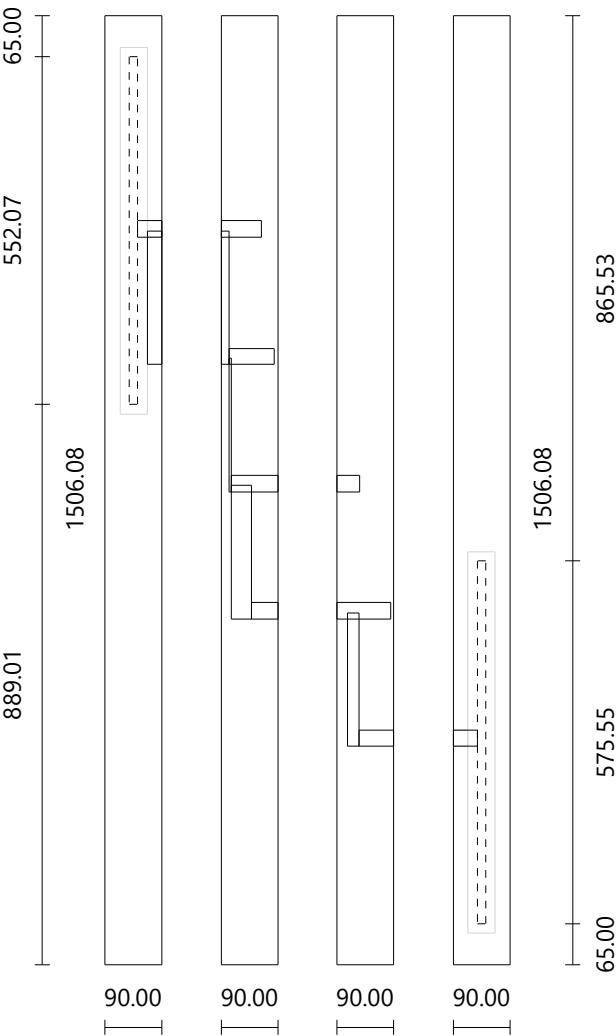
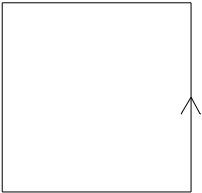

# Wooddesigner & Atelierbois

Part	Material	Dimensions	Cutting List Volume	Real Volume
Step #1	Z-wall-white	792.00 × 406.07 × 26.00	0.008 m <sup>3</sup>	0.005 m <sup>3</sup>
Step #2	Z-wall-white	1068.55 × 469.70 × 26.00	0.013 m <sup>3</sup>	0.007 m <sup>3</sup>
Step #3	Z-wall-white	1117.77 × 386.15 × 26.00	0.011 m <sup>3</sup>	0.006 m <sup>3</sup>
Step #4	Z-wall-white	874.64 × 354.19 × 26.00	0.008 m <sup>3</sup>	0.005 m <sup>3</sup>
Step #5	Z-wall-white	794.00 × 230.62 × 26.00	0.005 m <sup>3</sup>	0.005 m <sup>3</sup>
Step #6	Z-wall-white	799.88 × 243.91 × 26.00	0.005 m <sup>3</sup>	0.005 m <sup>3</sup>
Step #7	Z-wall-white	824.34 × 386.78 × 26.00	0.008 m <sup>3</sup>	0.005 m <sup>3</sup>
Step #8	Z-wall-white	1074.20 × 464.56 × 26.00	0.013 m <sup>3</sup>	0.007 m <sup>3</sup>
Step #9	Z-wall-white	1072.56 × 396.61 × 26.00	0.011 m <sup>3</sup>	0.006 m <sup>3</sup>
Step #10	Z-wall-white	857.58 × 329.24 × 26.00	0.007 m <sup>3</sup>	0.005 m <sup>3</sup>
Step #11	Z-wall-white	794.00 × 221.38 × 26.00	0.005 m <sup>3</sup>	0.005 m <sup>3</sup>
Step #12	Z-wall-white	794.00 × 200.00 × 26.00	0.004 m <sup>3</sup>	0.004 m <sup>3</sup>
Riser #1	Z-wall-white	792.00 × 186.08 × 18.00	0.003 m <sup>3</sup>	0.003 m <sup>3</sup>
Riser #2	Z-wall-white	909.79 × 212.08 × 18.00	0.003 m <sup>3</sup>	0.003 m <sup>3</sup>
Riser #3	Z-wall-white	1068.98 × 212.08 × 18.00	0.004 m <sup>3</sup>	0.004 m <sup>3</sup>
Riser #4	Z-wall-white	851.78 × 212.08 × 18.00	0.003 m <sup>3</sup>	0.003 m <sup>3</sup>
Riser #5	Z-wall-white	794.00 × 212.08 × 18.00	0.003 m <sup>3</sup>	0.003 m <sup>3</sup>
Riser #6	Z-wall-white	794.62 × 212.08 × 18.00	0.003 m <sup>3</sup>	0.003 m <sup>3</sup>
Riser #7	Z-wall-white	774.19 × 212.08 × 18.00	0.003 m <sup>3</sup>	0.003 m <sup>3</sup>
Riser #8	Z-wall-white	916.77 × 212.08 × 18.00	0.003 m <sup>3</sup>	0.003 m <sup>3</sup>
Riser #9	Z-wall-white	1019.32 × 212.08 × 18.00	0.004 m <sup>3</sup>	0.004 m <sup>3</sup>
Riser #10	Z-wall-white	830.94 × 212.08 × 18.00	0.003 m <sup>3</sup>	0.003 m <sup>3</sup>
Riser #11	Z-wall-white	794.00 × 212.08 × 18.00	0.003 m <sup>3</sup>	0.003 m <sup>3</sup>
Riser #12	Z-wall-white	794.00 × 212.08 × 18.00	0.003 m <sup>3</sup>	0.003 m <sup>3</sup>
Left Stringboard #1	Z-wall-white	1674.39 × 491.14 × 43.00	0.035 m <sup>3</sup>	0.022 m <sup>3</sup>
Left Stringboard #2	Z-wall-white	1590.45 × 469.75 × 43.00	0.032 m <sup>3</sup>	0.022 m <sup>3</sup>
Right Stringboard #1	Z-wall-white	1028.89 × 374.77 × 43.00	0.017 m <sup>3</sup>	0.013 m <sup>3</sup>
Right Stringboard #2	Z-wall-white	1675.08 × 527.27 × 43.00	0.038 m <sup>3</sup>	0.022 m <sup>3</sup>
Right Stringboard #3	Z-wall-white	391.50 × 760.78 × 43.00	0.013 m <sup>3</sup>	0.008 m <sup>3</sup>
Newel Post #1	Z-wall-white	90.00 × 90.00 × 1917.05	0.016 m <sup>3</sup>	0.016 m <sup>3</sup>
Newel Post #2	Z-wall-white	90.00 × 90.00 × 1506.08	0.012 m <sup>3</sup>	0.012 m <sup>3</sup>

## Wooddesigner & Atelierbois

Part	Material	Cutting List Volume	Real Volume	Weight	Price
Steps	Z-wall-white	0.099 m <sup>3</sup>	0.063 m <sup>3</sup>		
Risers	Z-wall-white	0.039 m <sup>3</sup>	0.039 m <sup>3</sup>		
Stringboards	Z-wall-white	0.135 m <sup>3</sup>	0.088 m <sup>3</sup>		
Newel Posts	Z-wall-white	0.028 m <sup>3</sup>	0.028 m <sup>3</sup>		
<b>Total</b>		<b>0.301 m<sup>3</sup></b>	<b>0.218 m<sup>3</sup></b>		