

Multi-Flight Stair		Riser Height	210.83 mm
Risers	12	Tread Width	204.33 mm
Floor Height	2530.00 mm	Stair Rule	625.99 mm

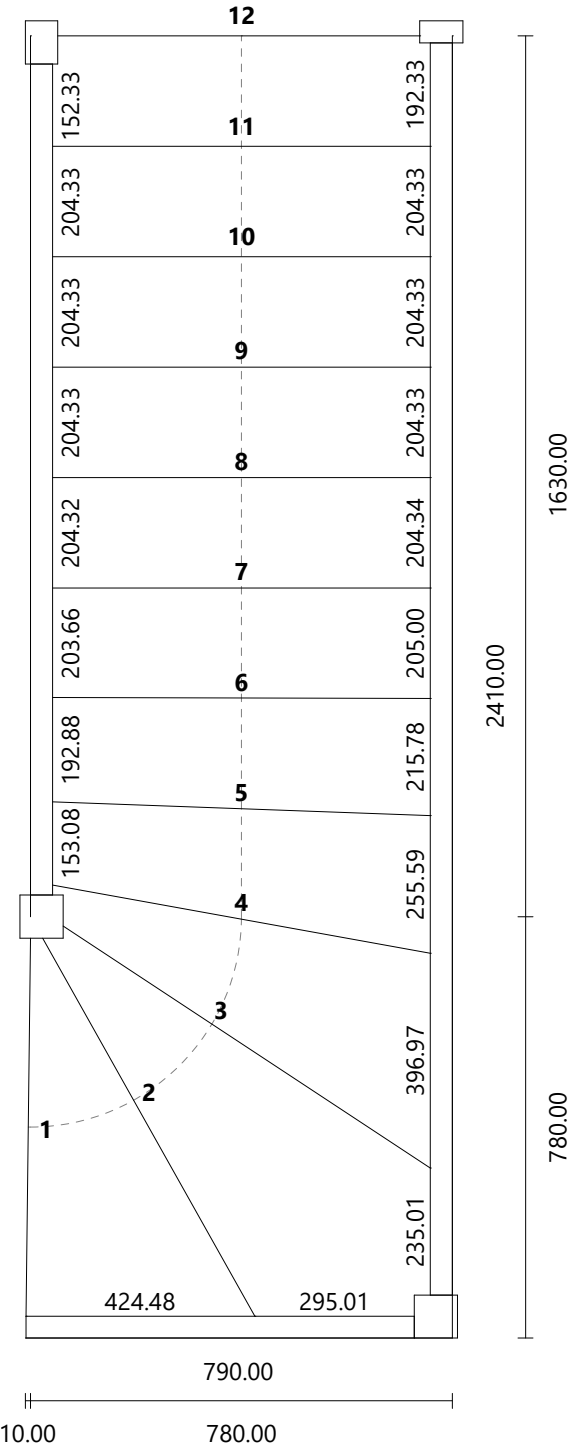

Material        Default  
Dimensions    735.65 × 456.80 mm  
Thickness      40.00 mm

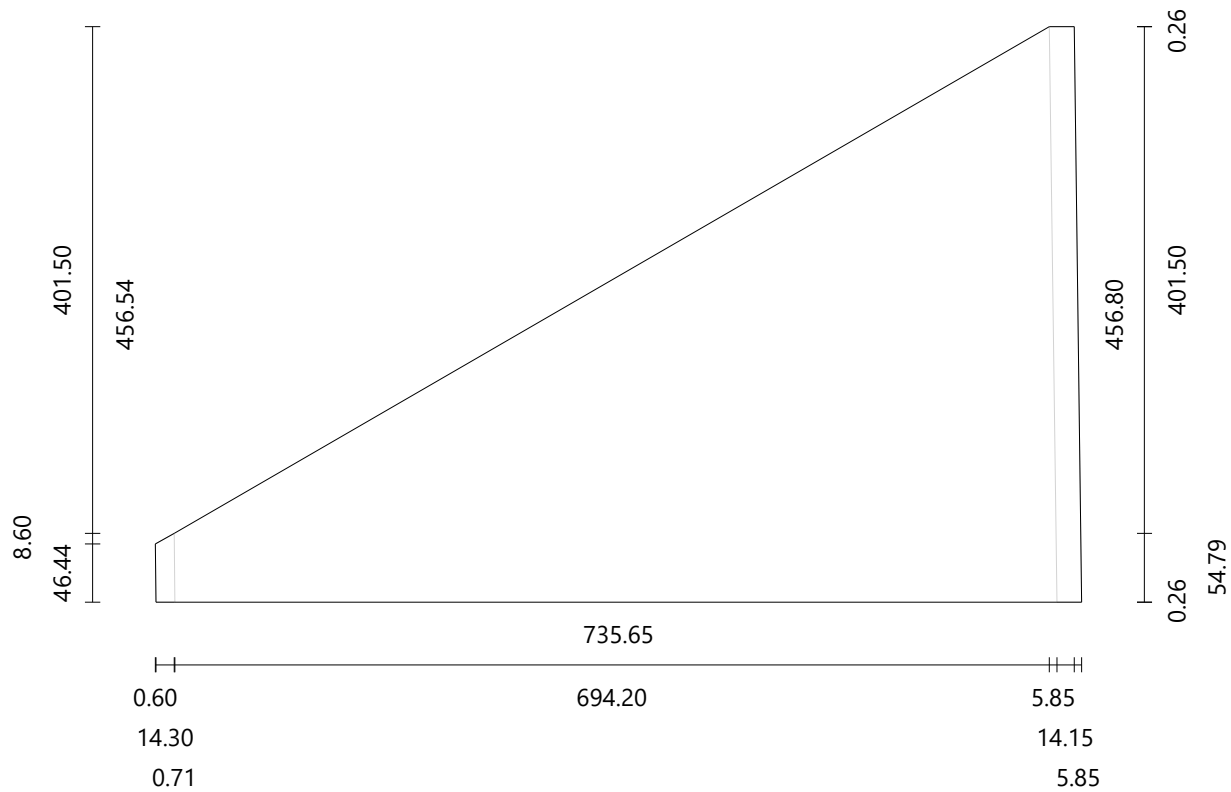

Material        Default  
Dimensions    1001.53 × 445.40 mm  
Thickness      40.00 mm

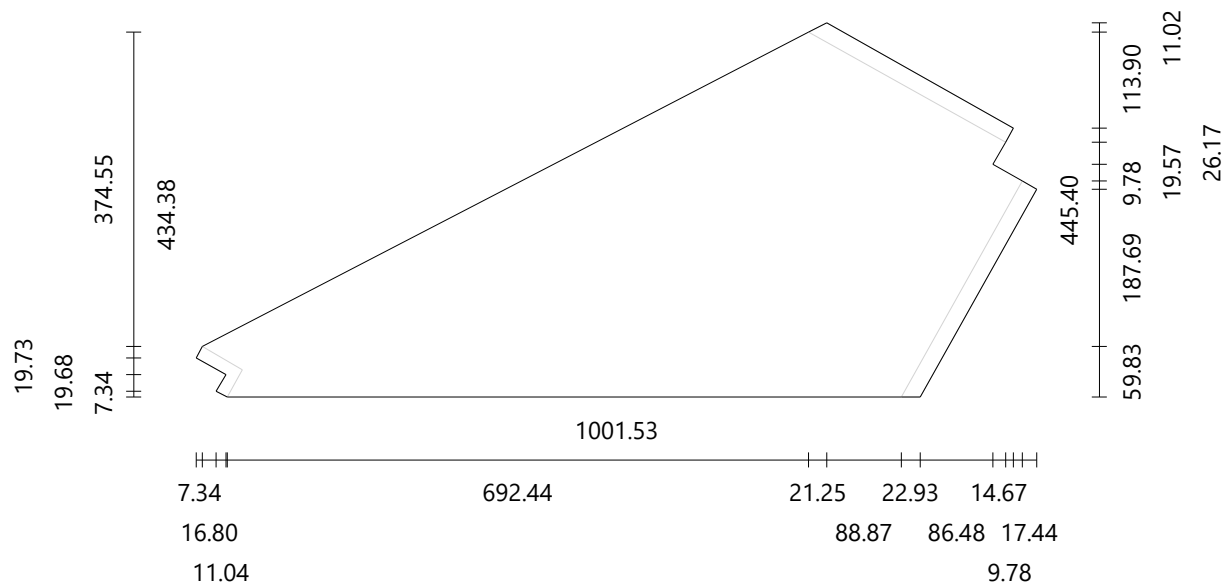

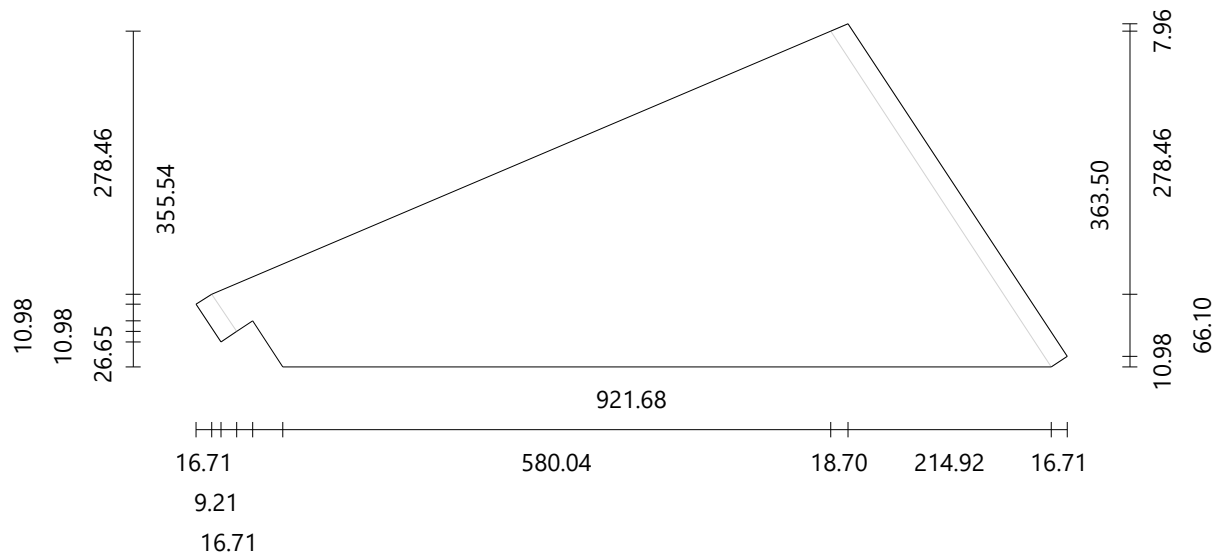

Material        Default  
Dimensions    783.02 × 281.95 mm  
Thickness      40.00 mm

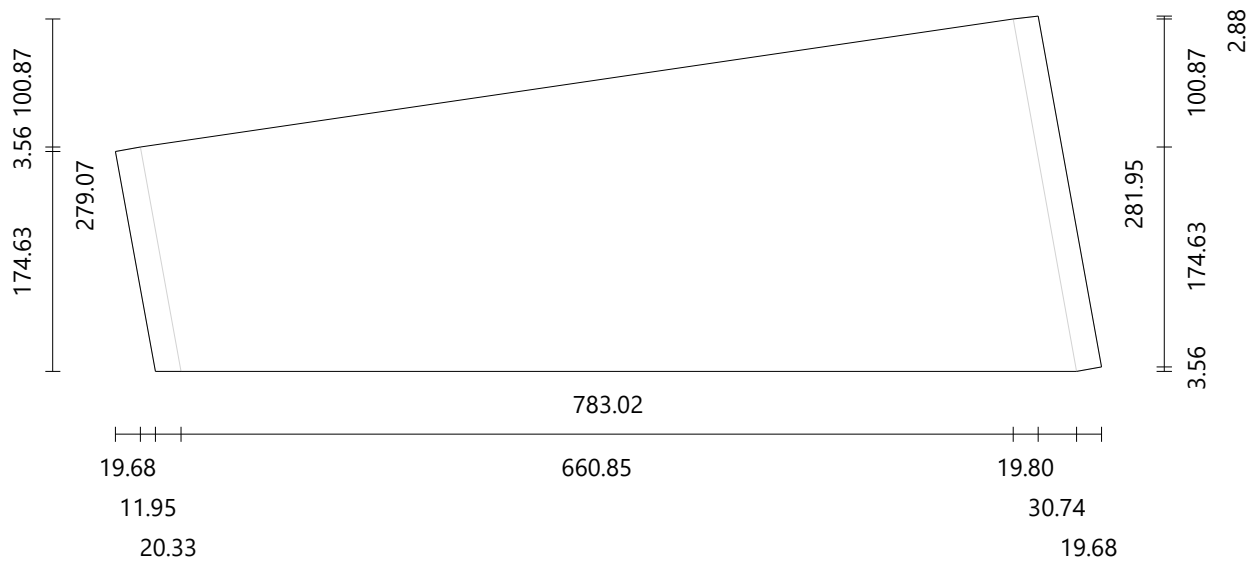

Material        Default  
Dimensions    748.05 × 244.29 mm  
Thickness     40.00 mm

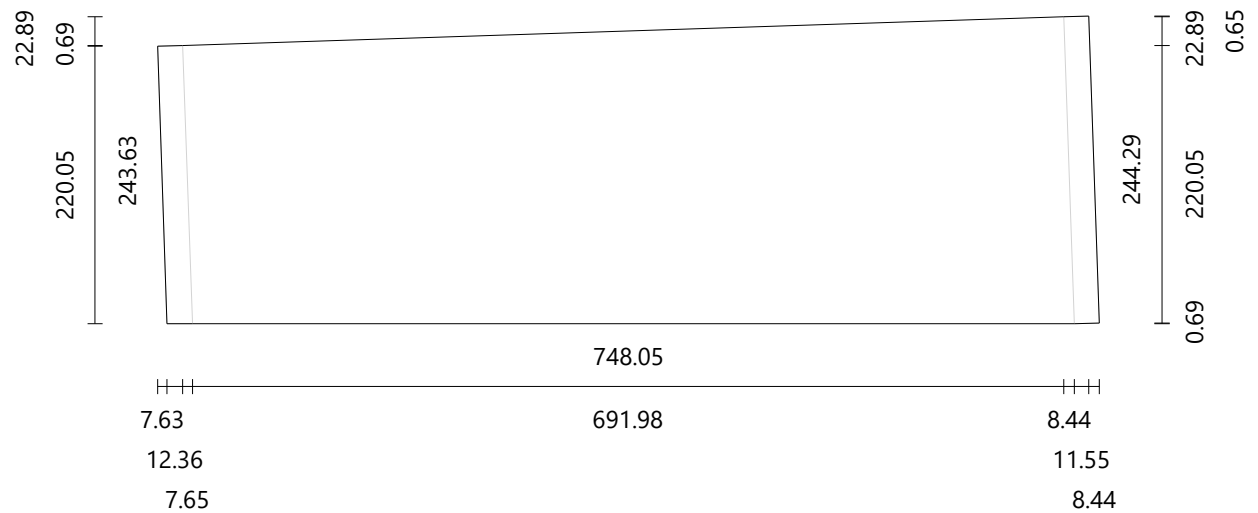

Material        Default  
Dimensions    740.45 × 233.03 mm  
Thickness      40.00 mm

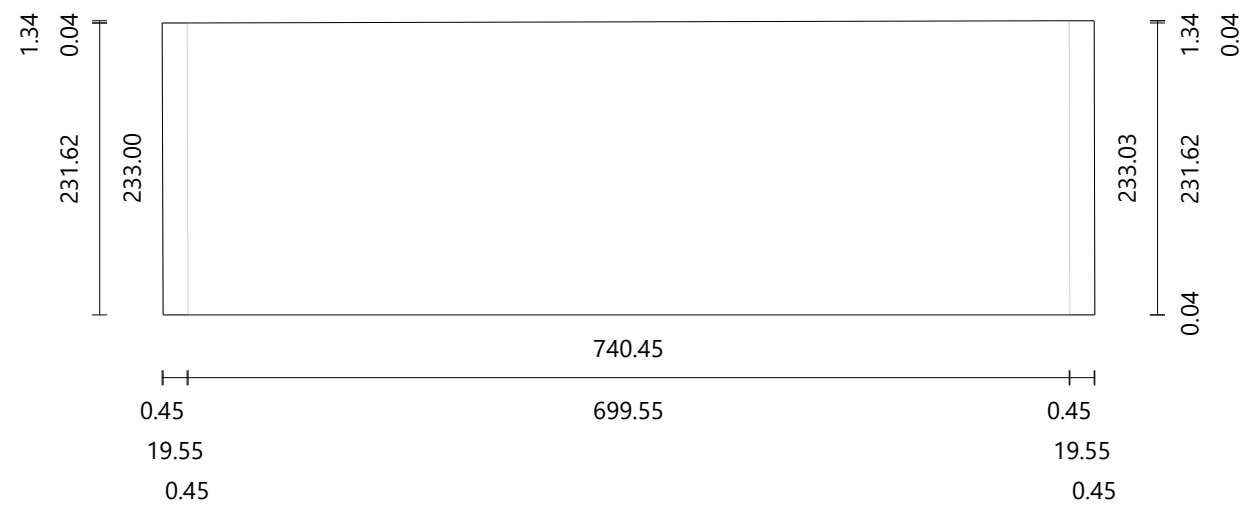

Material        Default  
Dimensions    740.01 × 232.34 mm  
Thickness     40.00 mm

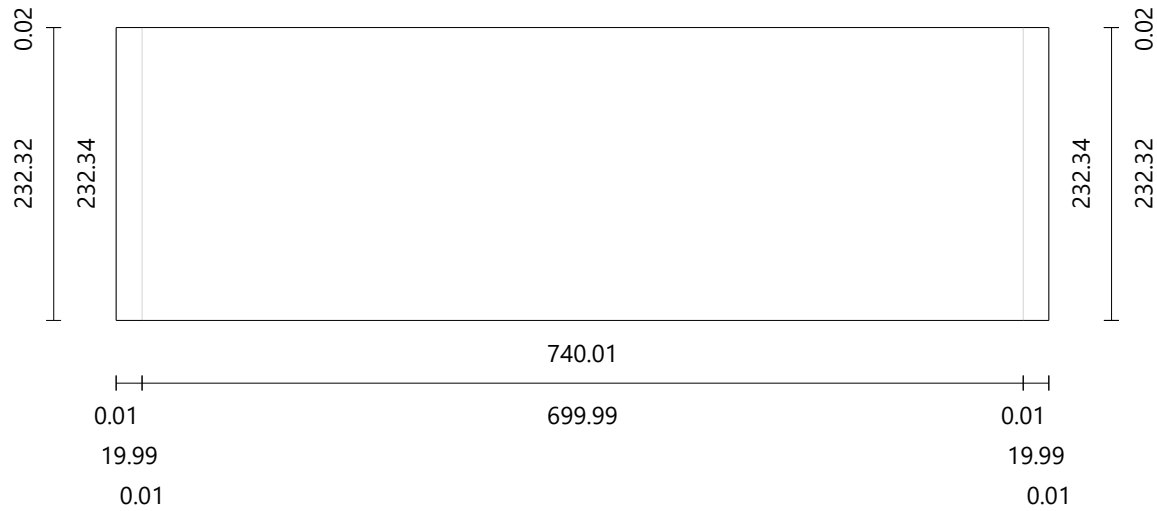

Material        Default  
Dimensions    740.00 × 232.33 mm  
Thickness      40.00 mm

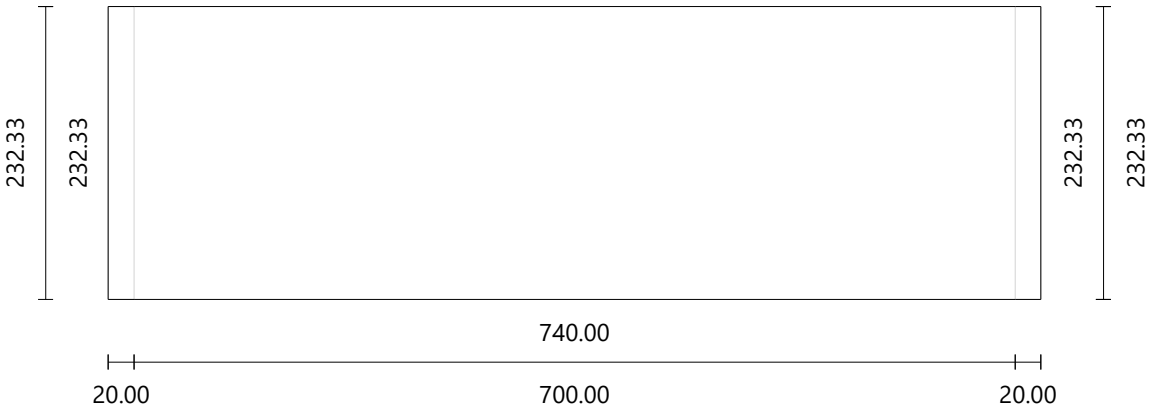

Material Default  
Dimensions 730.00 × 232.33 mm  
Thickness 40.00 mm

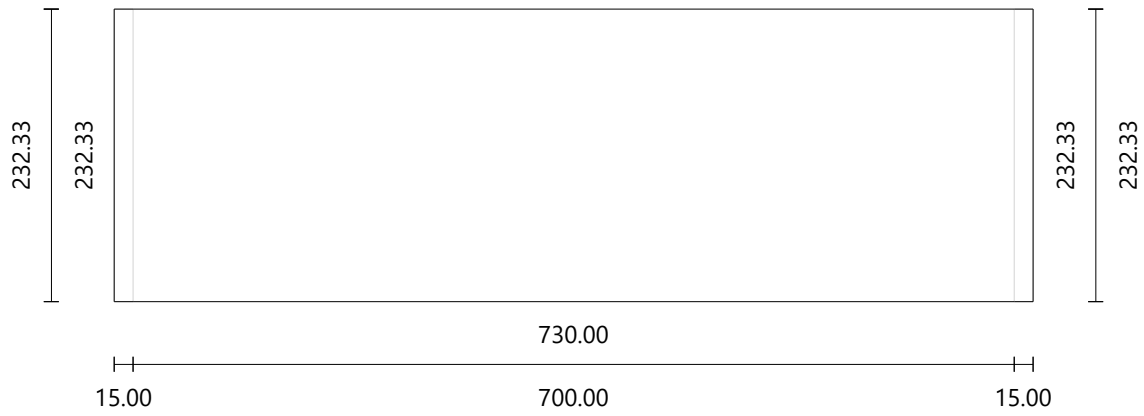

Material        Default  
Dimensions    740.00 × 232.33 mm  
Thickness      40.00 mm

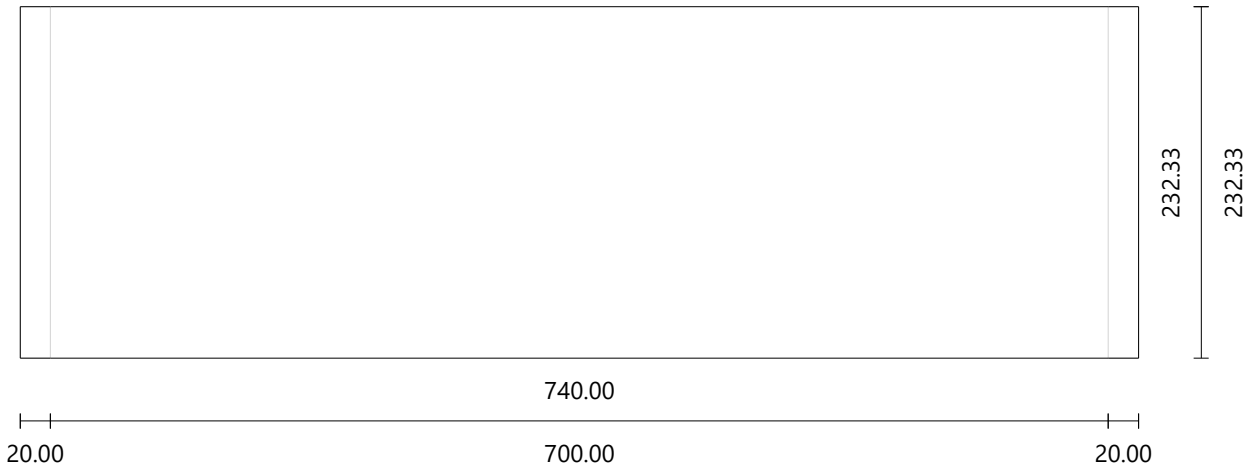

Material        Default  
Dimensions    740.00 × 226.33 mm  
Thickness     40.00 mm

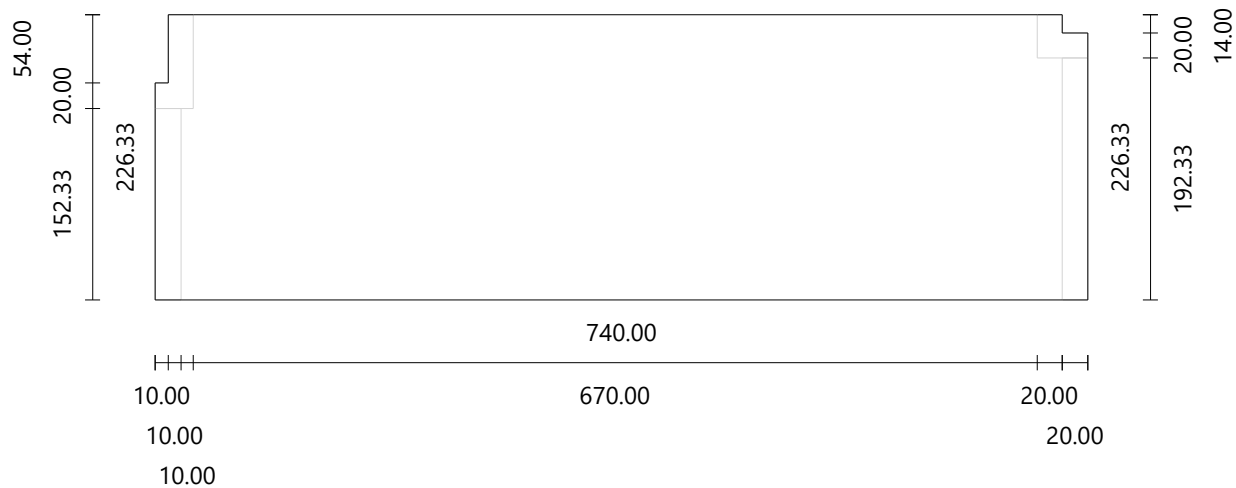

Material        Default  
Dimensions    780.00 × 32.00 mm  
Thickness      40.00 mm

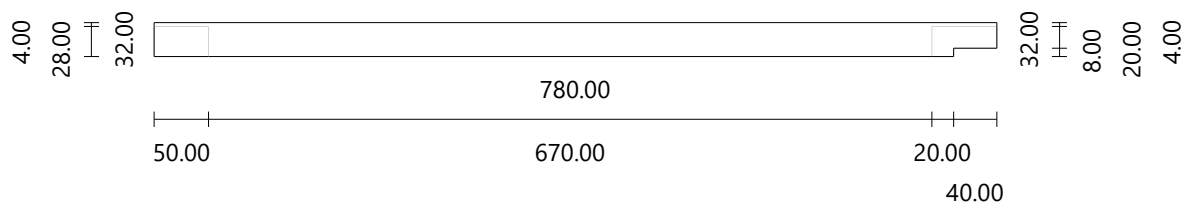

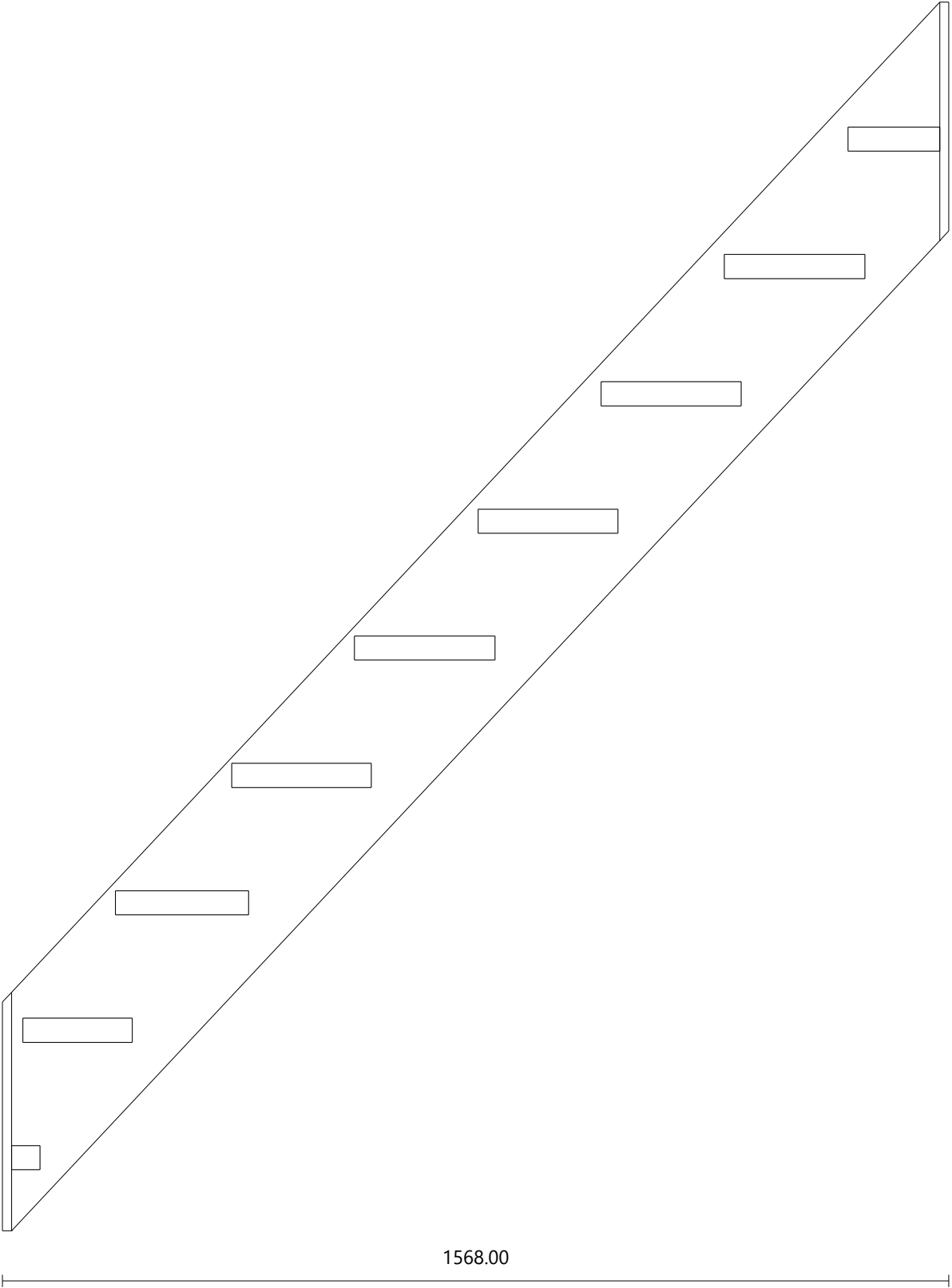

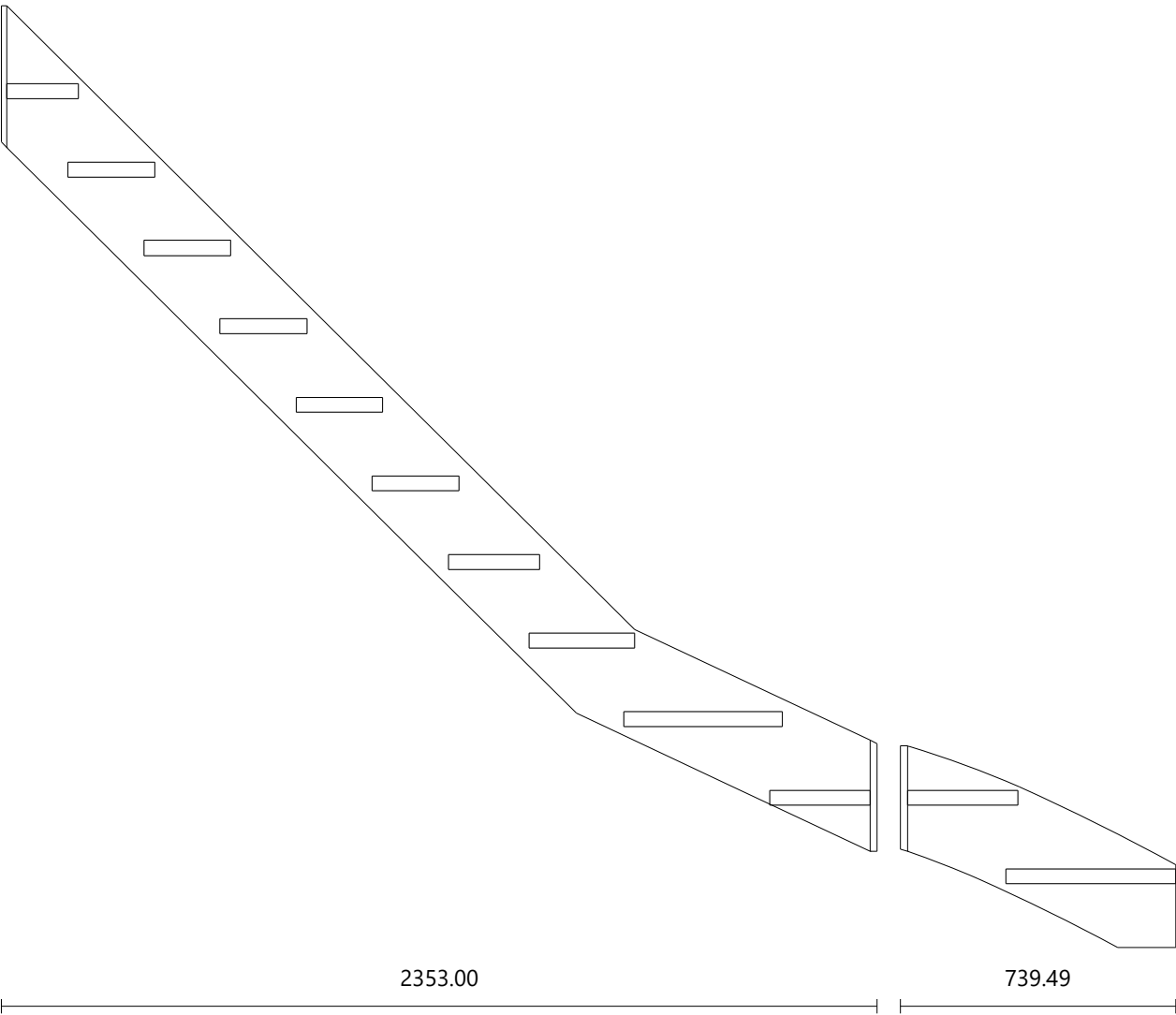

Material      Z\_wall\_white  
Dimensions    2556.87 × 270.00 mm  
Thickness     40.00 mm

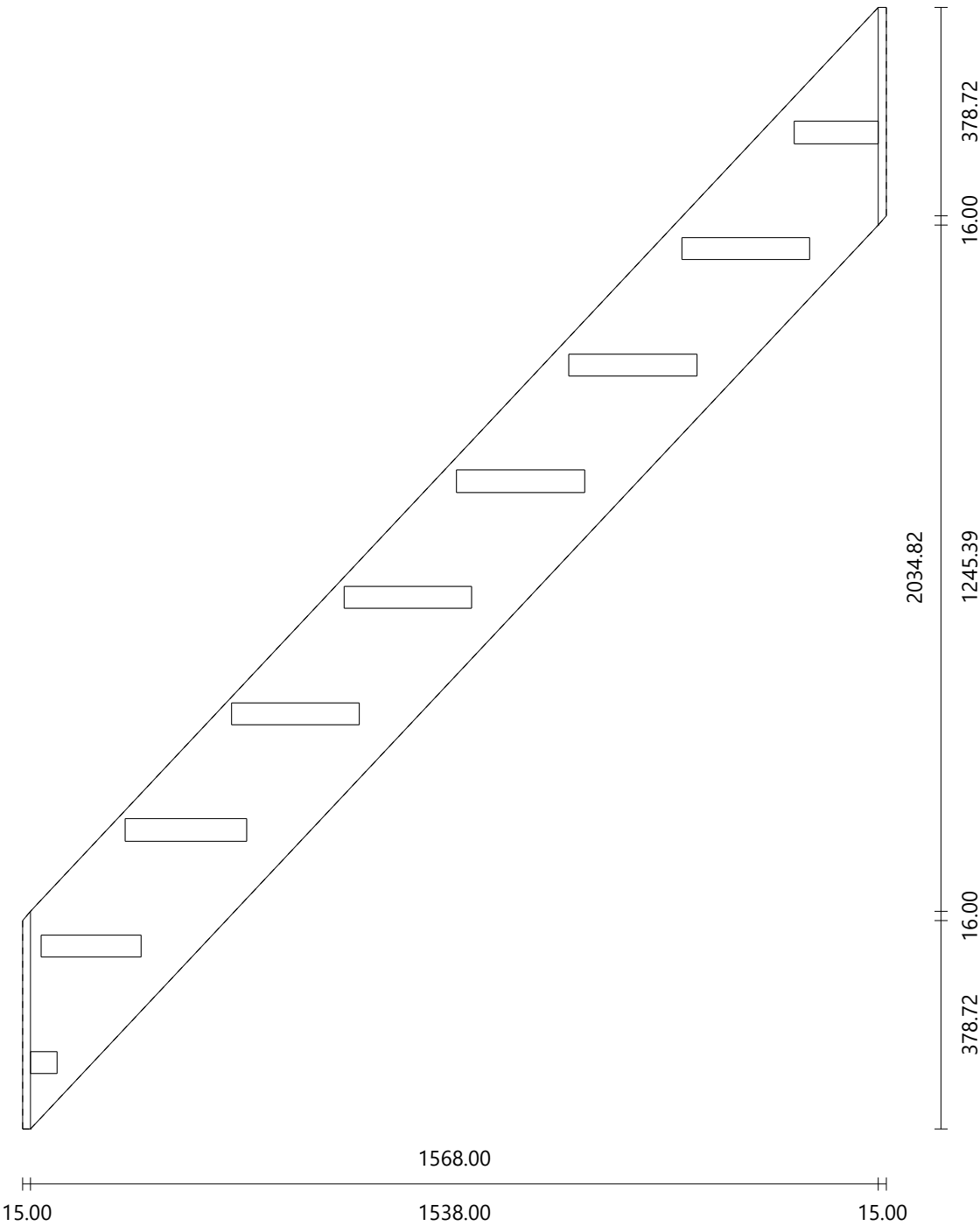

Material      Z\_wall\_white  
 Dimensions    896.89 × 283.45 mm  
 Thickness     40.00 mm

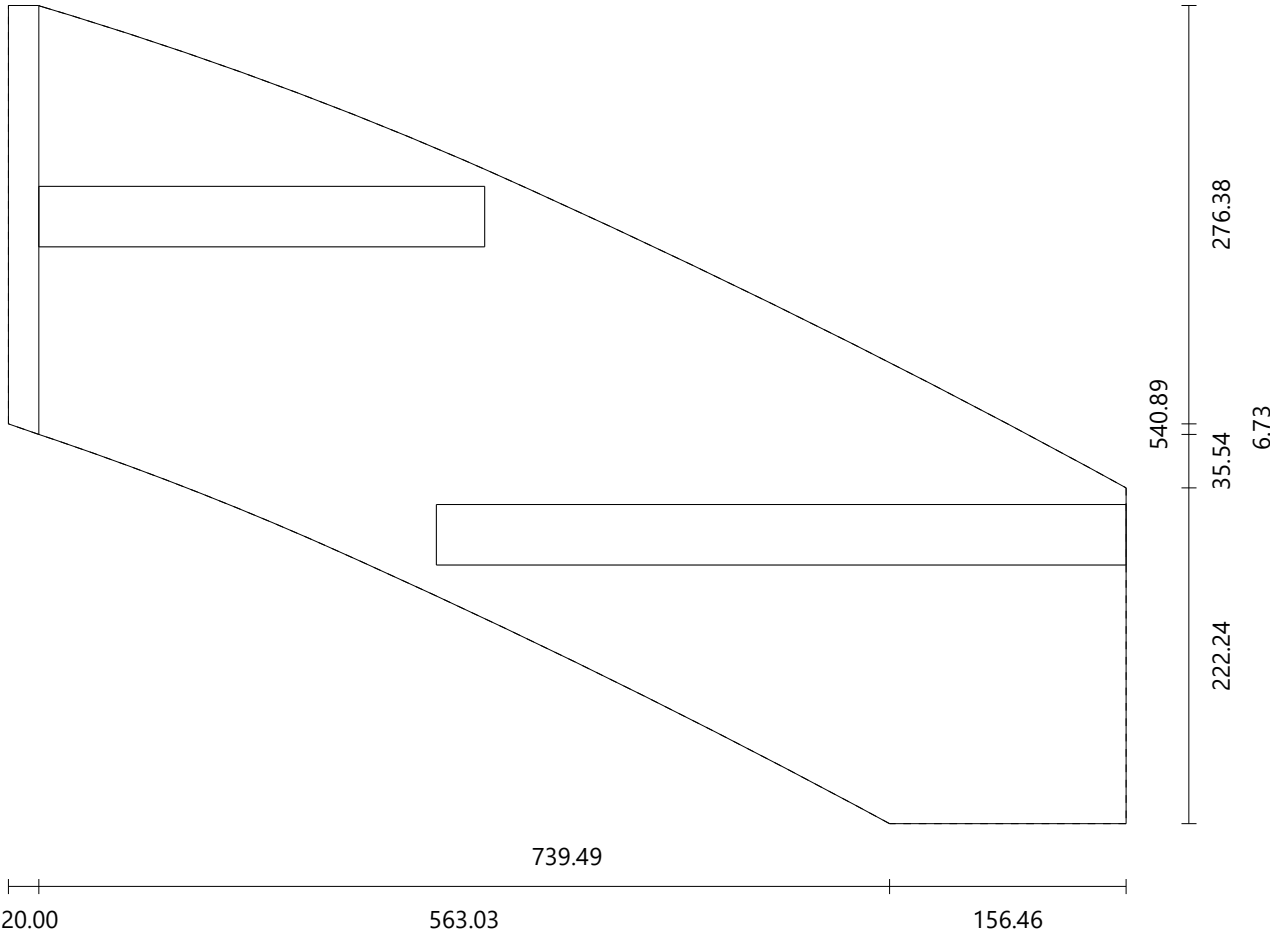

Material      Z\_wall\_white  
Dimensions    3261.68 × 461.07 mm  
Thickness     40.00 mm

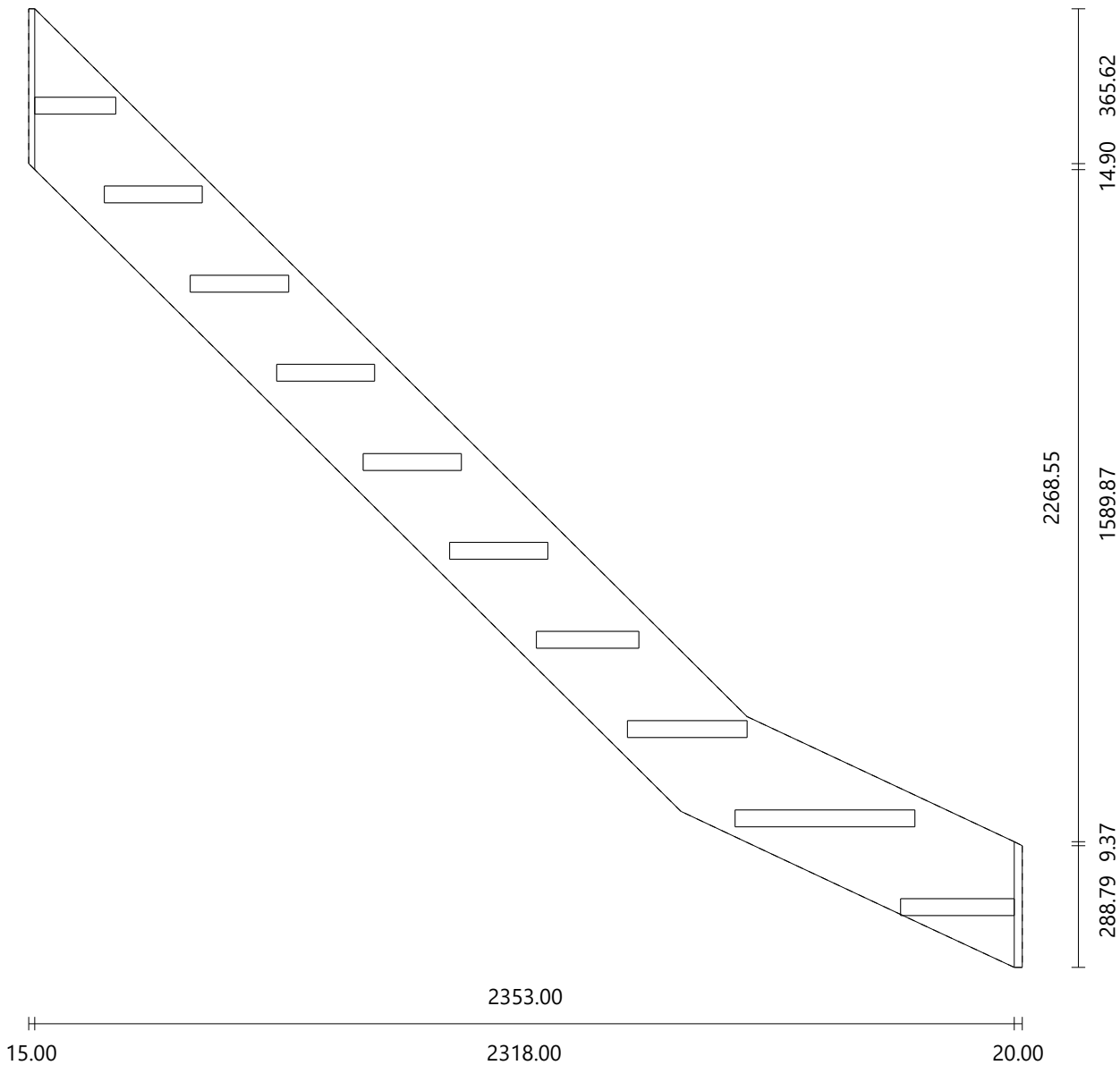

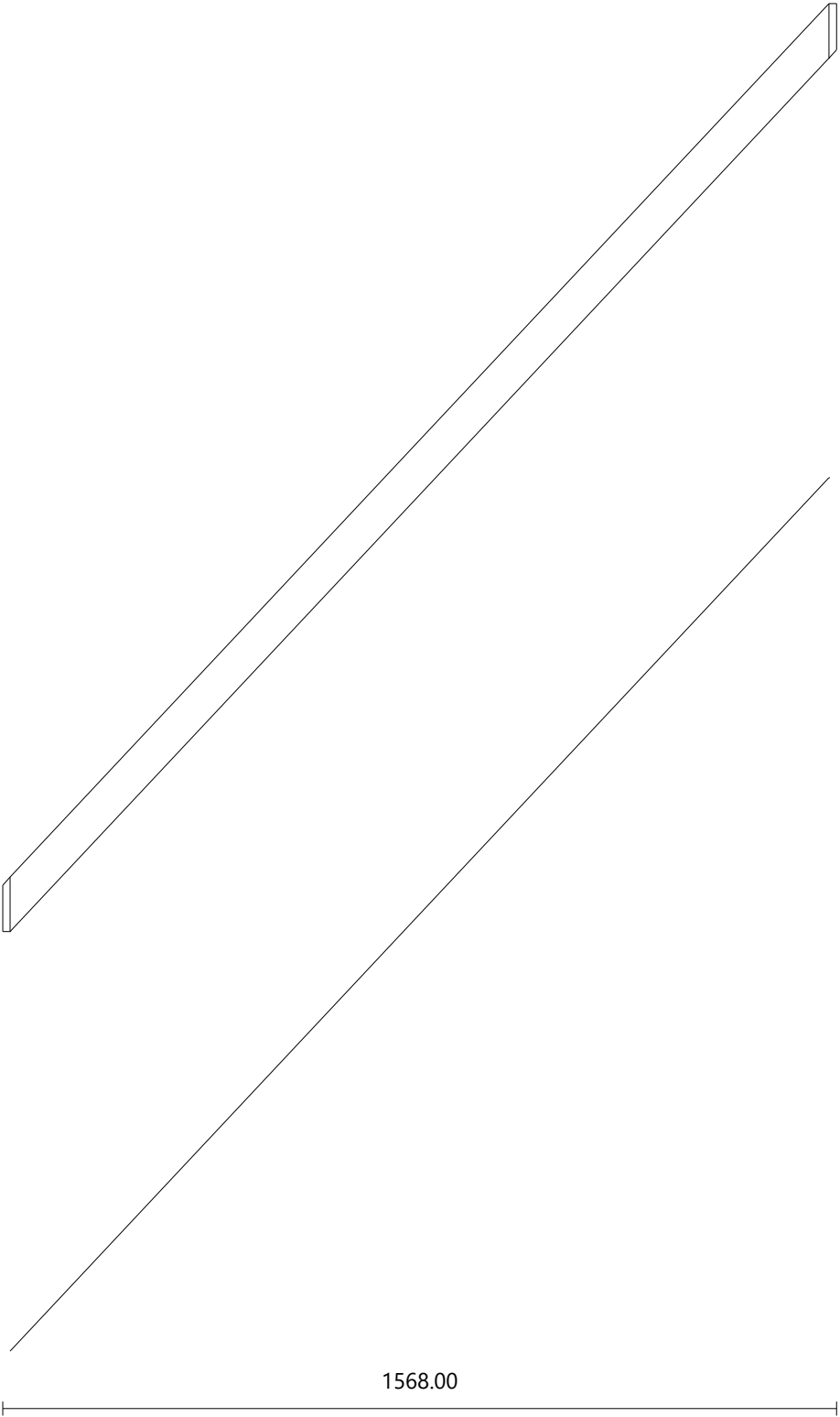

Material      Z\_wall\_white  
 Dimensions   2343.59 × 70.00 mm  
 Thickness     40.00 mm

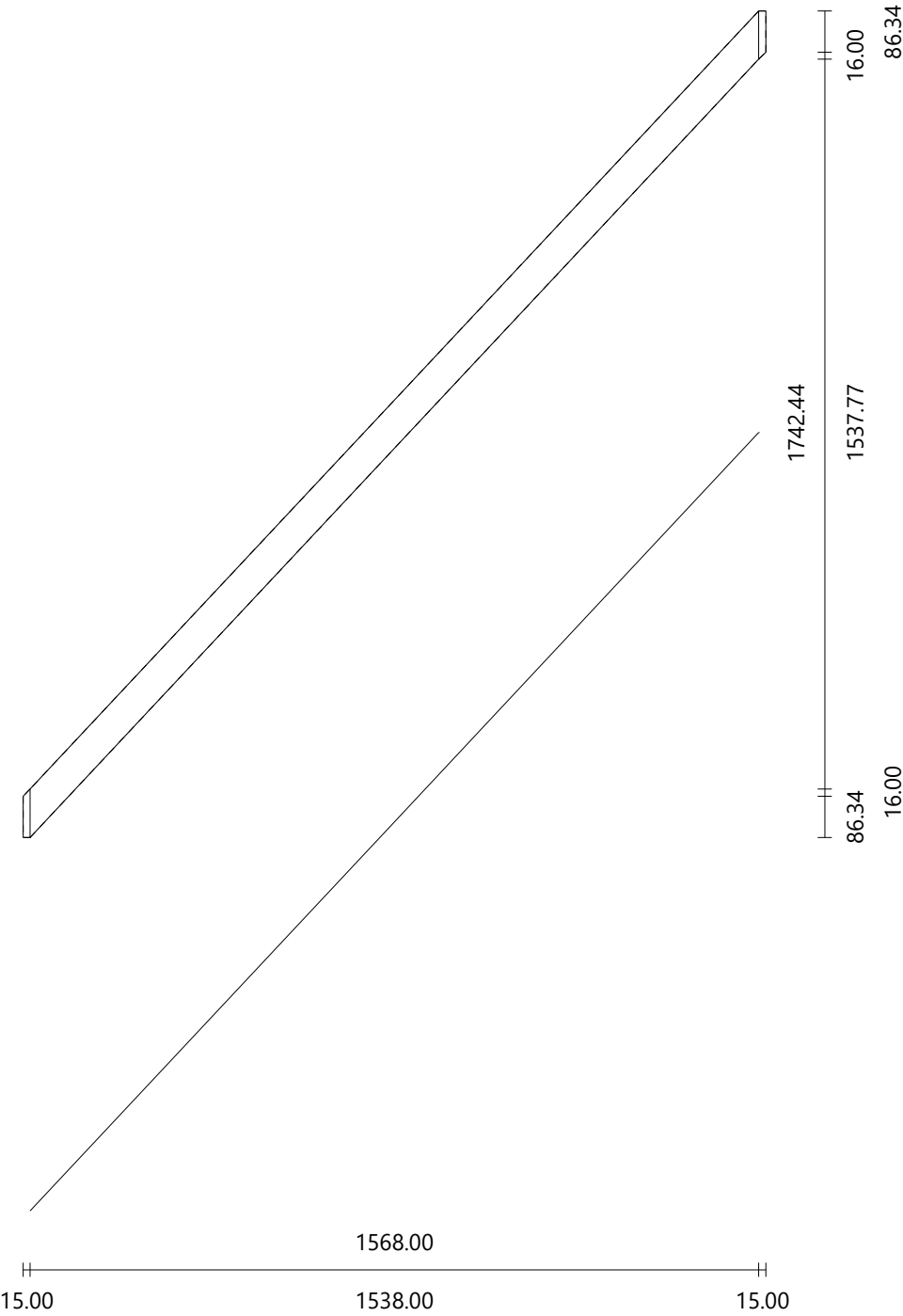

End Newel Post	Left Side	Flights: 1-2	Top View
Material	Z_wall_white		
Dimensions	80.00 × 80.00 mm		
Height	1801.08 mm		
Step #1	Height: 210.83 mm		
Step #2	Height: 421.67 mm		
Step #3	Height: 632.50 mm		
Face 2	Left Stringboard #1 Left Handrail #1		

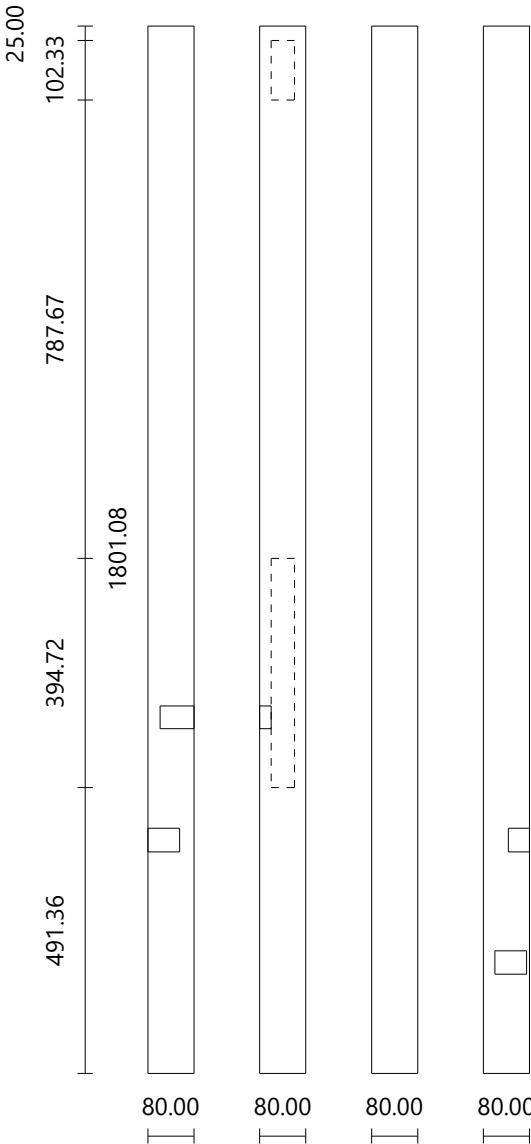
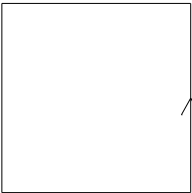



End Newel Post      Left Side      Flight: 2      Top View

Material      Z\_wall\_white  
Dimensions      80.00 × 60.00 mm  
Height      1319.72 mm

Step #11      Height: 192.70 mm  
Step #12      Height: 403.53 mm

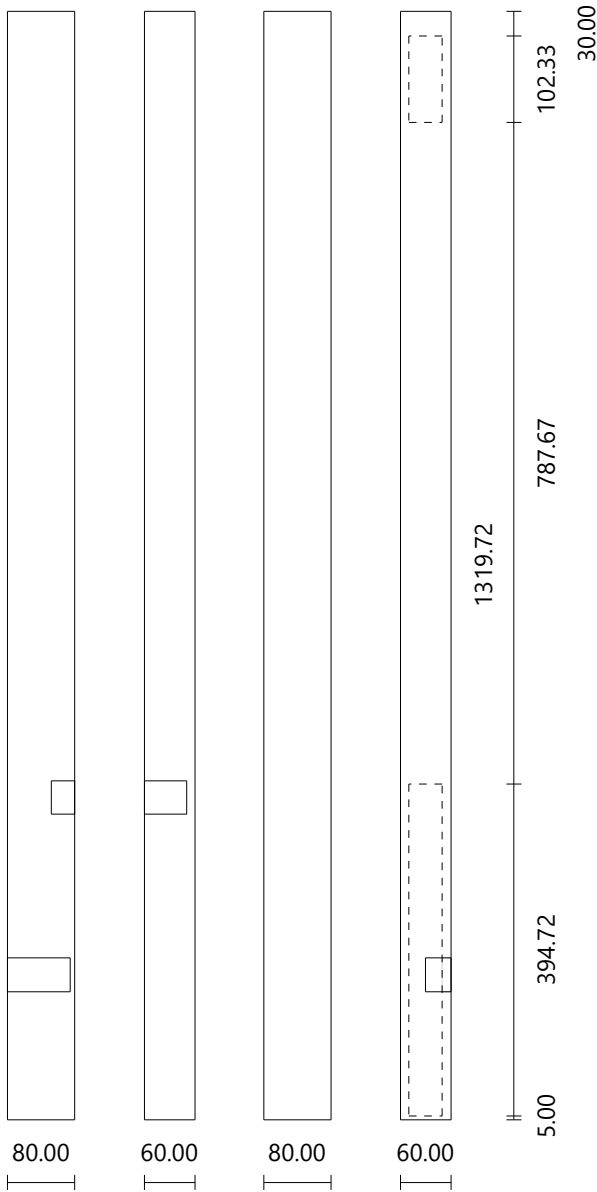
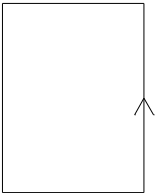
Face 4      Left Stringboard #1  
Left Handrail #1



End Newel Post	Right Side	Flight: 2	Top View
Material	Default		
Dimensions	40.00 × 80.00 mm		
Height	387.89 mm		
Step #11	Height: 177.06 mm		
Step #12	Height: 387.89 mm		
Face 4	Right Stringboard #2		

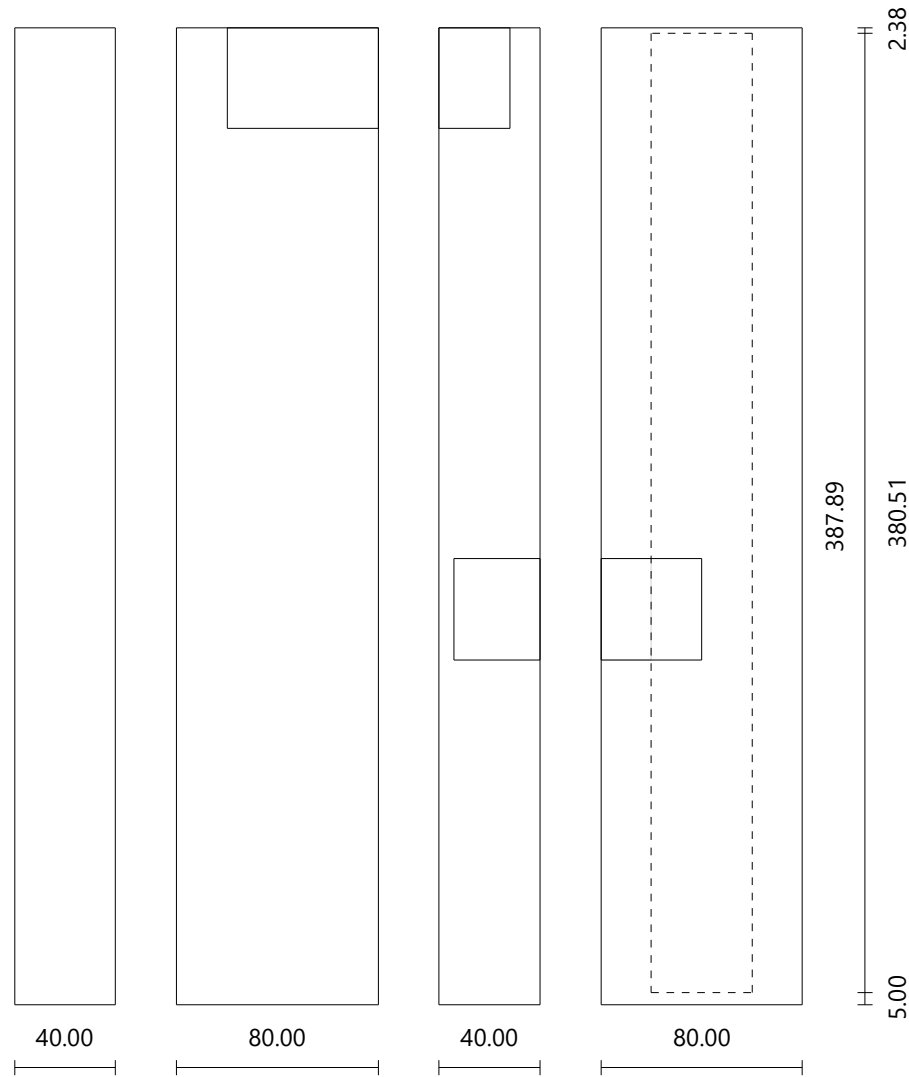

Corner Newel Post	Right Side	Flights: 1-2	Top View
Material	Default		
Dimensions	80.00 × 80.00 mm		
Height	607.23 mm		
Step #2	Height: 421.67 mm		
Face 3	Right Stringboard #2		
Face 4	Right Stringboard #1		

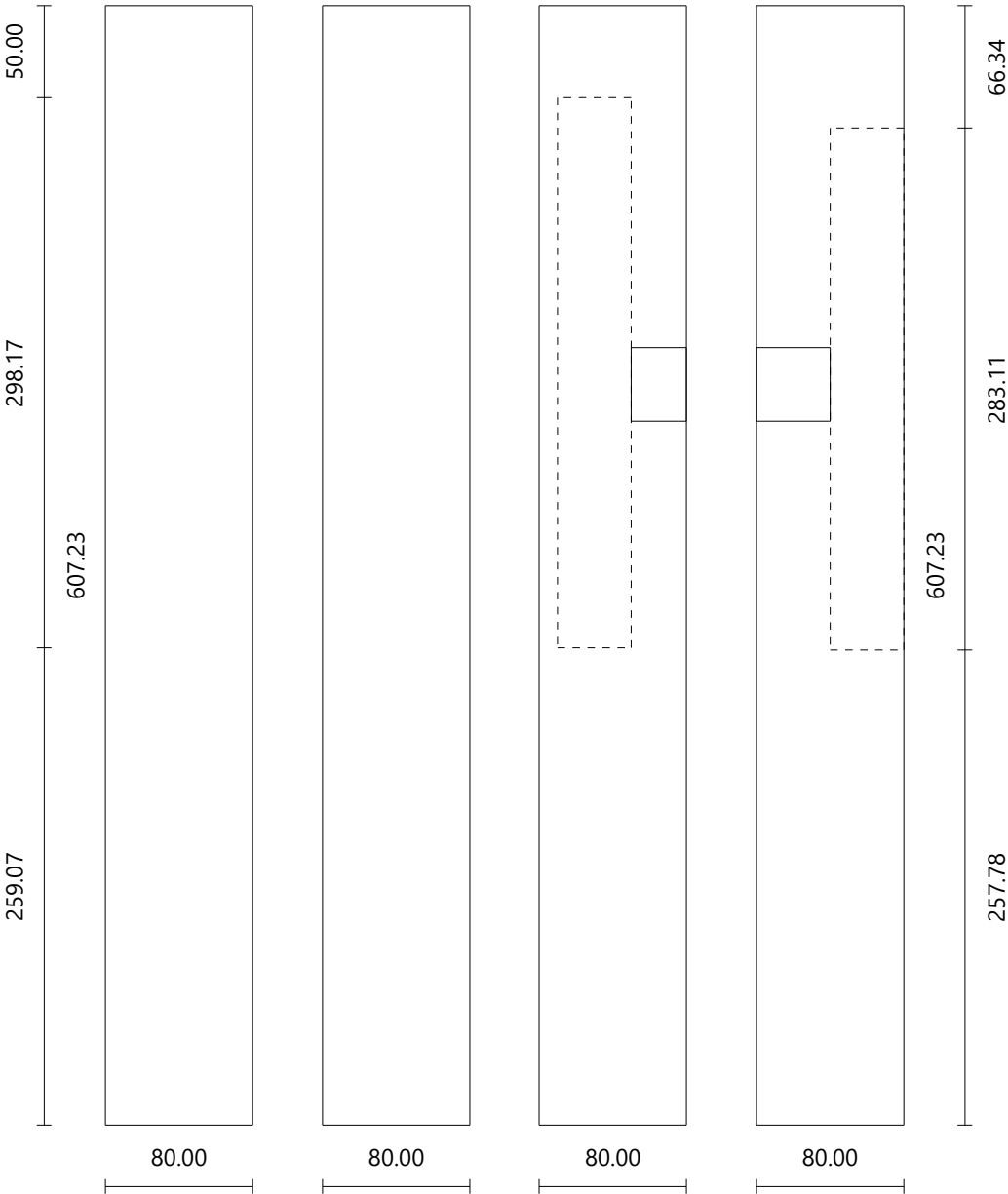
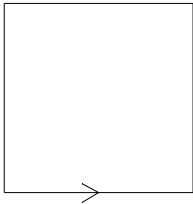

Part	Material	Dimensions	Cutting List Volume	Real Volume
Step #1	Default	735.65 × 456.80 × 40.00	0.01 m <sup>3</sup>	0.01 m <sup>3</sup>
Step #2	Default	1001.53 × 445.40 × 40.00	0.02 m <sup>3</sup>	0.01 m <sup>3</sup>
Step #3	Default	921.68 × 363.50 × 40.00	0.01 m <sup>3</sup>	0.01 m <sup>3</sup>
Step #4	Default	783.02 × 281.95 × 40.00	0.01 m <sup>3</sup>	0.01 m <sup>3</sup>
Step #5	Default	748.05 × 244.29 × 40.00	0.01 m <sup>3</sup>	0.01 m <sup>3</sup>
Step #6	Default	740.45 × 233.03 × 40.00	0.01 m <sup>3</sup>	0.01 m <sup>3</sup>
Step #7	Default	740.01 × 232.34 × 40.00	0.01 m <sup>3</sup>	0.01 m <sup>3</sup>
Step #8	Default	740.00 × 232.33 × 40.00	0.01 m <sup>3</sup>	0.01 m <sup>3</sup>
Step #9	Default	730.00 × 232.33 × 40.00	0.01 m <sup>3</sup>	0.01 m <sup>3</sup>
Step #10	Default	740.00 × 232.33 × 40.00	0.01 m <sup>3</sup>	0.01 m <sup>3</sup>
Step #11	Default	740.00 × 226.33 × 40.00	0.01 m <sup>3</sup>	0.01 m <sup>3</sup>
Step #12	Default	780.00 × 32.00 × 40.00	0.00 m <sup>3</sup>	0.00 m <sup>3</sup>
Left Stringboard #1	Z_wall_white	2556.87 × 270.00 × 40.00	0.03 m <sup>3</sup>	0.02 m <sup>3</sup>
Right Stringboard #1	Z_wall_white	896.89 × 283.45 × 40.00	0.01 m <sup>3</sup>	0.01 m <sup>3</sup>
Right Stringboard #2	Z_wall_white	3261.68 × 461.07 × 40.00	0.06 m <sup>3</sup>	0.03 m <sup>3</sup>
Left Handrail #1	Z_wall_white	2343.59 × 70.00 × 40.00	0.01 m <sup>3</sup>	0.01 m <sup>3</sup>
Newel Post #1	Z_wall_white	80.00 × 80.00 × 1801.08	0.01 m <sup>3</sup>	0.01 m <sup>3</sup>
Newel Post #2	Z_wall_white	80.00 × 60.00 × 1319.72	0.01 m <sup>3</sup>	0.01 m <sup>3</sup>
Newel Post #3	Default	40.00 × 80.00 × 387.89	0.00 m <sup>3</sup>	0.00 m <sup>3</sup>
Newel Post #4	Default	80.00 × 80.00 × 607.23	0.00 m <sup>3</sup>	0.00 m <sup>3</sup>

Material	Cutting List Volume	Real Volume	Weight	Price
<b>Steps</b>				
Default	0.10 m <sup>3</sup>	0.08 m <sup>3</sup>		
<b>Stringboards</b>				
Z_wall_white	0.10 m <sup>3</sup>	0.07 m <sup>3</sup>		
<b>Handrails</b>				
Z_wall_white	0.01 m <sup>3</sup>	0.01 m <sup>3</sup>		
<b>Newel Posts</b>				
Default	0.01 m <sup>3</sup>	0.01 m <sup>3</sup>		
Z_wall_white	0.02 m <sup>3</sup>	0.02 m <sup>3</sup>		
<b>Total</b>	<b>0.24 m<sup>3</sup></b>	<b>0.19 m<sup>3</sup></b>		